

ASHDOWN LODGE



THIS IMAGE HAS BEEN VIRTUALLY STYLED





Ashdown Lodge, W11

A spacious two bedroom flat in the heart of Notting Hill. This top floor flat (with lift) is flooded with natural light and has a semi-open-plan kitchen, reception room with wooden flooring, two double bedrooms and a bathroom. The property further benefits from an allocated private off-street parking space. Ashdown Lodge is located moments from the fabulous boutiques, restaurants and amenities on Westbourne Grove, Notting Hill Gate underground station (Central, Circle & District lines) is also within walking distance.

THIS IMAGE HAS BEEN VIRTUALLY STYLED



Approx. Gross Internal Area
= 78.6 sq m / 846 sq ft

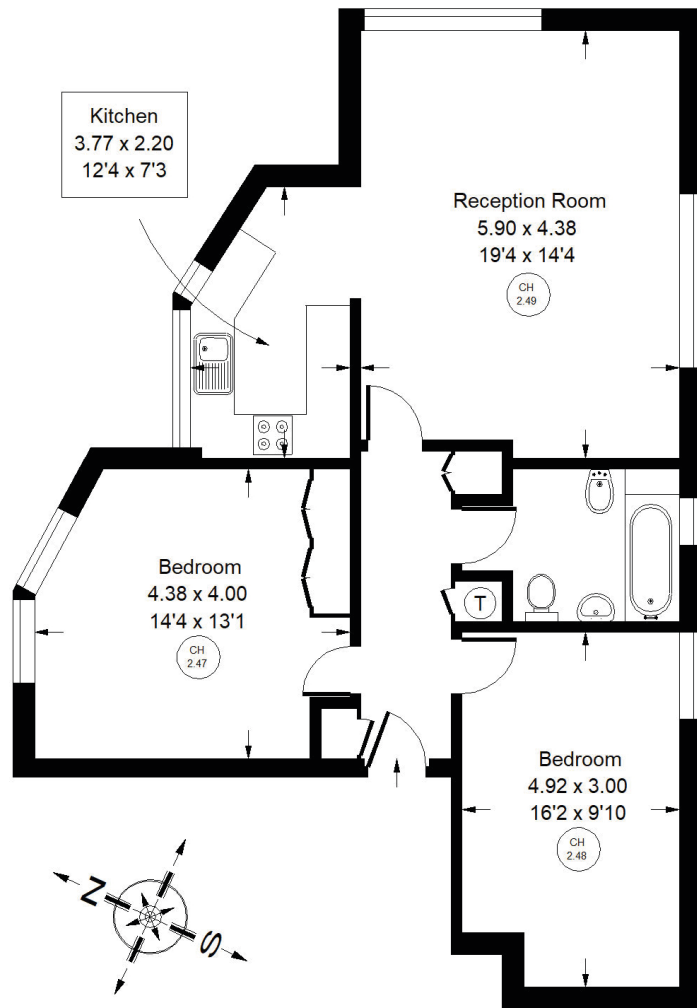

Third Floor



Ashdown Lodge, W11

- Top floor flat (with lift)
- Two double bedrooms
- Good transport links
- Off-street parking
- Flooded with natural light
- Council Tax Band: F