



Connells

Kettleworks Pope Street  
Birmingham



### Property Description

MODERN APARTMENT WITH CONCIERGE AND GYM! - A spacious and well presented two bedroom apartment situated in the City Centre, comprising of open plan lounge with fitted kitchen, bathroom, two bedrooms, hallway. The property has fantastic transport links close by,

### Location & Information

The property benefits from unlimited access to the communal gym & has a 24-hour concierge. The Kettleworks is located in the Jewellery Quarter and is in close proximity to Paradise Circus, Colmore Row, Broad Street and main transport links through Birmingham City Centre.

### Hallway

### Open Plan Lounge / Kitchen

25' 4" x 14' 8" ( 7.72m x 4.47m )

### Bedroom 1

20' 11" x 9' 2" ( 6.38m x 2.79m )

### Bedroom 2

16' 2" x 10' ( 4.93m x 3.05m )

### Bathroom



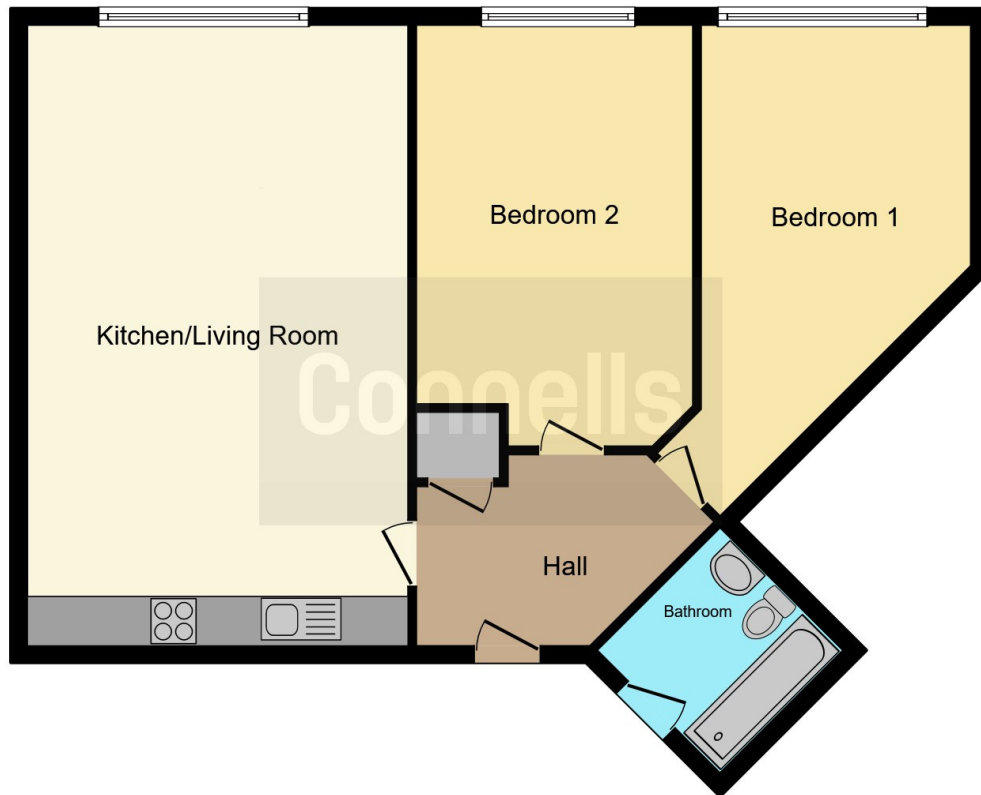

This floorplan is for illustrative purposes only and is not drawn to scale. Measurements, floor-areas, openings and orientations are approximate. They should not be relied upon for any purpose and do not form any part of an agreement. No liability is taken for any error or mis-statement. All parties must rely on their own inspections.

To view this property please contact Connells on

**T 0121 212 0800**  
**E [birminghamcity@connells.co.uk](mailto:birminghamcity@connells.co.uk)**

145 Great Charles Street Queensway  
 BIRMINGHAM B3 3LP

**EPC Rating: D**

**view this property online [connells.co.uk/Property/DIG110675](https://www.connells.co.uk/Property/DIG110675)**

This is a Leasehold property. We are awaiting further details about the Term of the lease. For further information please contact the branch. Please note additional fees could be incurred for items such as Leasehold packs.



Tenure: Leasehold



1. MONEY LAUNDERING REGULATIONS Intending purchasers will be asked to produce identification documentation at a later stage and we would ask for your co-operation in order that there will be no delay in agreeing the sale. 2. These particulars do not constitute part or all of an offer or contract. 3. The measurements indicated are supplied for guidance only and as such must be considered incorrect. Potential buyers are advised to recheck measurements before committing to any expense. 4. We have not tested any apparatus, equipment, fixtures, fittings or services and it is in the buyers interest to check the working condition of any appliances.

Connells Residential is registered in England and Wales under company number 1489613, Registered Office is Cumbria House, 16-20 Hockliffe Street, Leighton Buzzard, Bedfordshire, LU7 1GN. VAT Registration Number is 500 2481 05.

**See all our properties at [www.connells.co.uk](http://www.connells.co.uk) | [www.rightmove.co.uk](http://www.rightmove.co.uk) | [www.zoopla.co.uk](http://www.zoopla.co.uk)**

Property Ref: DIG110675 - 0004