

25 Brickfield View

Rochester, ME2 4JZ

Greenleaf Property Services are delighted pleased to offer for rent this first floor, two bedroom maisonette located in a cul de sac in Frindsbury, close to the Medway Tunnel. Property comprises entrance door with staircase up to the lounge/diner, separate kitchen, two bedrooms and bathroom. Electric heating. Also benefits from double glazing, one allocated parking space and communal gardens.

In order to reserve a property you will be required to pay a holding deposit equivalent to one weeks rent. This will be refunded once checks are complete unless false or misleading information is provided, a Right to Rent check fails or you withdraw from the property. It can, with agreement be put towards the first months rent due along with the five week deposit. If you require any further information just give the team a call or email on info@greenleaf-property.co.uk.

Greenleaf are a member of the PRS (property redress scheme) membership number:PRS003992
Greenleaf Property Services Ltd have client money protection – property mark - membership – C0128543

£1,150 Per Month

25 Brickfield View

Rochester, ME2 4JZ



- FIRST FLOOR MAISONETTE
- ELECTRIC HEATING
- COUNCIL TAX BAND C
- TWO BEDROOMS
- 5 WEEK DEPOSIT £1326.92 (RENTX12/52)
- AVAILABLE MID SEPTEMBER
- ALLOCATED PARKING SPACE
- 1 WEEK HOLDING DEPOSIT £265.38



[Directions](#)

Tel: 01634730672





GROUND FLOOR

1ST FLOOR

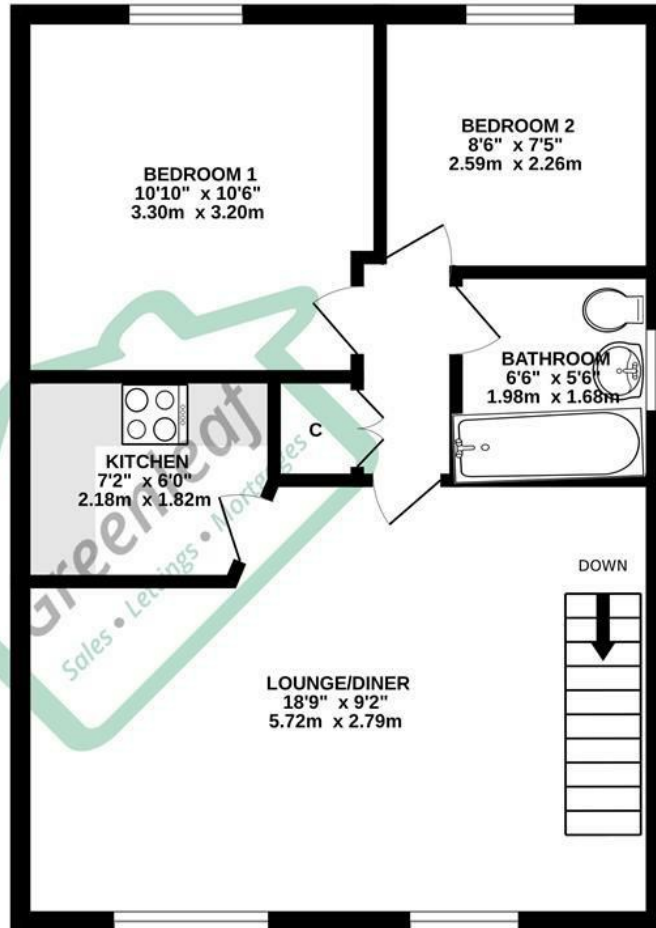
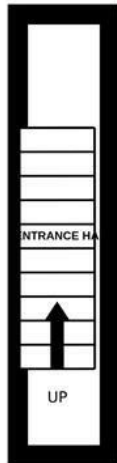

Whilst every attempt has been made to ensure the accuracy of the floorplan contained here, measurements of doors, windows, rooms and any other items are approximate and no responsibility is taken for any error, omission or mis-statement. This plan is for illustrative purposes only and should be used as such by any prospective purchaser. The services, systems and appliances shown have not been tested and no guarantee as to their operability or efficiency can be given.
Made with Metropix ©2023

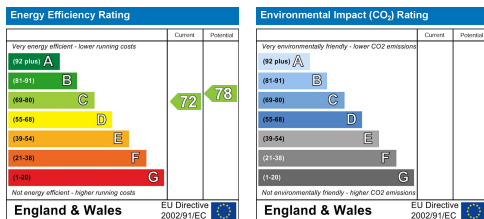

Greenleaf Property Services is a trading name of Greenleaf Property Services Limited.
Registered Office: 281 Wilson Avenue, Rochester Kent ME1 2SS
Registered No: 06222461 England. VAT No: 908929091

These particulars, whilst believed to be accurate are set out as a general outline only for guidance and do not constitute any part of an offer or contract. Intending purchasers should not rely on them as statements of representation of fact, but must satisfy themselves by inspection or otherwise as to their accuracy. No person in this firm's employment has the authority to make or give any representation or warranty in respect of the property.