

3 Marina Point West, Dock Head Road Chatham, ME4 4ZE

Greenleaf are delighted to offer for rent this contemporary one bedroom Apartment, situated in the West Tower on the Chatham Maritime Marina, overlooking the River Medway. This modern apartment comprises of entrance hallway with utility cupboard, open plan kitchen/living room, double bedroom and bathroom. The Dockside complex has a vast array of activities including shopping, a cinema, gym, restaurants and bars, and the property also includes secure underground car parking for one car with direct lift access. Available early July.

In order to reserve a property you will be required to pay a holding deposit equivalent to one weeks rent. This will be refunded once checks are complete unless false or misleading information is provided, a Right to Rent check fails or you withdraw from the property. It can, with agreement be put towards the first months rent due along with the five week deposit. If you require any further information just give the team a call or email on info@greenleaf-property.co.uk.

Greenleaf are a member of the PRS (property redress scheme) membership number: PRS003992
Greenleaf Property Services Ltd have client money protection – property mark - membership – C0128543

£1,100 Per Month

3 Marina Point West, Dock Head Road

Chatham, ME4 4ZE



- FANTASTIC APARTMENT OVERLOOKING CHATHAM MARINA
- SITUATED WITHIN A STONES THROW OF RESTAURANTS,BARS SHOPS
- AVAILABLE END JUNE
- 5 WEEK DEPOSIT £1269.23
- POPULAR DEVELOPMENT
- WALKING DISTANCE TO HISTORIC DOCKYARD MUSEUM
- COUNCIL TAX BAND D
- UNDERCROFT ALLOCATED PARKING WITH PERMIT
- CLOSE TO LINKS FOR PUBLIC TRANSPORT AND MOTORWAYS
- HOLDING DEPOSIT £253.84



Directions

Tel: 01634730672

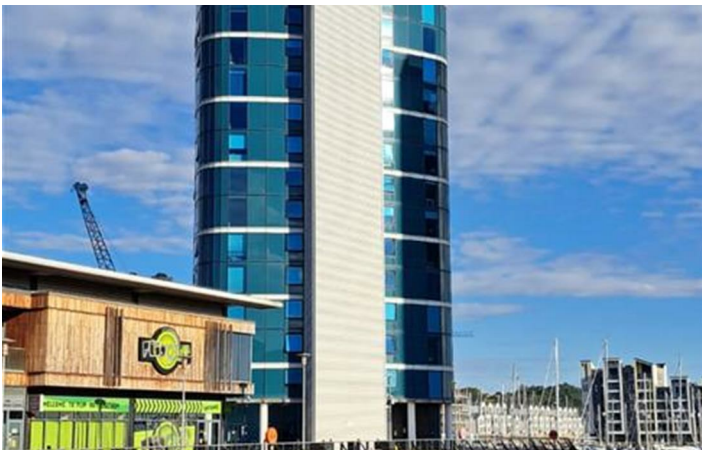
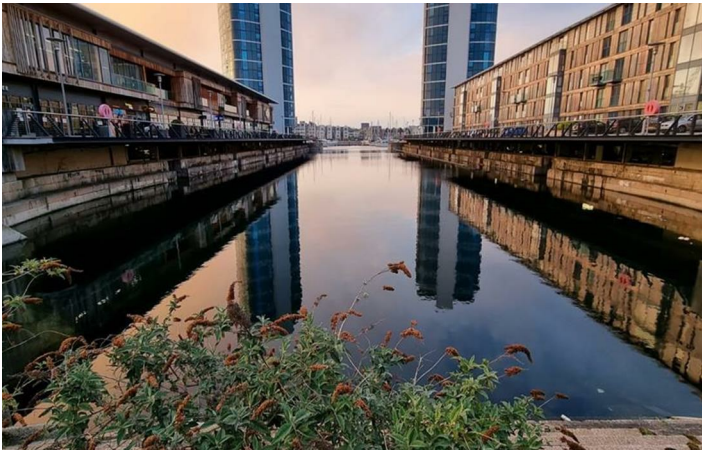



GROUND FLOOR
401 sq.ft. (37.3 sq.m.) approx.

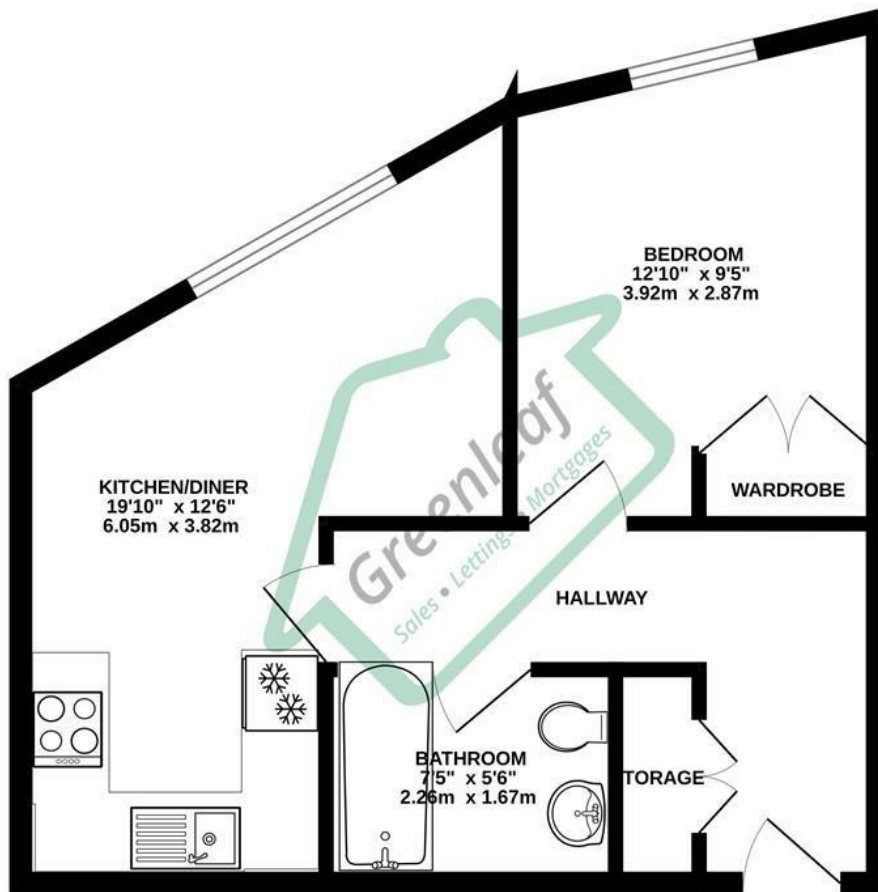

TOTAL FLOOR AREA : 401 sq.ft. (37.3 sq.m.) approx.

Whilst every attempt has been made to ensure the accuracy of the floorplan contained here, measurements of doors, windows, rooms and any other items are approximate and no responsibility is taken for any error, omission or mis-statement. This plan is for illustrative purposes only and should be used as such by any prospective purchaser. The services, systems and appliances shown have not been tested and no guarantee as to their operability or efficiency can be given.
Made with Metropix ©2023

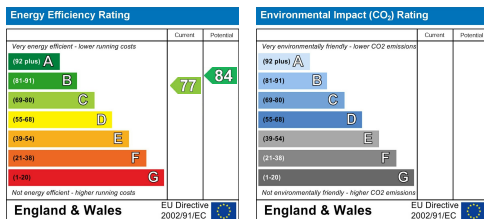

Greenleaf Property Services is a trading name of Greenleaf Property Services Limited.
Registered Office: 281 Wilson Avenue, Rochester Kent ME1 2SS
Registered No: 06222461 England. VAT No: 908929091

These particulars, whilst believed to be accurate are set out as a general outline only for guidance and do not constitute any part of an offer or contract. Intending purchasers should not rely on them as statements of representation of fact, but must satisfy themselves by inspection or otherwise as to their accuracy. No person in this firm's employment has the authority to make or give any representation or warranty in respect of the property.