

1 Marc Brunel Way Chatham, ME4 4BH

Greenleaf are delighted to offer this just redecorated, immaculate Town House in the sought after Historic Dockyard in Chatham. Arranged over three floors, with a single Garage and off road parking this beautiful property also offers: an entrance hall, with cloakroom, access internally to Garage, bedroom/office and utility room. Access to an easy to maintain rear garden. To the first floor is the kitchen/diner with double doors to balcony offering views over the rear garden. Lounge with double doors to a front balcony with views over the Dockyard. To the second floor are two double bedrooms and a single. Master bedroom with en-suite. The family bathroom includes a bath and overhead shower. The Historic Dockyard is a 80 acre 24 hour secure site. Residents have free access to green spaces, riverside walks, museums and eateries. Also within close proximity to Shopping centre, complex with cinema, restaurants and bars. New vinyl being fitted to bathrooms. Available now, call to register and arrange a viewing.

In order to reserve a property you will be required to pay a holding deposit equivalent to one weeks rent. This will be refunded once checks are complete unless false or misleading information is provided, a Right to Rent check fails or you withdraw from the property. It can, with agreement be put towards the first months rent due along with the five week deposit. If you require any further information just give the team a call or email on info@greenleaf-property.co.uk.

Greenleaf are a member of the PRS (property redress scheme) membership number: PRS003992
Greenleaf Property Services Ltd have client money protection – property mark - membership – C0128543

£1,850 Per Month

1 Marc Brunel Way

Chatham, ME4 4BH



- 3/4 BEDROOM TOWNHOUSE
- JUST REDECORATED THROUGHOUT
- AVAILABLE NOW
- 5 WEEK DEPOSIT £2134.61
- SECURE SOUGHT AFTER COMPLEX
- IMMACULATELY PRESENTED
- COUNCIL TAX BAND E
- VIEWS OVER DOCKYARD
- GARAGE AND OFF ROAD PARKING
- 1 WEEK HOLDING DEPOSIT £426.92



[Directions](#)

Tel: 01634730672



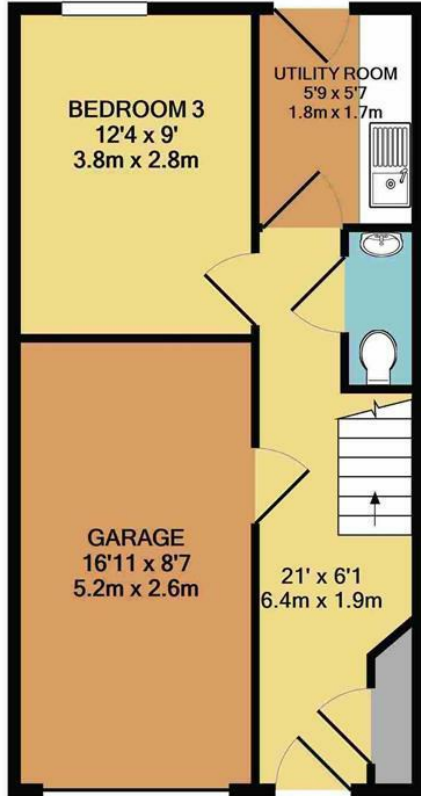

GROUND FLOOR
APPROX. FLOOR
AREA 442 SQ.FT.
(41.1 SQ.M.)

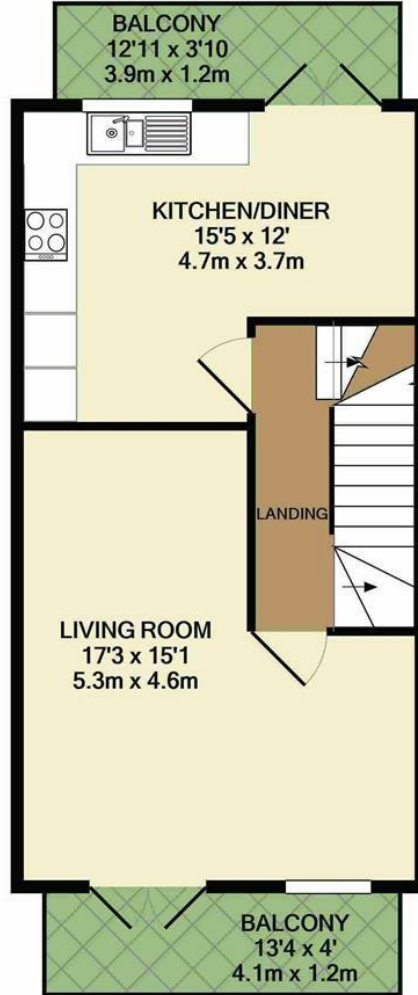

1ST FLOOR
APPROX. FLOOR
AREA 442 SQ.FT.
(41.1 SQ.M.)

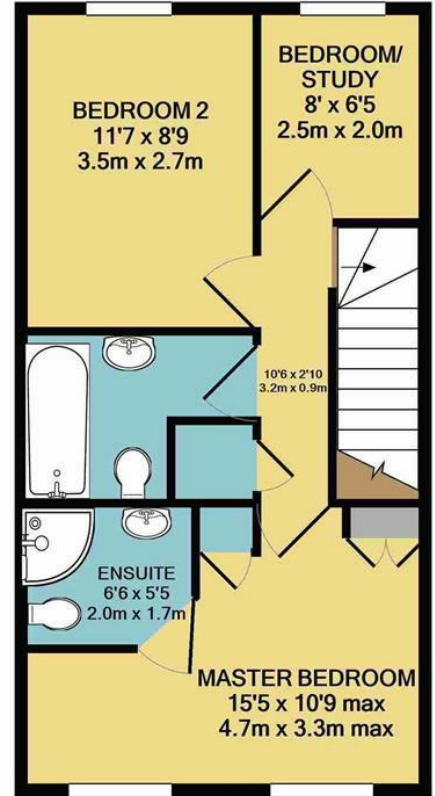

2ND FLOOR
APPROX. FLOOR
AREA 442 SQ.FT.
(41.1 SQ.M.)

NOT TO SCALE
TOTAL APPROX. FLOOR AREA 1326 SQ.FT. (123.2 SQ.M.)

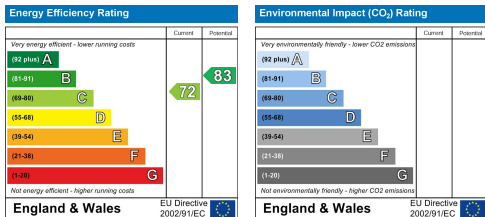

Greenleaf Property Services is a trading name of Greenleaf Property Services Limited.
Registered Office: 281 Wilson Avenue, Rochester Kent ME1 2SS
Registered No: 06222461 England. VAT No: 908929091

These particulars, whilst believed to be accurate are set out as a general outline only for guidance and do not constitute any part of an offer or contract. Intending purchasers should not rely on them as statements of representation of fact, but must satisfy themselves by inspection or otherwise as to their accuracy. No person in this firm's employment has the authority to make or give any representation or warranty in respect of the property.