



24 Brickfield View Rochester, Kent, ME2 4JZ

Greenleaf are pleased to offer for rent this ground floor two bedroom Maisonette located in a cul-de-sac, in Frindsbury. Conveniently located for Medway Tunnel, Medway Hospital, shops, transport links and schools. Property comprises of entrance porch, Lounge/diner, kitchen with oven and hob, two double bedrooms and bathroom. Allocated parking, communal garden and available now!

In order to reserve a property you will be required to pay a holding deposit equivalent to one weeks rent. This will be refunded once checks are complete unless false or misleading information is provided, a Right to Rent check fails or you withdraw from the property. It can, with agreement be put towards the first months rent due along with the five week deposit. If you require any further information just give the team a call or email on info@greenleaf-property.co.uk.

Greenleaf are a member of the PRS (property redress scheme) membership number: PRS003992
Greenleaf Property Services Ltd have client money protection – property mark - membership – C0128543

£1,150 PCM

24 Brickfield View

Rochester, Kent, ME2 4JZ



- GROUND FLOOR
- AVAILABLE NOW
- 5 WEEK DEPOSIT £1326.92
- TWO DOUBLE BEDROOMS
- GREAT LOCATION
- COUNCIL TAX BAND C
- ALLOCATED PARKING
- HOLDING FEE £265.38 - 1 WEEKS RENT



[Directions](#)

Tel: 01634730672



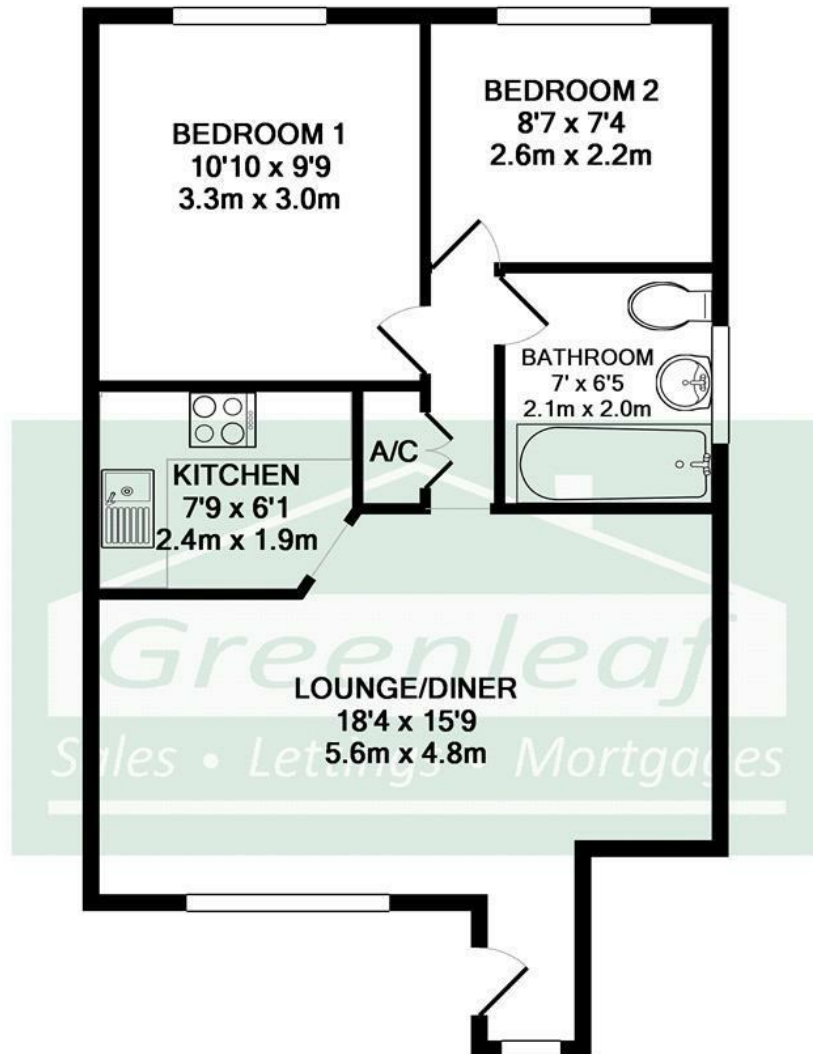

TOTAL APPROX. FLOOR AREA 481 SQ.FT. (44.7 SQ.M.)

Whilst every attempt has been made to ensure the accuracy of the floor plan contained here, measurements of doors, windows, rooms and any other items are approximate and no responsibility is taken for any error, omission, or mis-statement. This plan is for illustrative purposes only and should be used as such by any prospective purchaser. The services, systems and appliances shown have not been tested and no guarantee as to their operability or efficiency can be given

Made with Metropix ©2010

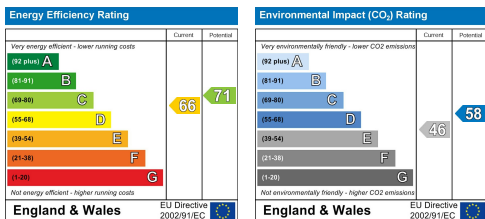

Greenleaf Property Services is a trading name of Greenleaf Property Services Limited.
 Registered Office: 281 Wilson Avenue, Rochester Kent ME1 2SS
 Registered No: 06222461 England. VAT No: 908929091

These particulars, whilst believed to be accurate are set out as a general outline only for guidance and do not constitute any part of an offer or contract. Intending purchasers should not rely on them as statements of representation of fact, but must satisfy themselves by inspection or otherwise as to their accuracy. No person in this firm's employment has the authority to make or give any representation or warranty in respect of the property.