



**Hayward  
Tod**

**2 bedroom Semi Detached Bungalow | Greenside | Walton | Brampton | CA8 2DJ**  
**Guide Price £205,000**







Ripe for renovation this two bed semi detached bungalow is beautifully placed overlooking the green in the centre of the village. The accommodation is well laid out and the property benefits from a pleasant aspect at the front and north west facing rear garden. Of interest is the double garage which has access from the rear lane. Requiring modernisation however we are sure investment will reward.

#### ACCOMMODATION SUMMARY

Hall | Living room | Kitchen | Rear double bedroom one | Front bedroom two | Bathroom | Forecourt garden | Rear lawned garden | Detached double garage | Mains water and drainage | Electric heating | Council Tax Band - C | EPC rating - F | Freehold

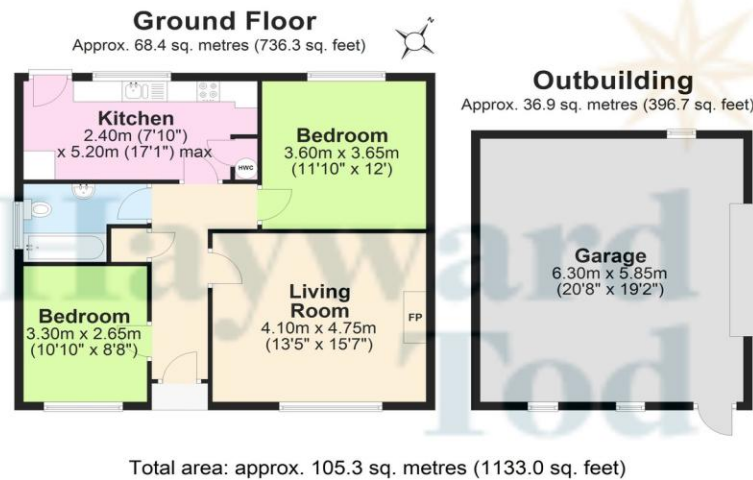

#### APPROXIMATE MILEAGES

Brampton 3.2 | M6 J43 9 | Hadrian's Wall UNESCO World Heritage Site - Birdoswald Fort 7.7 | Central Carlisle West Coast Mainline Station 10.9 | North Pennines AONB - Alston 23 | Lake District National Park - Caldbeck 23.5, Pooley Bridge Ullswater 32.4 | Solway Coast AONB - Bowness on Solway 23.7 | Newcastle Airport 49.7

#### WHY WALTON?

Pretty village adjacent to the course of Hadrian's Wall and close to Cycle Route 72, with village hall tea room and church. St Mary's church was built in 1869 on the site of a medieval church. Of interest in the village is the Old Vicarage Micro Brewery. The nearby market town of Brampton is just a 7 minute drive and provides an excellent variety of good amenities including cafes, shops, schools, Cranstons food hall and doctors surgery. There is convenient access for the main road network, M6, A69 and A689 providing links for Hadrian's Wall, Newcastle, Carlisle, Lake District and The Borders along with our region's many areas of natural and historic interest.

#### Contact

6 Paternoster Row,  
Carlisle Cumbria CA3 8TT

01228 810 300  
info@haywardtdod.co.uk  
haywardtdod.co.uk

#### Agents note

Whilst every care has been taken to prepare these sales particulars, they are for guidance purposes only. All measurements are

approximate and are for general guidance purposes only and whilst every care has been taken to ensure their accuracy, they should not be relied upon and potential buyers are advised to recheck the measurements.