



Millennium Square

London, SE1

Asking Price £750,000

A spacious and stylish two-bedroom apartment in a secure gated development, perfectly situated in the heart of vibrant Shad Thames, offering serene courtyard views and private parking.

CHESTERTONS



Millennium Square

London, SE1

- Two spacious double bedrooms
- Open plan kitchen/lounge
- Private balcony with courtyard views
- Gated, allocated off-street parking
- 917 sqft / 85 sqm
- Prime Shad Thames location
- Near Tower Bridge landmarks
- Close to markets & eateries



Set within the prestigious Millennium Square, this exceptional apartment boasts a bright and open plan kitchen and living area, ideal for both relaxing and entertaining. The two generous double bedrooms provide ample space and comfort, while the private balcony overlooks a tranquil courtyard, creating a peaceful retreat in the heart of the city. Residents benefit from the convenience of private, allocated, gated parking—a rare and highly sought-after feature in this central location. The property spans approximately 917 square feet, combining contemporary design with practical living in one of London's most desirable riverside enclaves.

Located just moments from the iconic Tower Bridge, the apartment enjoys unparalleled access to the vibrant bars, restaurants and cafés of Shad Thames and One Tower Bridge. It is also within easy reach of Maltby Street Market, Bermondsey Street, Borough Market, St Katharine Docks, and London Bridge, offering a wealth of lifestyle amenities on your doorstep. This superb home offers the perfect blend of serene living with urban convenience, ideal for those seeking a distinctive London residence in a prestigious gated community.

Tenure: Leasehold 183 years 7 months

Service Charge: £3302.14 pa

Ground Rent: £0 Peppercorn

Local Authority: Southwark

Council Tax Band: F

Score	Energy rating	Current	Potential
92+	A		
81-91	B		
69-80	C	72 C	76 C
55-68	D		
39-54	E		
21-38	F		
1-20	G		

Chestertons Tower Bridge Sales

220 Tower Bridge Road

Tower Bridge

London

SE1 2UP

towerbridge@chestertons.co.uk

020 7357 7999

chestertons.co.uk

Millennium Square, SE1

○ - Ceiling Height

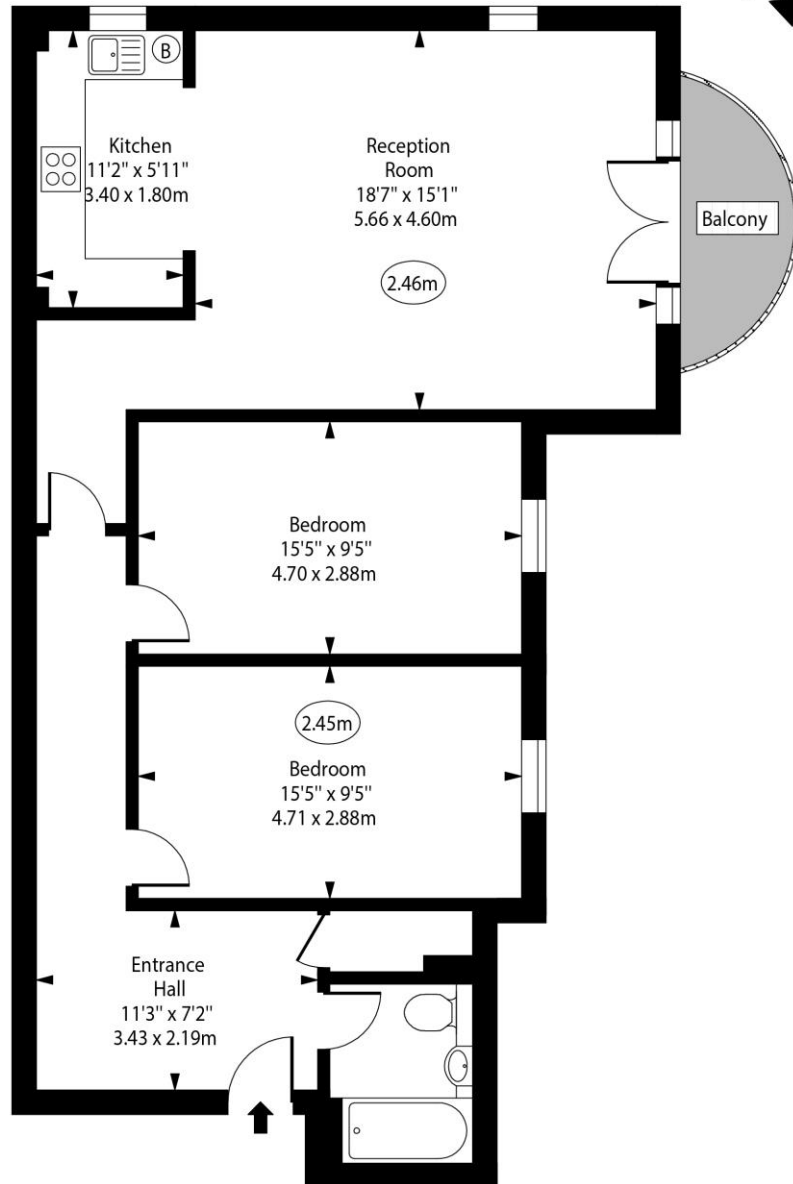

First Floor

Approx Gross Internal Area 917 Sq Ft - 85.19 Sq M

Every attempt has been made to ensure the accuracy of the floor plan shown. However, all measurements, fixtures, fittings, and data shown are approximate interpretations and for illustrative purposes only.

Measured according to the RICS IPMS 2. Not To Scale.

www.goldlens.co.uk

Ref. No. 028078J

