



Rodney Point

309 Rotherhithe Street, SE16

Guide Price £475,000

GUIDE PRICE £475,000 to £490,000

Welcome to this well-appointed two bedroom apartment in the desirable Rodney Point! This property offers a spacious living room, ideal for relaxing or entertaining, and a separate, modern kitchen equipped with ample storage.

CHESTERTONS



Rodney Point

309 Rotherhithe Street, SE16

- Two Bedrooms
- Two Bathrooms
- Separate kitchen
- Allocated underground parking
- Communal garden
- Good transport links



GUIDE PRICE £475,000 to £490,000

Welcome to this well-appointed two bedroom apartment in the desirable Rodney Point! This property offers a spacious living room, ideal for relaxing or entertaining, and a separate, modern kitchen equipped with ample storage. Both bedrooms are generously sized, and the two bathrooms are in excellent condition, adding convenience and comfort.

The apartment benefits from allocated parking and access to a beautifully maintained communal garden, providing a peaceful retreat. With the Thames Pathway just a short stroll away, you can enjoy scenic riverside walks whenever you please.

Commuting is a breeze, with easy access to transport links taking you quickly into the city and Canary Wharf. This apartment combines comfort, convenience, and natural beauty in a fantastic location—perfect for city professionals and small families alike!

Tenure: Leasehold 973 years 4 months

Service Charge: £2226

Ground Rent: £300

Local Authority: Southwark Council

Council Tax Band: F

Energy Efficiency Rating		
	Current	Potential
Very energy efficient - lower running costs		
A (92-100)		
B (81-91)		
C (69-80)	77	83
D (55-68)		
E (39-54)		
F (21-38)		
G (1-20)		
Not energy efficient - higher running costs		
England, Scotland & Wales		EU Directive 2002/91/EC

Chestertons Surrey Quays Sales

2 Plough Way
London
SE16 2EU

+44 (0)20 7378 0644
chestertons.co.uk

Rodney Point,
Rotherhithe Street, SE16

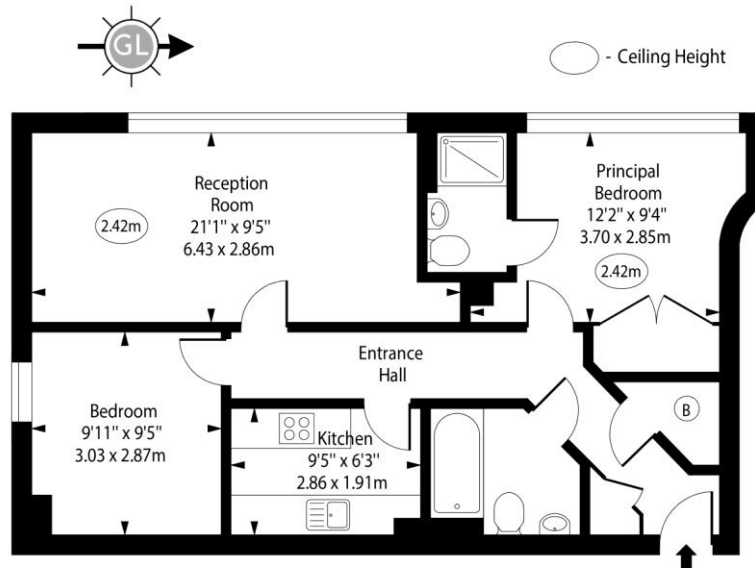

Second Floor

Approx Gross Internal Area 678 Sq Ft - 62.99 Sq M

For Illustration Purposes Only - Not To Scale
www.goldlens.co.uk
Ref. No. 025881J

