



# Bartholomew Close

London, EC1A

Asking Price £675,000

Situated in the sought-after Bartholomew Close, just moments from the iconic Smithfield Market, this bright and generously proportioned two-bedroom, two-bathroom apartment in the city.



# Bartholomew Close

London, EC1A

- 2 Double Bedrooms
- Private Balcony
- Moments From The Historic Smithfield Market
- Bright and Spacious
- Expansive City Skyline Views
- Two Bathrooms
- Light-Filled Reception Room
- Separate Kitchen
- Excellent Transport Links nearby, Including Farringdon and Barbican Stations





Positioned on the 4th floor with convenient lift access, the apartment features a light-filled reception room with expansive views across the city skyline. The layout is practical and well-balanced, with two double bedrooms, two bathrooms, and a separate kitchen.

While the property would benefit from some cosmetic modernisation, it presents a fantastic canvas to create a stylish city home in one of London's most vibrant neighbourhoods.

Additional benefits include discounted resident parking around Smithfield and easy access to excellent transport links, including Farringdon and Barbican stations.

This is a rarely available opportunity to secure a desirable apartment in a prime location with exciting potential.

---

**Tenure:** Leasehold 98 years 4 months

**Service Charge:** £4500 p.a

**Ground Rent:** £1150 p.a

**Local Authority:** City of London

**Council Tax Band:** G

---

### *Chestertons Tower Bridge Sales*

220 Tower Bridge Road

Tower Bridge

London

SE1 2UP

[towerbridge@chestertons.co.uk](mailto:towerbridge@chestertons.co.uk)

020 7357 7999

[chestertons.co.uk](https://www.chestertons.co.uk)



## Bartholomew Close, EC1A

○ - Ceiling Height

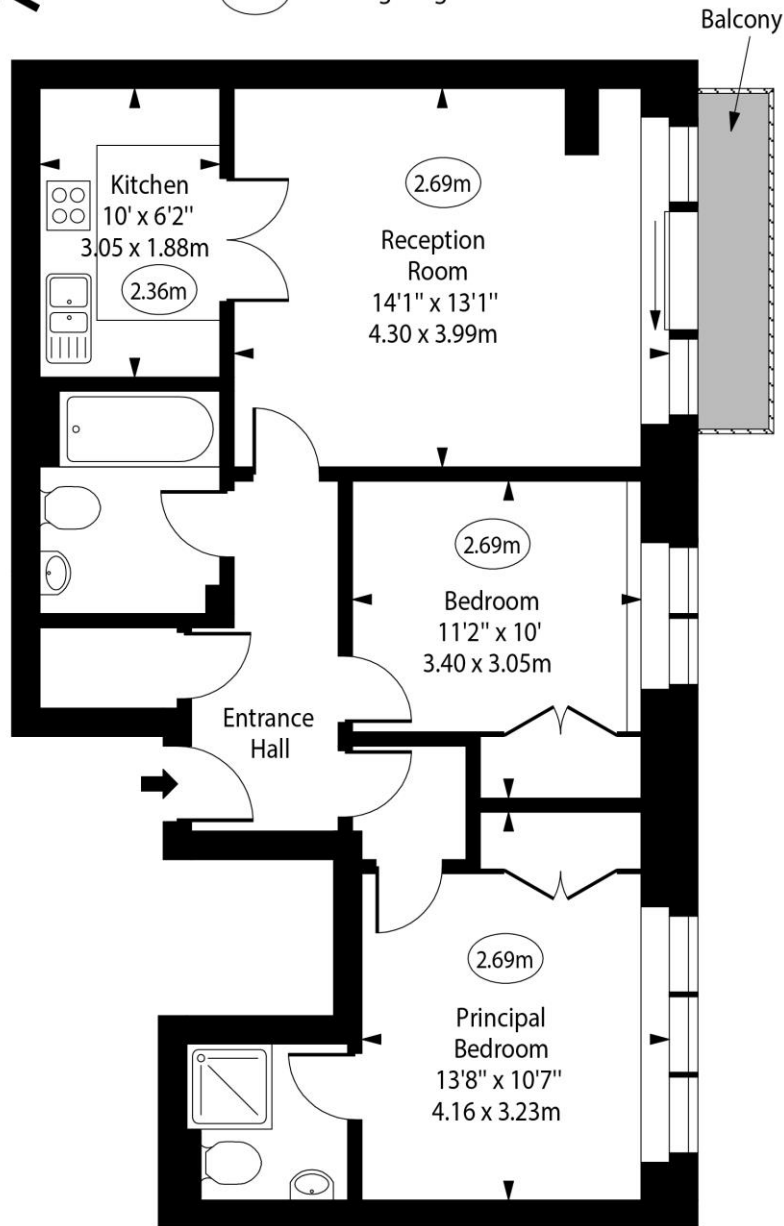

Fourth Floor

Approx Gross Internal Area      690 Sq Ft - 64.10 Sq M

For Illustration Purposes Only - Not To Scale

[www.goldlens.co.uk](http://www.goldlens.co.uk)

Ref. No. 027606R

