



# Rotherhithe Street

London, SE16

Asking Price £585,000

Stylish Two-Bedroom Maisonette with Private Entrance, Secure Parking, Private Patio and Excellent Transport Links in the Sought-After King and Queen Wharf, Rotherhithe





# Rotherhithe Street

London, SE16

- Maisonette
- Two Bedrooms
- Two Bathrooms
- Private Patio
- Private Secure Parking
- Leasehold
- Concierge
- Swimming Pool & Leisure Facilities
- Great Location
- Excellent Transport Links





Set within the desirable King and Queen development on Rotherhithe Street, this spacious and modern two-bedroom, two-bathroom maisonette offers approximately 962 sq. ft. of well-designed living space. With its own private front door, the property features a bright and generous reception with dining area, a fully equipped separate kitchen with integrated appliances. Both double bedrooms include built-in wardrobes and en-suite bath/shower rooms, while additional highlights include a cloakroom, utility space and a private front patio. Residents also benefit from concierge service, access to a swimming pool, and direct secure parking.

Perfectly located near Rotherhithe and Canada Water stations, with nearby bus stops and river taxi access, this home provides superb connectivity to The City and Canary Wharf. Local amenities such as Surrey Quays Shopping Centre, the new Canada Water development, and scenic riverside walks to Shad Thames offer a vibrant yet relaxed lifestyle. Combining comfort, convenience, and a prime riverside location, this maisonette is an exceptional opportunity for modern urban living.

**Tenure:** Leasehold 88 years 10 months

**Service Charge:** £5345.3 pa

**Ground Rent:** £200

**Local Authority:** London Borough of Southwark

**Council Tax Band:** E

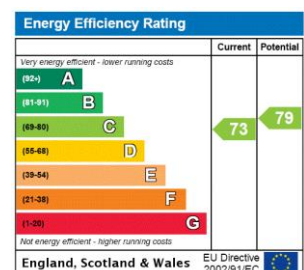

### *Chestertons Tower Bridge Sales*

220 Tower Bridge Road

Tower Bridge

London

SE1 2UP

towerbridge@chestertons.co.uk

020 7357 7999

chestertons.co.uk

# Rotherhithe Street, SE16

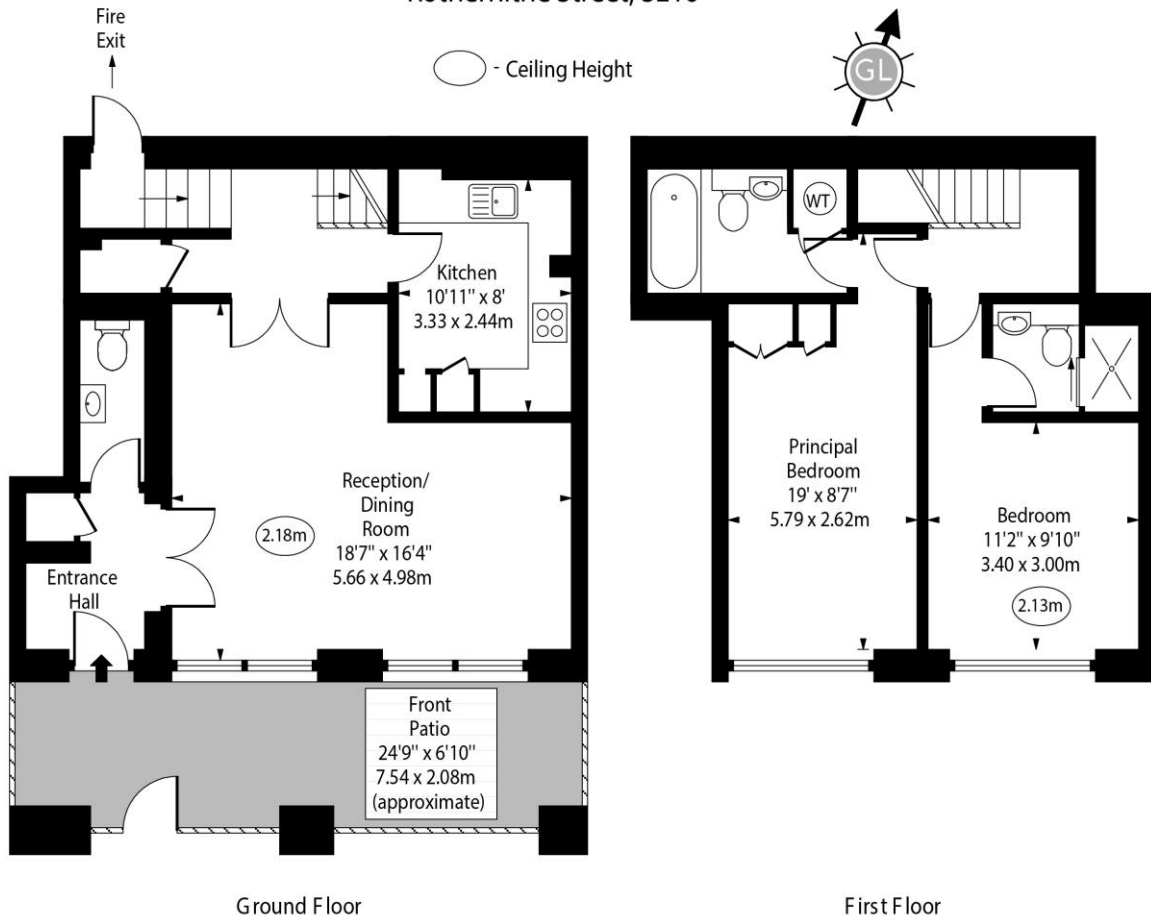

Approx Gross Internal Area 962 Sq Ft - 89.37 Sq M

For Illustration Purposes Only - Not To Scale  
www.goldlens.co.uk  
Ref. No. 027536K

