



Globe View

10 High Timber Street, EC4V

Offers in excess of £499,900

A very well presented one bedroom apartment in a desirable riverside development. Close to famous attractions, many transport links and the City. Residents benefit from a lift and concierge

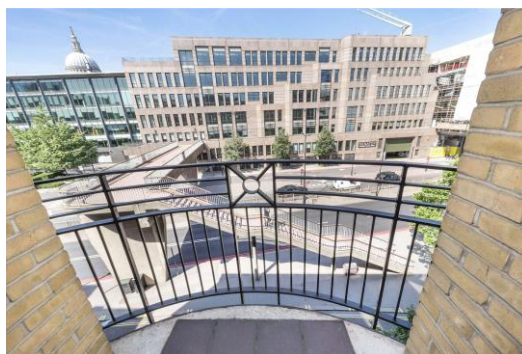

Globe View

10 High Timber Street, EC4V

- One bedroom
- Fourth Floor
- Concierge
- The Service Fees Included Water Fee
- Lift
- Riverside development
- Close to many transport links
- Communal Gardens



A very well presented one bedroom apartment on the fourth floor of a popular riverside development. Globe View is a development built around a central atrium. The apartment features a living room with access to a balcony, open plan kitchen, modern bathroom and bedroom with built in wardrobes.

Globe View residents benefit from a lift and concierge. It is located within close proximity to St Paul Cathedral and the City. It is moments from the Thames path and the Southbank can easily be accessed via the millennium footbridge. Nearby attractions include The Tate Modern, Borough Markets, Tower of London and St Pauls.

Transport links include Mansion House, Bank and Monument tube as well as Blackfriars and Cannon Street Stations.

Tenure: Share of Freehold 970 years 3 months

Service Charge: £3584 pa

Ground Rent: £0 Peppercorn

Local Authority: City of London

Council Tax Band: E

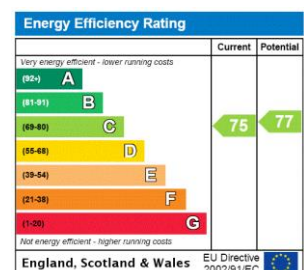

Chestertons Tower Bridge Sales

220 Tower Bridge Road

Tower Bridge

London

SE1 2UP

towerbridge@chestertons.co.uk

020 7357 7999

chestertons.co.uk

Globe View, High Timber Street, EC4V

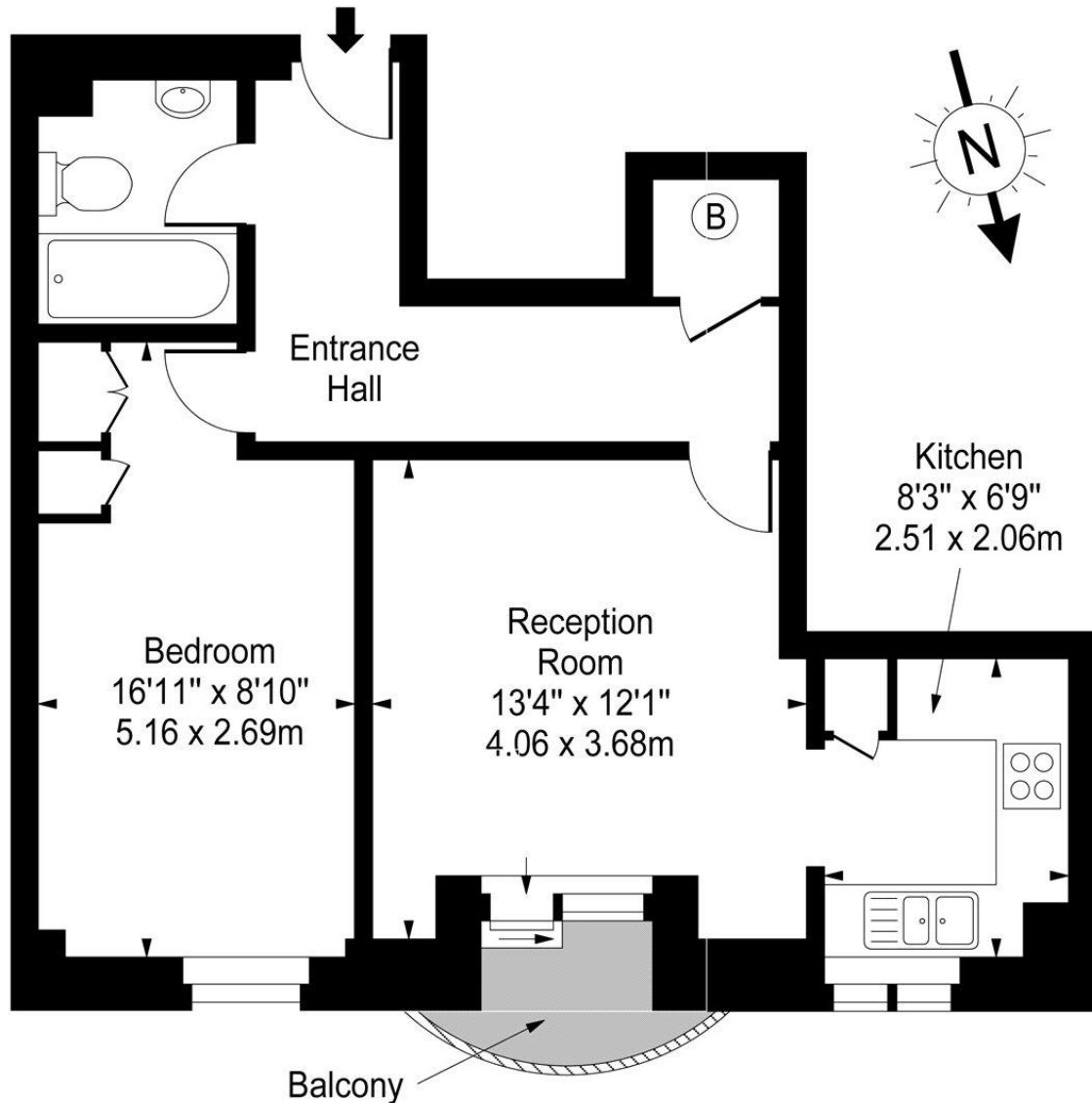

Fourth Floor

Approx Gross Internal Area 496 Sq Ft - 46.08 Sq M

For Illustration Purposes Only - Not To Scale

www.goldlens.co.uk

Ref. No. 010246J

