



Glastonbury Court

Farrow Lane, SE14

Asking Price £215,000

Third floor studio apartment in modern block. The property comprises of a large studio room, separate kitchen and bathroom. Located moments from New Cross Gate station and buses on the Old Kent Road.



Glastonbury Court

Farrow Lane, SE14

- Studio Apartment
- Bathroom
- Separate Kitchen
- Spacious
- Leasehold
- Bright and Airy
- Close to Transport



A naturally bright studio apartment in the vibrant New Cross area.

The property boasts a naturally bright studio room, a well-kept kitchen, stylish bathroom and additional storage space in the hallway.

Located in a quiet cul-de-sac and very close to a wide choice of local independent eateries, shops, and popular pubs. Local transport links include the mainline trains and London Overground at New Cross Gate and a wide range of bus routes via the Old Kent Road.

Tenure: Leasehold 89 years 6 months

Service Charge: £1289 p.a.

Ground Rent: £50 p.a.

Local Authority: London Borough Of Lewisham

Council Tax Band: B

Energy Efficiency Rating		
	Current	Potential
Very energy efficient - lower running costs		
A (92-100)		
B (81-91)		
C (69-80)	74	81
D (55-68)		
E (39-54)		
F (21-38)		
G (1-20)		
Not energy efficient - higher running costs		
England, Scotland & Wales		EU Directive 2002/91/EC

Chestertons Tower Bridge Sales

220 Tower Bridge Road

Tower Bridge

London

SE1 2UP

towerbridge@chestertons.co.uk

020 7357 7999

chestertons.co.uk

Glastonbury Court, Farrow Lane, SE14

○ - Ceiling Height

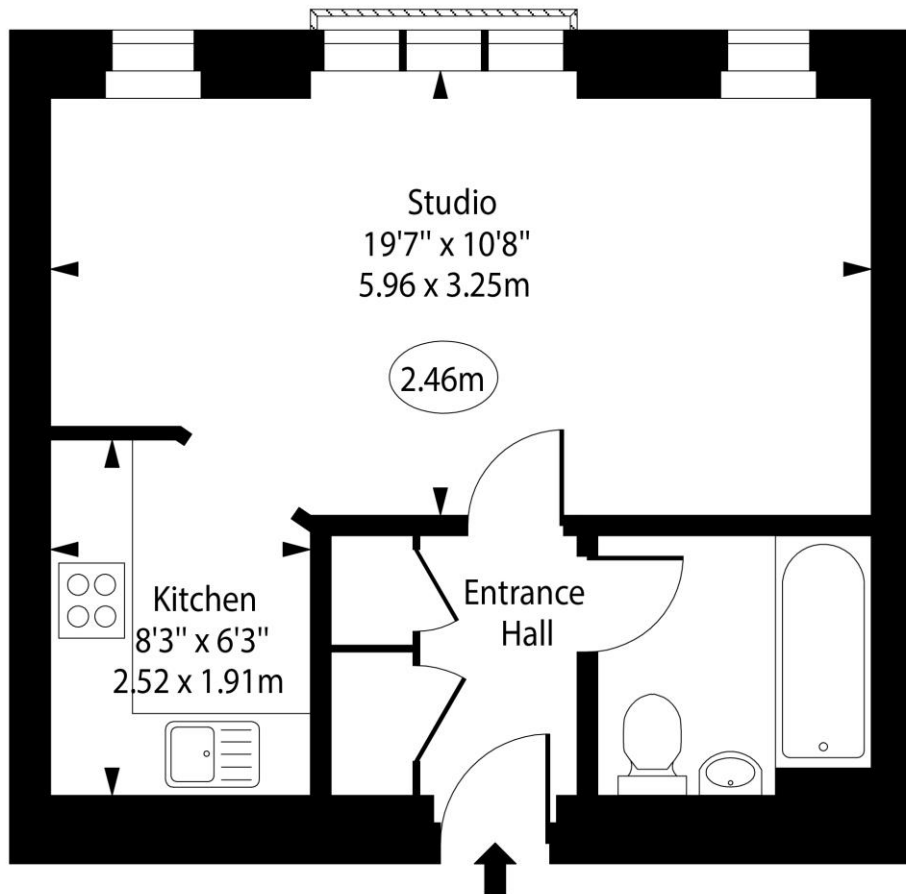

Third Floor

Approx Gross Internal Area 335 Sq Ft - 31.12 Sq M

For Illustration Purposes Only - Not To Scale

www.goldlens.co.uk

Ref. No. 022566R

