



Arcadia Court

45 Old Castle Street, E1

Asking Price £550,000

Charming Two-Bedroom Apartment in Historic Arcadia Court, Moments from Liverpool Street and Spitalfields



Arcadia Court

45 Old Castle Street, E1

- Two Bedrooms
- One Bathroom
- Leasehold
- Communal Garden
- Great Location
- Excellent Transport Links



This bright and spacious two-bedroom apartment, set within the historic Arcadia Court (formerly Wentworth Dwellings), offers a perfect blend of period charm and modern living. The apartment features two double bedrooms, a well-proportioned living room, a fully equipped semi open plan kitchen, and a contemporary bathroom, with large windows flooding the space with natural light. Residents also enjoy access to a communal courtyard with stunning views of London's skyline.

Located just south of Spitalfields and on the edge of the City, this property is ideally situated for easy access to local amenities, including Spitalfields Market, Brick Lane, and a host of restaurants, bars, and boutiques. Excellent transport links include Aldgate and Liverpool Street Station (with multiple Underground lines and National Rail services) ensuring fast and convenient connections across London.

Tenure: Leasehold 91 years 8 months

Service Charge: £4269 pa

Ground Rent: £225 pa

Local Authority: Tower Hamlets

Council Tax Band: C

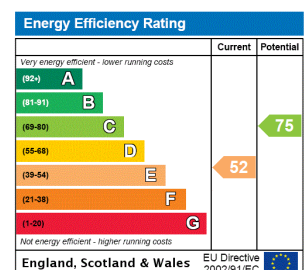

Chestertons Tower Bridge Sales

220 Tower Bridge Road

Tower Bridge

London

SE1 2UP

towerbridge@chestertons.co.uk

020 7357 7999

chestertons.co.uk

Arcadia Court,
Old Castle Street, E1

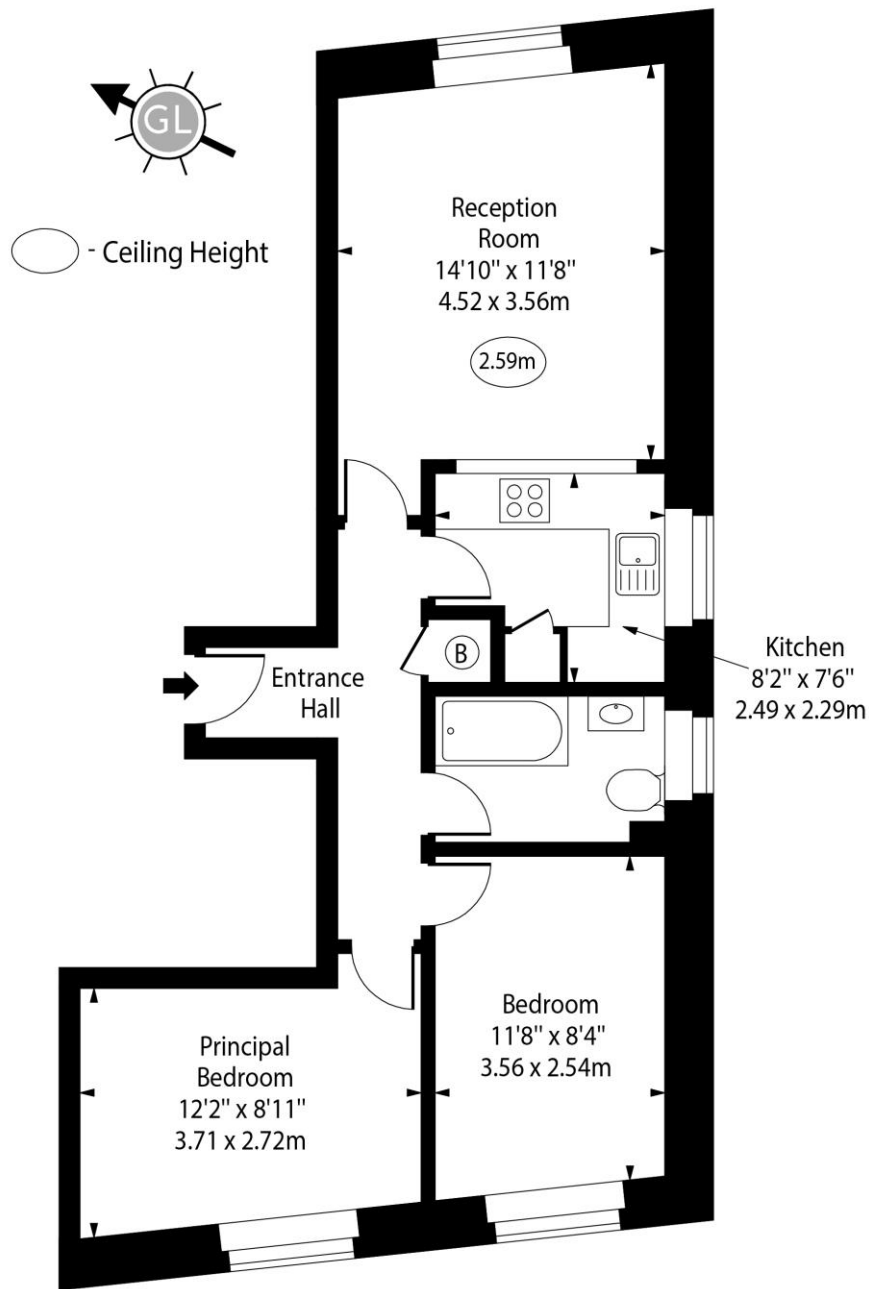

Second Floor

Approx Gross Internal Area 564 Sq Ft - 52.40 Sq M

For Illustration Purposes Only - Not To Scale

www.goldlens.co.uk

Ref. No. 026062E

