



St. Marks Street

London, E1

Offers in excess of £500,000

A very well-presented one bedroom apartment on the second floor located in the heart of the City. Features include access to a private communal terrace, large bedroom with built in wardrobes and a share of the freehold.

CHESTERTONS



St. Marks Street

London, E1

- Large Double bedroom
- Lift Access
- Access To Communal Terrace
- City Location
- Share of Freehold
- 700 + sq/ft
- No Chain



This spacious one-bedroom apartment offers spacious open living in a vibrant part of the City. Situated on the second floor and covering over 700 sq/ft, the property features an entrance hall, a master bedroom with built-in storage, a family bathroom, a separate kitchen, and a bright, generously sized living room. The development benefits from communal roof terrace with stunning views of the City skyline.

St. Mark Street is ideally located just moments from Aldgate East and Aldgate underground stations, with Whitechapel (Crossrail) and Liverpool Street stations also within walking distance. The area offers a wide range of local amenities, including the boutique shops, art galleries, cafes, bars, and restaurants of Brick Lane and Spitalfields Market.

Tenure: Share of Freehold 96 years 11 months

Service Charge: £2536.5 p.a

Ground Rent: £0

Local Authority: Tower Hamlets

Council Tax Band: E

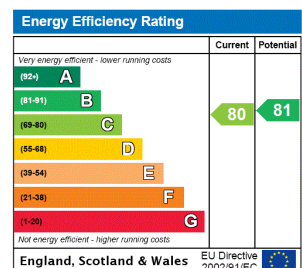

Chestertons Tower Bridge Sales

220 Tower Bridge Road

Tower Bridge

London, SE1 2UP

towerbridge@chestertons.co.uk

020 7357 7999

chestertons.co.uk

St. Mark Street, E1

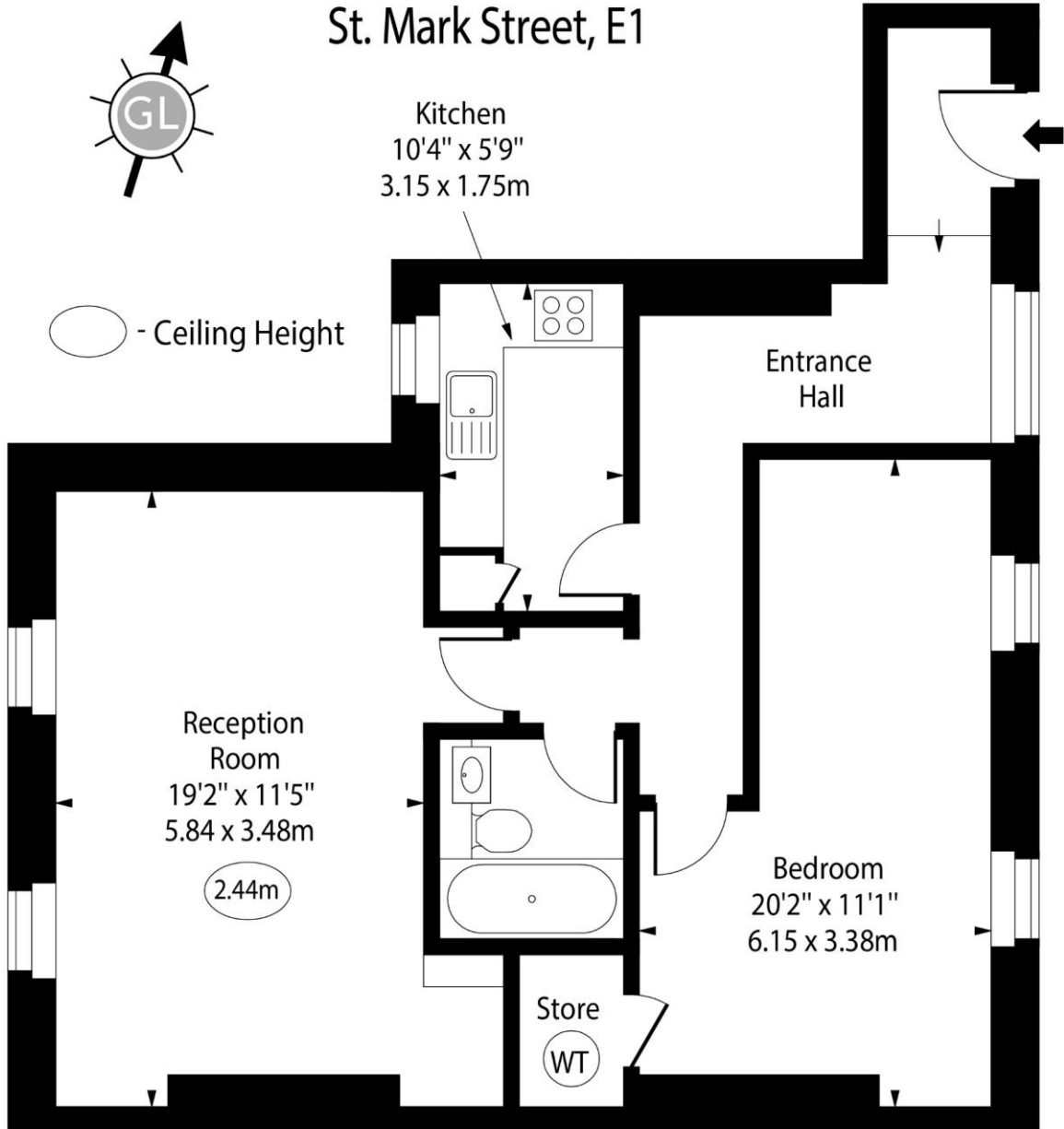

Second Floor

Approx Gross Internal Area 704 Sq Ft - 65.41 Sq M

For Illustration Purposes Only - Not To Scale

www.goldlens.co.uk

Ref. No. 025576K

