



Kelly Avenue

London, SE15

Offers in excess of
£600,000

A bright and spacious three bedroom penthouse apartment on Kelly Avenue, Peckham.

CHESTERTONS



Kelly Avenue

London, SE15

- Three Bedrooms
- Duplex
- Penthouse
- Leasehold
- Private Allocated Parking
- Great Location
- Excellent Transport Links
- Close to Amenities



This spacious three-bedroom property is in great condition and is offered chain free. The property is comprised of a large living room, two double bedrooms, one single bedroom or study and a three-piece bathroom suite. The property comes with an allocated parking space and on street parking is also available. The property is perfect for young professionals buying their first home or for an investor as a buy to let.

Kelly Avenue is conveniently located moments from the green expanses of Burgess Park and local amenities of Rye Lane, Peckham, which offers many shops, pubs, bars and restaurants. Queens Road Peckham Station offers excellent transport links via Overground and National Rail while Peckham Rye mainline offers frequent rail links into links into Central London. An array of local buses are easily accessible from Southampton Way, Sumner Road and Peckham Road.

Tenure: Leasehold 102 years 6 months
Service Charge: £2000
Ground Rent: £250 pa plus £70 for the parking
Local Authority: London Borough of Southwark
Council Tax Band: D

Energy Efficiency Rating		Current	Potential
Very energy efficient - lower running costs	A		
(92-100)	B		
(81-91)	C	80	80
(69-80)	D		
(55-68)	E		
(39-54)	F		
(21-38)	G		
Not energy efficient - higher running costs			
England, Scotland & Wales		EU Directive 2002/91/EC	

Chestertons Tower Bridge Sales

220 Tower Bridge Road
 Tower Bridge
 London
 SE1 2UP
 towerbridge@chestertons.co.uk
 020 7357 7999
 chestertons.co.uk

Kelly Avenue, SE15

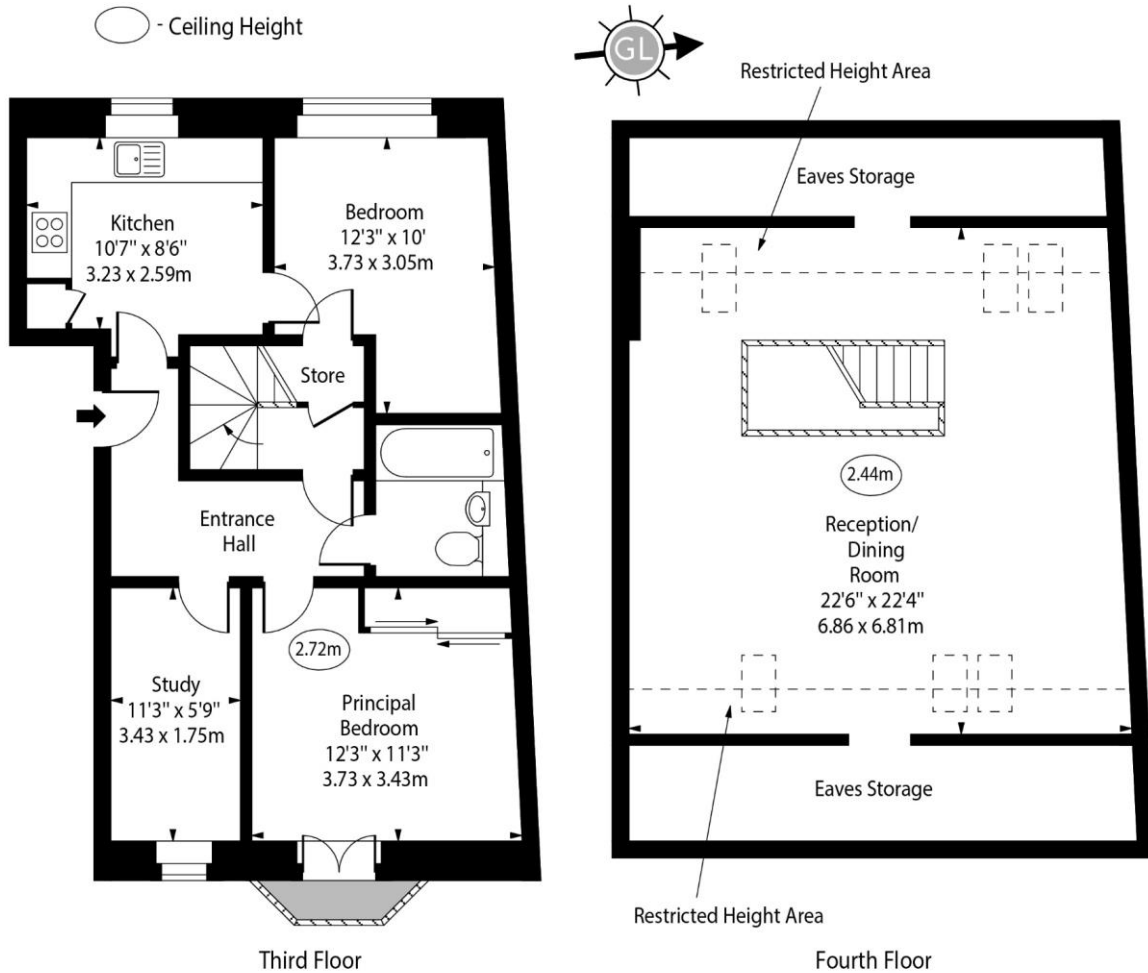

Approx Gross Internal Area 986 Sq Ft - 91.60 Sq M
Approx. Floor Area Including Restricted Heights 1073 Sq Ft - 99.68 Sq M
 (Excluding Eaves Storage)

For Illustration Purposes Only - Not To Scale
www.goldlens.co.uk
 Ref. No. 023897K