



# Dunton Road

London, SE1

Offers in excess of  
£500,000

This spacious four bedroom flat offers nearly 1200 square feet of living space, complemented by a delightful roof terrace. Perfect for buy-to-let investors or as a residence. Conveniently located with easy access to amenities and transport.



# Dunton Road

London, SE1

- Four bedrooms
- Leasehold
- Roof terrace
- Upper floor
- Permit parking available
- 1155 sq. ft.





This spacious four bedroom flat offers nearly 1200 square feet of living space, complemented by a delightful roof terrace.

The apartment is located on the first, second and third floors and features plenty of storage space. It has four bedrooms - three doubles and one single with a family bathroom.

The property is conveniently located with easy access to amenities and excellent transport links via a choice of bus routes in addition to Bermondsey tube and South Bermondsey train stations.

Perfect for buy-to-let investors or as a comfortable residence.

**Tenure:** Leasehold 90 years 6 months  
**Service Charge:** £6244 inc communal heating  
**Ground Rent:** £10  
**Local Authority:** Southwark Council  
**Council Tax Band:** C

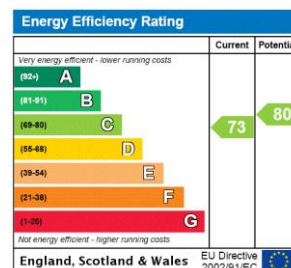

### Chestertons Tower Bridge Sales

220 Tower Bridge Road  
 Tower Bridge  
 London  
 SE1 2UP  
 towerbridge@chestertons.co.uk  
 020 7357 7999  
 chestertons.co.uk

# Dunton Road, SE1

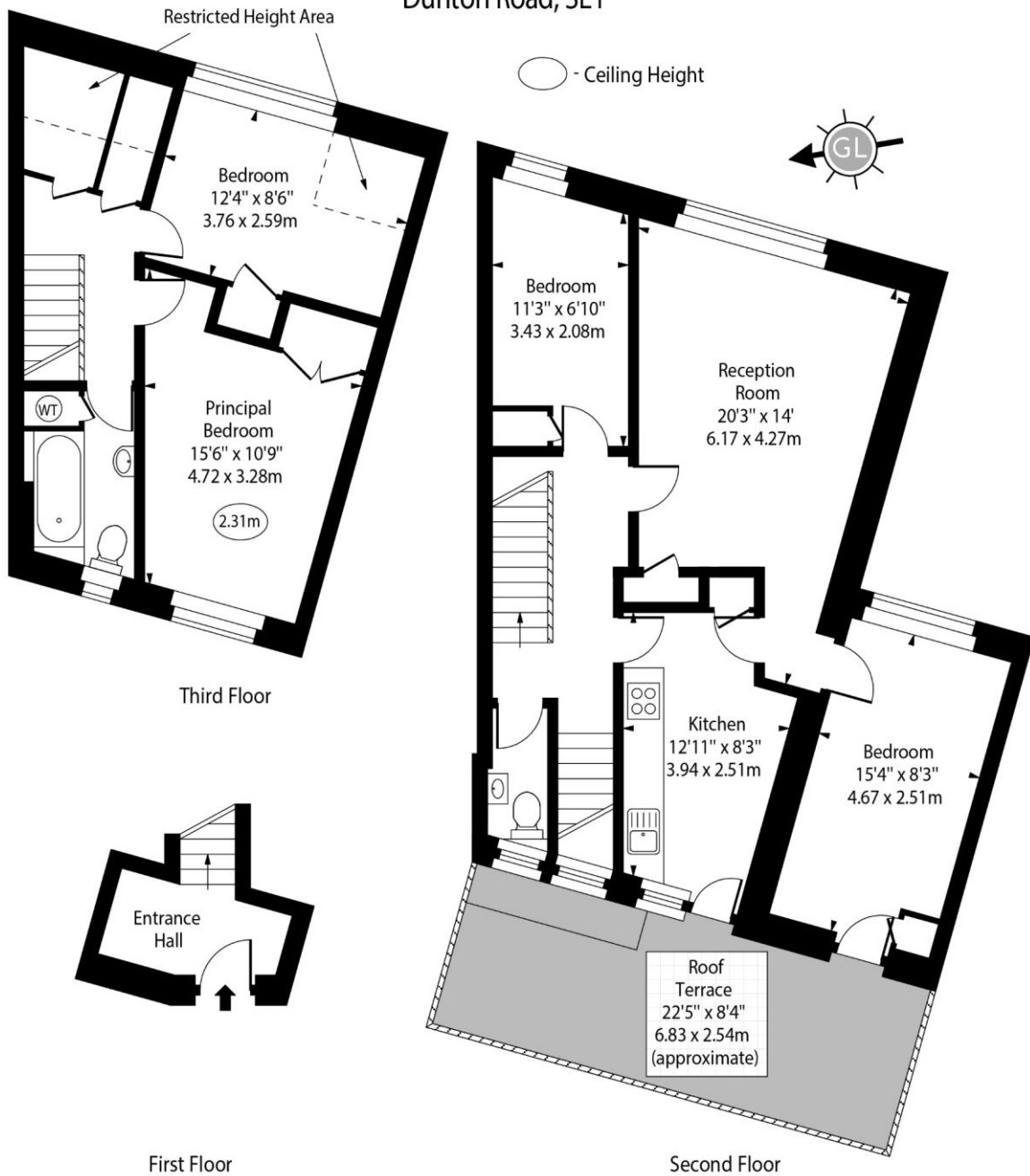

Approx Gross Internal Area      1112 Sq Ft - 103.30 Sq M  
 Approx. Floor Area Including Restricted Heights      1155 Sq Ft - 107.30 Sq M

For Illustration Purposes Only - Not To Scale  
[www.goldlens.co.uk](http://www.goldlens.co.uk)  
 Ref. No. 020729K