



Dunton Road

London, SE1

Offers in excess of
£550,000

This spacious four bedroom flat offers nearly 1200 square feet of living space, complemented by a delightful roof terrace. Perfect for buy-to-let investors or as a residence. Conveniently located with easy access to amenities and transport.



Dunton Road

London, SE1

- Four bedrooms
- Leasehold
- Roof terrace
- Upper floor
- Permit parking available
- 1155 sq. ft.



This spacious four bedroom flat offers nearly 1200 square feet of living space, complemented by a delightful roof terrace.

The apartment is located on the first, second and third floors and features plenty of storage space. It has four bedrooms - three doubles and one single with a family bathroom.

The property is conveniently located with easy access to amenities and excellent transport links via a choice of bus routes in addition to Bermondsey tube and South Bermondsey train stations.

Perfect for buy-to-let investors or as a comfortable residence.

Tenure: Leasehold 91 years 4 months
Service Charge: £6244 inc communal heating
Ground Rent: £10
Local Authority: Southwark Council
Council Tax Band: C

Energy Efficiency Rating		
	Current	Potential
Very energy efficient - lower running costs		
(94-100) A		
(81-93) B		
(69-80) C	73	80
(55-68) D		
(39-54) E		
(21-38) F		
(1-20) G		
Not energy efficient - higher running costs		
England, Scotland & Wales EU Directive 2002/91/EC		

Chestertons Tower Bridge Sales

220 Tower Bridge Road
 Tower Bridge
 London
 SE1 2UP
 towerbridge@chestertons.co.uk
 020 7357 7999
 chestertons.co.uk

Dunton Road, SE1

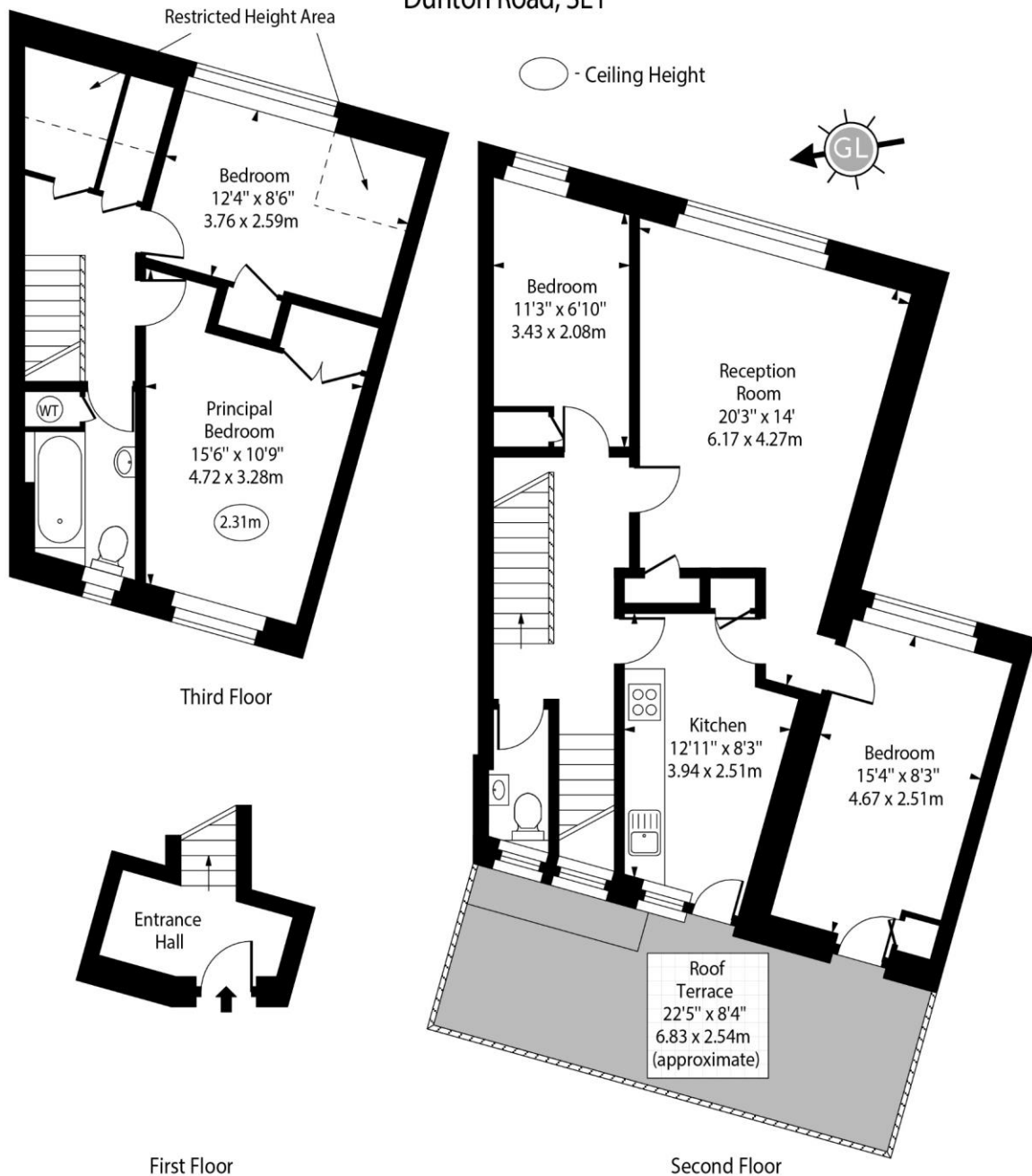

Approx Gross Internal Area 1112 Sq Ft - 103.30 Sq M
 Approx. Floor Area Including Restricted Heights 1155 Sq Ft - 107.30 Sq M

For Illustration Purposes Only - Not To Scale
www.goldlens.co.uk
 Ref. No. 020729K