



Chartfield Avenue

SW15

Asking Price £148,750

A spacious and quiet one bedroom garden flat situated away from the main road within a private gated development.

CHESTERTONS



Chartfield Avenue

SW15

- ** SHARED OWNERSHIP**
- Spacious one bedroom
- Open plan living
- Modern bathroom
- Ample storage space
- Private patio
- Roof terrace and communal gardens
- Underfloor heating



A spacious and quiet one bedroom garden flat situated away from the main road within a private gated development.

The property offers larger than average block living with ample storage. A modern feel throughout with an excellent layout leading on to a private patio. Residents of Putney Square benefit from a concierge, bike store, residents only gym, communal gardens and a roof terrace.

This property is being offered chain free.

Putney Square is a luxury residential development arranged around a central landscaped courtyard with elegant water features. The flat is currently located just 0.3 miles from Putney Station with direct trains into Waterloo, 0.6 miles from East Putney tube station and buses immediately outside the development which go directly into the West End 24/7.

Tenure: Leasehold 140 years 6 months – Expiring 23/07/2165

Service Charge: £3,400 per annum

Ground Rent: Peppercorn

Local Authority: London Borough of Wandsworth

Council Tax Band: E

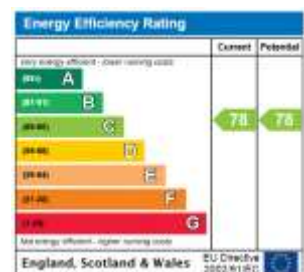

Chestertons Putney Sales

153 Upper Richmond Road

London

SW15 2TX

putney@chestertons.co.uk

020 8246 5959

chestertons.co.uk

Avershaw House, Chartfield Avenue, SW15

Approximate Gross Internal Area 51 sq.m / 549 sq.ft

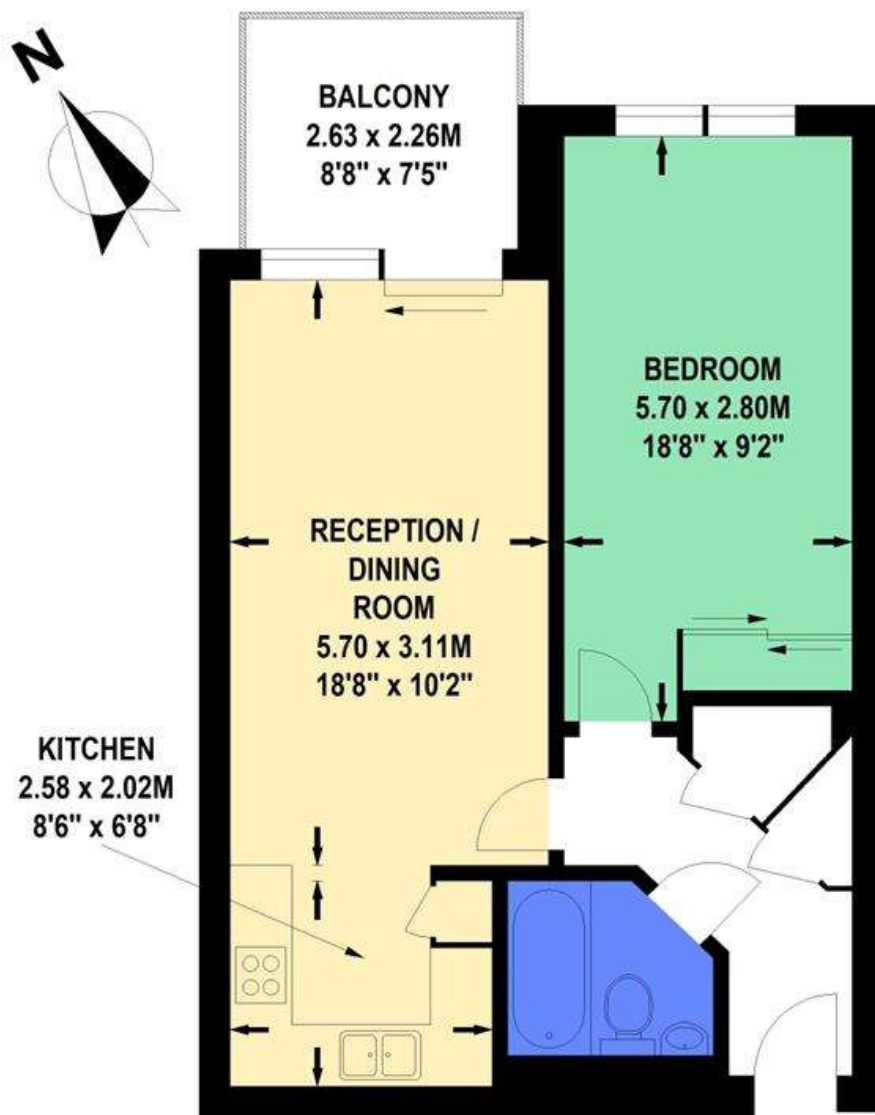

Lower Ground Floor

Floor Plan produced for Allan Fuller by Mays Floorplans © . Tel 020 3397 4594

Illustration for identification purposes only, not to scale

All measurements are maximum, and include wardrobes and window bays where applicable

