



Glenalmond House

Manor Fields, SW15

Asking Price £750,000

This beautiful example of a Manor Fields mansion flat has recently been impeccably finished throughout, offering 1,000 sq. ft. of living accommodation, with magnificent views of the pond and the wonderfully kept communal gardens.



Glenalmond House

Manor Fields, SW15

- Two Double Bedrooms
- Contemporary Bathroom with Separate WC
- Modern Fitted Kitchen
- Double Reception Room
- Communal Gardens
- Share of Freehold
- No Onward Chain
- Double Glazed throughout



This beautiful example of a Manor Fields mansion flat has recently been impeccably finished throughout, offering 1,000 sq. ft. of living accommodation, with magnificent views of the pond and the wonderfully kept communal gardens.

Featuring double glazed windows throughout, beautifully renovated bathroom and a contemporary kitchen with integrated appliances, this stunning corner apartment offers two double bedrooms and a very large double reception room.

Glenalmond House is ideally situated with the development, away from Putney Hill and overlooking the picturesque pond and surrounding manicured grounds.

Manor Fields is an Art Deco style private development located just off Putney Hill. Local transport into London is available via Putney mainline station & East Putney Underground station. Excellent restaurants, bars, cafes and shops can be found on the nearby Putney High Street.

Tenure: Leasehold expires 01/04/2983

Service Charge: £7,449 p.a

Local Authority: London Borough of Wandsworth

Council Tax Band: E

Energy Efficiency Rating		Current	Potential
Very energy efficient - lower running costs			
(92-100)	A		
(81-91)	B		83
(69-80)	C	74	
(55-68)	D		
(39-54)	E		
(21-38)	F		
(1-20)	G		
Not energy efficient - higher running costs			
England, Scotland & Wales		EU Directive 2002/91/EC	

Chestertons Putney Sales

153 Upper Richmond Road

London

SW15 2TX

putney@chestertons.co.uk

020 8246 5959

chestertons.co.uk

Glenalmond House,
Manor Fields,
Putney, SW15

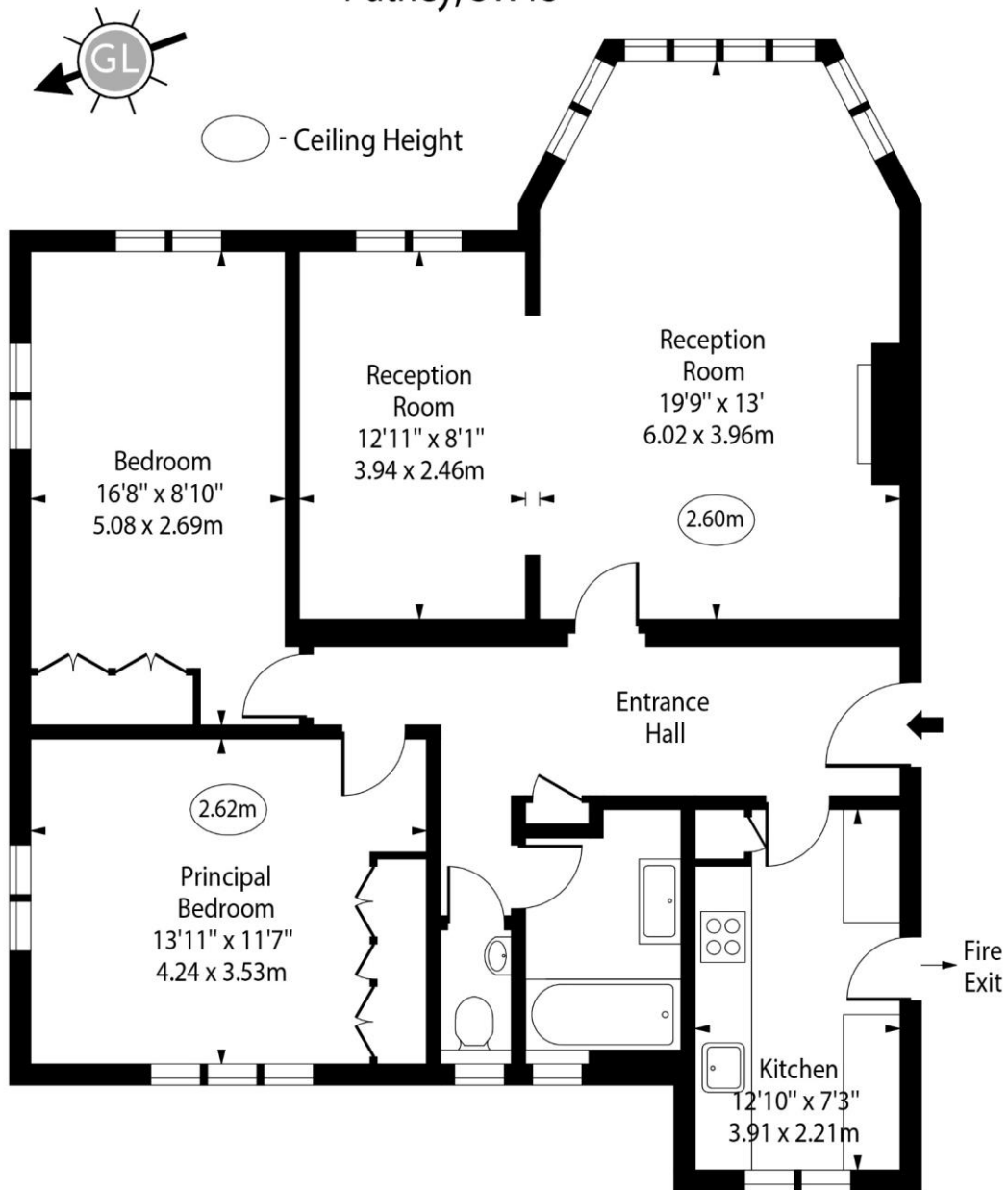

Second Floor

Approx Gross Internal Area 984 Sq Ft - 91.41 Sq M

For Illustration Purposes Only - Not To Scale

www.goldlens.co.uk

Ref. No. 025379E

