



# Disraeli Gardens

London, SW15

Asking Price £675,000

Disraeli Gardens is a highly regarded mansion flat located on a pretty tree-lined residential street just moments from East Putney Tube Station and Wandsworth Park.

**CHESTERTONS**



# Disraeli Gardens

London, SW15

- Handsome building
- Share of Freehold
- Two bedrooms
- Communal Gardens
- Tennis Court
- Central Putney location
- 0.2 miles from East Putney Tube



Disraeli Gardens is a highly regarded mansion flat located on a pretty tree-lined residential street just moments from East Putney Tube Station and Wandsworth Park.

Located on the ground floor and benefitting from its own front door, this charming property offers 842sf of accommodation, as you enter you have two double bedrooms to your left, both with large sash windows and high ceilings. There is a family bathroom before you get to the semi open plan kitchen living room area, all presented in good condition.

The property benefits from plenty of period features, including sash windows, high ceilings and feature fireplaces. The handsome building has been recently redecorated and benefits from beautifully maintained communal gardens and a tennis court.

Disraeli Gardens is conveniently located just moments from Putney High Street. It is just 0.2 miles away from Putney mainline station with its overland link into London Waterloo and 0.2 miles from East Putney tube station with access to the District line. Putney High Street itself, has an array of shops, restaurants and bars. Wandsworth Park and the River Thames are also nearby.

**Tenure:** Leasehold (Expiry: 29/09/2970)

**Service Charge:** £3,603.11 p.a.

**Ground Rent:** £25 p.a.

**Local Authority:** London Borough of Wandsworth

**Council Tax Band:** E

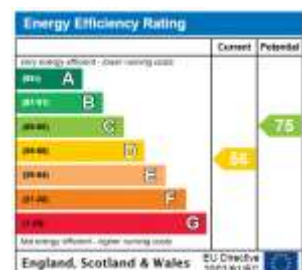

**Chestertons Putney Sales**

153 Upper Richmond Road

London

SW15 2TX

putney@chestertons.co.uk

020 8246 5959

chestertons.co.uk

Disraeli Gardens, SW15

○ - Ceiling Height

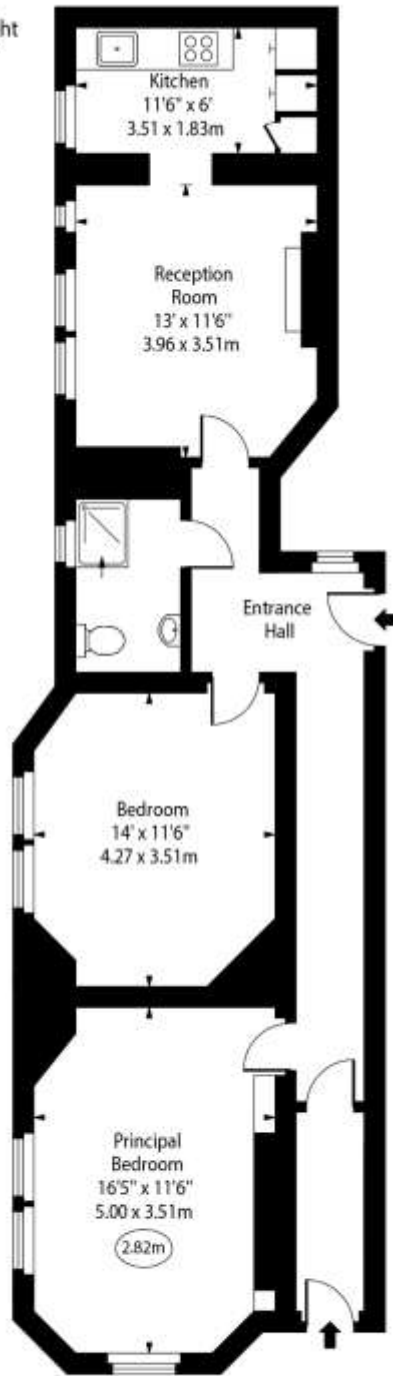

Ground Floor

Approx Gross Internal Area 842 Sq Ft - 78.22 Sq M

For Illustration Purposes Only - Not To Scale  
www.goldlens.co.uk  
Ref. No. 025042E

