



# Holmbush Road

London, SW15

Asking Price £590,000

A spacious two double bedroom flat with period character on a highly desirable residential street. This flat is situated on the first floor of an attractive building with a communal garden to the rear.



# Holmbush Road

London, SW15

- Period property
- Two double bedrooms
- First floor
- Large windows - lots of light
- High ceilings with a spacious feel
- Modern kitchen & bathroom
- Move-in ready condition
- No chain
- Sought after street/location





A spacious two double bedroom flat with period character on a highly desirable residential street. This flat is situated on the first floor of an attractive Edwardian building with a communal garden to the rear.

The flat consists of a wonderful spacious lounge with a large window and high ceilings, a large main bedroom with full height fitted wardrobes, a second double bedroom also with built in wardrobes and a reasonably modern kitchen and bathroom. The whole flat benefits from high ceilings, plenty of light and is in move-in ready condition.

Holmbush Road is a very desirable quiet residential street with a small green. It is around 10 minutes' walk to East Putney Tube station which is surrounded by lovely shops, restaurants, bars, cafes and pubs. Putney's train station and main high street is within walking distance too as are the green spaces of Wandsworth Park and Putney Heath.

**Tenure:** Leasehold expires 15/02/2190

**Service Charge:** £4023.5

**Local Authority:** London Borough of Wandsworth

**Council Tax Band:** E

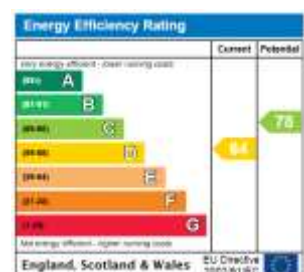

*Chestertons Putney Sales*

153 Upper Richmond Road

London

SW15 2TX

putney@chestertons.co.uk

020 8246 5959

chestertons.co.uk

# Holmbush Road, SW15

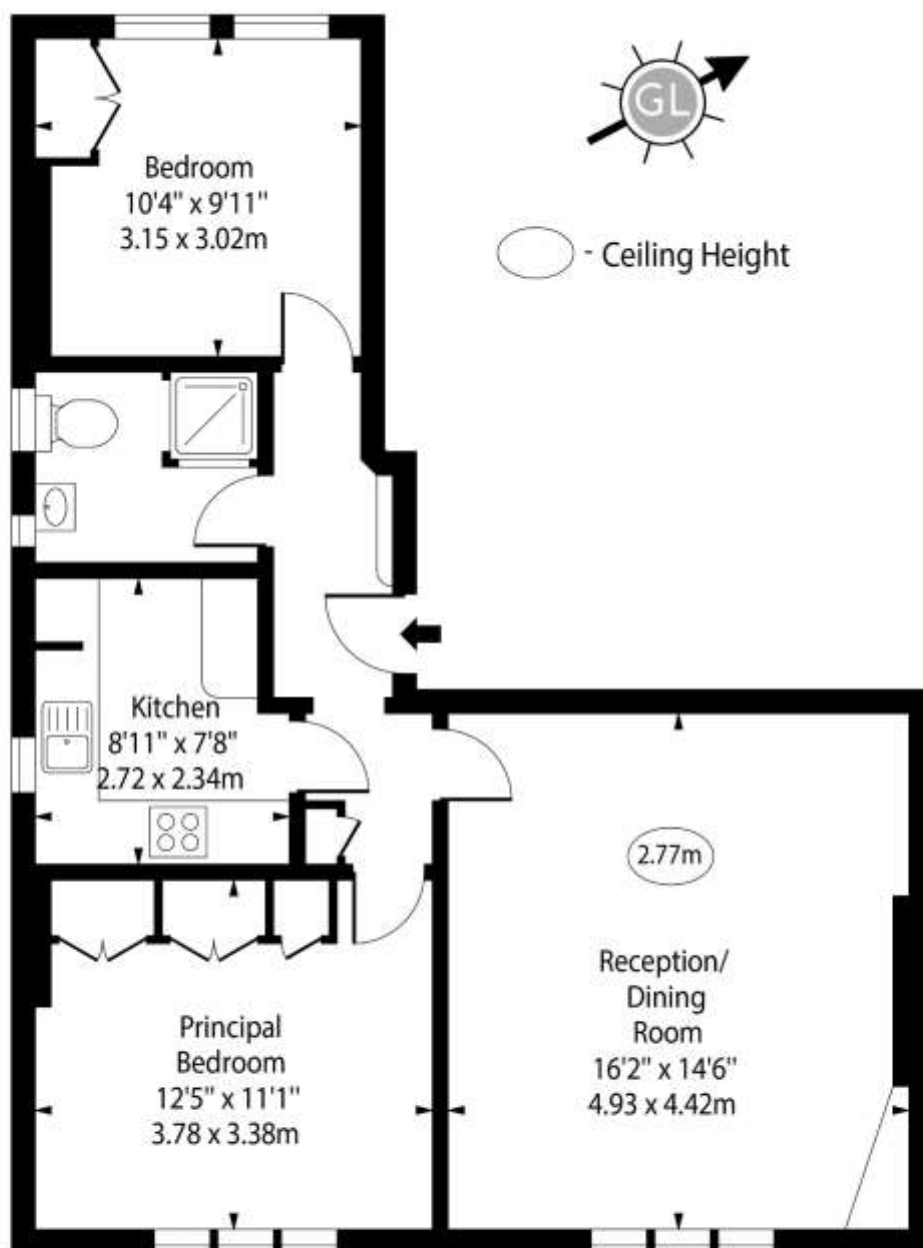

## First Floor

Approx Gross Internal Area 672 Sq Ft - 62.43 Sq M

For Illustration Purposes Only - Not To Scale

[www.goldlens.co.uk](http://www.goldlens.co.uk)

Ref. No. 018987M

