



Highlands Heath

Portsmouth Road, SW15

Asking Price £650,000

A handsome, well-proportioned three bedroom flat in the sought after Highlands Heath development, located in the heart of Putney Heath

CHESTERTONS



Highlands Heath

Portsmouth Road, SW15

- Located in the heart of Putney Heath
- Three double bedrooms
- Family WC and guest toilet
- Large separate windows with bay window
- Manicured communal gardens
- Off street parking



A handsome, well-proportioned three bedroom flat in the sought after Highlands Heath development, located in the heart of Putney Heath

The flat is positioned on the second floor with aspects of the well-maintained communal gardens throughout. It has 3 double bedrooms, a family bathroom and further WC, large scenic reception room and separate fully fitted kitchen. This gorgeous development further benefits from communal gardens, tennis court, squash courts, off-street parking, lift and estate manager.

Highlands Heath is nestled within Putney Heath, also known as "Putney Village" with its leafy surroundings, access to the commons, cricket pitch and the legendary Telegraph pub. There are excellent bus services including the 424 running from near the estate entrance to Putney High Street, plus other services from the Green Man terminus leading to the West End and the City. Additional transport links include East Putney Underground (District Line) and Putney mainline station with easy routes into London Victoria and London Waterloo.

Tenure: Leasehold expires 25/03/3018

Service Charge: £6445.12 maintenance of buildings and gardens, caretaker and contribution to sinking fund

Local Authority: London Borough of Wandsworth

Council Tax Band: E

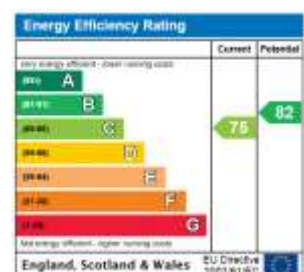

Chestertons Putney Sales

153 Upper Richmond Road

London

SW15 2TX

putney@chestertons.co.uk

020 8246 5959

chestertons.co.uk

Highlands Heath,
Portsmouth Road, SW15

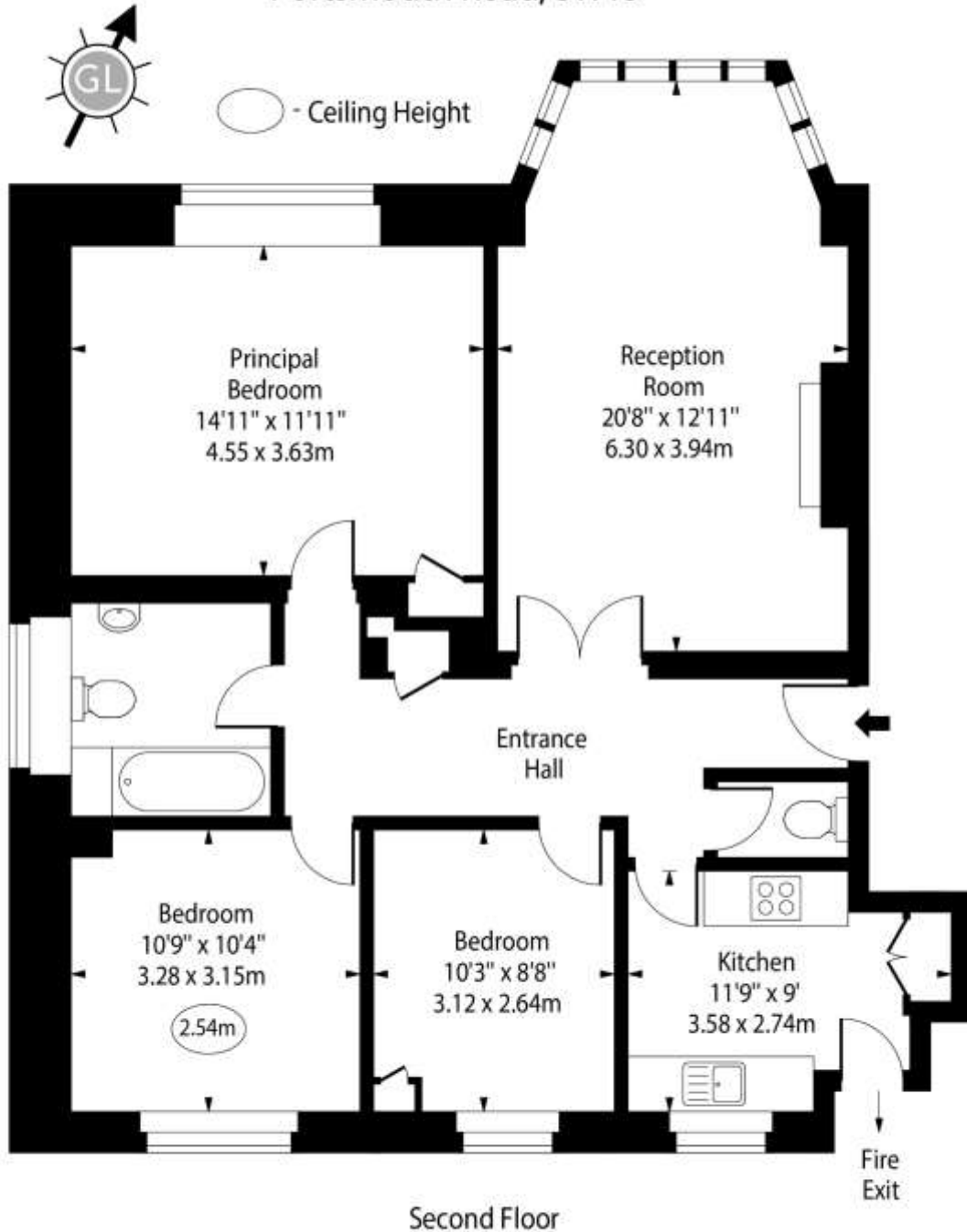

Approx Gross Internal Area 962 Sq Ft - 89.37 Sq M

For Illustration Purposes Only - Not To Scale

www.goldlens.co.uk

Ref. No. 023575E