



Gillingham Street
Victoria, SW1V

CHESTERTONS





A well-presented two-bedroom, two-bathroom apartment ideally situated just moments from Victoria Station. Located on the 7th floor, the property is in good condition throughout and benefits from lift access, porter service, and is offered with no onward chain. Residents are welcomed by a smart entrance lobby featuring a concierge desk and two lifts, providing convenient access to the apartment, one underground Parking Space.

Gillingham Street lies in the heart of Pimlico, surrounded by an excellent range of local shops, cafes, bars, and restaurants. Victoria Station is nearby, offering superb transport links including the Gatwick Express, National Rail services, and the District, Circle, and Victoria Underground lines for easy travel across London and beyond.

- Well-presented two-bedroom, two-bathroom apartment on the 7th floor
- Property includes benefits such as lift access and porter service
- Offered with no onward chain, one underground Parking Space.
- Modern Two bedrooms Two Bathrooms
- Located on Gillingham Street in the heart of Pimlico,
- Excellent transport links nearby at Victoria Station

Asking Price £880,000

Energy Efficiency Rating		Current	Potential
100-120	A		
81-101	B		
62-80	C	78	80
43-61	D		
25-42	E		
10-24	F		
1-9	G		

Not energy efficient - higher running costs

England, Scotland & Wales EU Directive 2002/91/EC

Tenure: Leasehold - 999 years less 3 days from 29 September 2007

Service Charge: £8716 Per Annum

Ground Rent: £250 Per Annum

Local Authority: Westminster

Council Tax Band: F

Chestertons Westminster & Pimlico Lettings

105 Wilton Road

London

SW1V 1DZ

westminsterlettingsusers@chestertons.co.uk

02030408220

chestertons.co.uk

Gillingham Street, SW1V

Approximate Gross Internal Area

64.65 sq m / 696 sq ft

(Including restricted height
under 1.5m [-----])

(CH = Ceiling Heights)

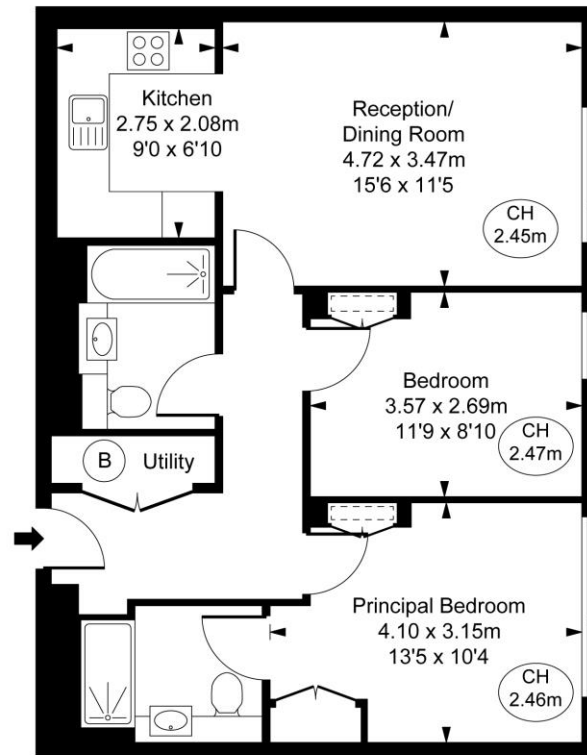

Seventh Floor

This plan is not to scale. It is for guidance and not for valuation purposes.
All measurements and areas are approximate only, and have been prepared in accordance with the current edition of the RICS Code of Measuring Practice.
© Fulham Performance

Chesterton UK Services Limited trading as Chestertons for themselves and for the vendor of this property whose agents they are, give notice that (i) these particulars do not constitute any part of an offer or contract, (ii) all statements contained within these particulars are made without responsibility on the part of Chestertons or the vendor, (iii) whilst made in good faith, none of the statements contained within these particulars are to be relied upon as a statement or representation of fact, (iv) any intending purchasers must satisfy themselves by inspection or otherwise as to the correctness of each of the statements contained within these particulars, (v) the vendor does not make or give either Chestertons or any person in their employment any authority to make or give representation or warranty whatsoever in relation to this property. Wide angle lenses may be used. ©Copyright Chestertons | Chesterton UK Services Limited | Registered Office 40 Connaught Street, Hyde Park, London W2 2AB Registered Company Number 05334580.



This paper is
100% recyclable