



Ashley Court
Morpeth Terrace, SW1P





A very well presented first floor apartment with lift situated in a very popular development, located on the very desirable Morpeth Terrace.

This spacious property comprises a good sized reception room with stunning views of Westminster Cathedral, a generous double bedroom with fitted wardrobes, well equipped kitchen and a bathroom.

Benefits include onsite caretaker, share of freehold, lift access and is being offered with no onward chain.

Ashley Court is located in the Westminster Cathedral Conservation Area, conveniently situated for local amenities and the extensive transport facilities of Westminster (Jubilee, Circle and District lines) and Victoria (Victoria, Circle and District lines, Mainline station and Gatwick Express).

- Very Well Presented One Double Bedroom apartment
- Light Reception Room
- Kitchen
- Bathroom
- Lift Access
- Share of Freehold

Asking Price £600,000

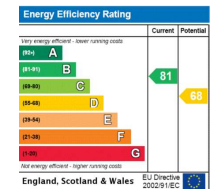

Tenure: Share of Freehold 959 years – Lease expires on 23rd March 2984

Service Charge: £4,950 (Which includes heating and hot water)

Ground Rent: £0

Local Authority: City of Westminster

Council Tax Band: D

Chestertons Westminster & Pimlico Sales

105 Wilton Road

London

SW1V 1DZ

westminster@chestertons.co.uk

020 3040 8201

chestertons.co.uk

Ashley Court,
Morpeth Terrace, SW1P
Approximate Gross Internal Area
46.83 sq m / 504 sq ft
(CH = Ceiling Heights)

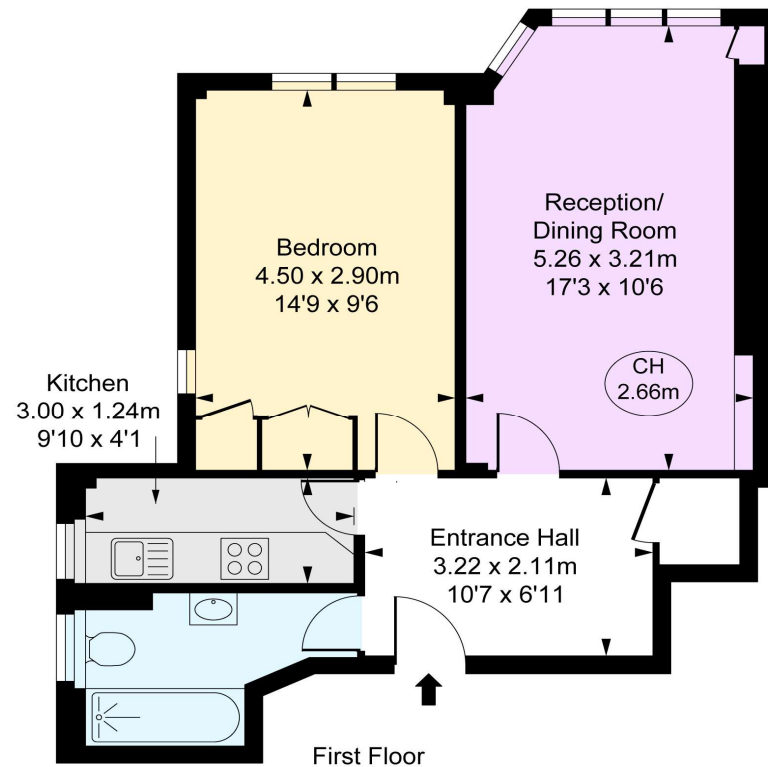

This plan is not to scale. It is for guidance and not for valuation purposes.
All measurements and areas are approximate only, and have been prepared in accordance with the current edition of the RICS Code of Measuring Practice.
© Fulham Performance

Chesterton UK Services Limited trading as Chestertons for themselves and for the vendor of this property whose agents they are, give notice that (i) these particulars do not constitute any part of an offer or contract, (ii) all statements contained within these particulars are made without responsibility on the part of Chestertons or the vendor, (iii) whilst made in good faith, none of the statements contained within these particulars are to be relied upon as a statement or representation of fact, (iv) any intending purchasers must satisfy themselves by inspection or otherwise as to the correctness of each of the statements contained within these particulars, (v) the vendor does not make or give either Chestertons or any person in their employment any authority to make or give representation or warranty whatsoever in relation to this property. Wide angle lenses may be used. ©Copyright Chestertons | Chesterton UK Services Limited | Registered Office 40 Connaught Street, Hyde Park, London W2 2AB Registered Company Number 05334580.

