



Shelley House
Churchill Gardens, SW1V

CHESTERTONS





This stunning one-bedroom flat in Pimlico has undergone a complete refurbishment and is impeccably presented. The spacious double bedroom, modern separate kitchen, and stylish bathroom provide a comfortable and functional living space.

Beyond your doorstep, the flat overlooks peaceful communal gardens with captivating views of the River Thames and Battersea Power Station. Moments away, Pimlico offers a vibrant selection of shops, cafes, and restaurants. Escape the city buzz in the sprawling green spaces of Battersea Park, or take advantage of excellent transport links from Pimlico and Victoria stations.

- Immaculately presented: Recently refurbished 1-bedroom flat in Pimlico.
- Spacious & Functional: Features a large double bedroom, modern separate kitchen, and stylish bathroom.
- Tranquil Escape: Overlooks communal gardens with views of the River Thames and Battersea Power Station.
- Vibrant Location: Moments from Pimlico's shops, cafes, and restaurants.
- Green Oasis: Escape the city in the nearby Battersea Park.
- Excellent Transport Links: Easily connected via Pimlico and Victoria stations.

Asking Price
£450,000

Energy Efficiency Rating		Current	Potential
95-100	A		
81-95	B		
69-81	C		
55-69	D	68	74
39-55	E		
21-39	F		
1-21	G		

Not energy efficient - higher running costs

EU Directive 2002/91/EC
England, Scotland & Wales

Tenure: Leasehold – expires 25 October 2196
Service Charge: £2,200 (Approximately)
Ground Rent: Peppercorn
Local Authority: City of Westminster
Council Tax Band: B

Chestertons Westminster & Pimlico Sales

105 Wilton Road
 London
 SW1V 1DZ
 westminster@chestertons.co.uk
 020 3040 8201
 chestertons.co.uk

Shelley House,
Churchill Gardens, SW1V

Approximate Gross Internal Area
41.25 sq m / 444 sq ft



(CH = Ceiling Heights)

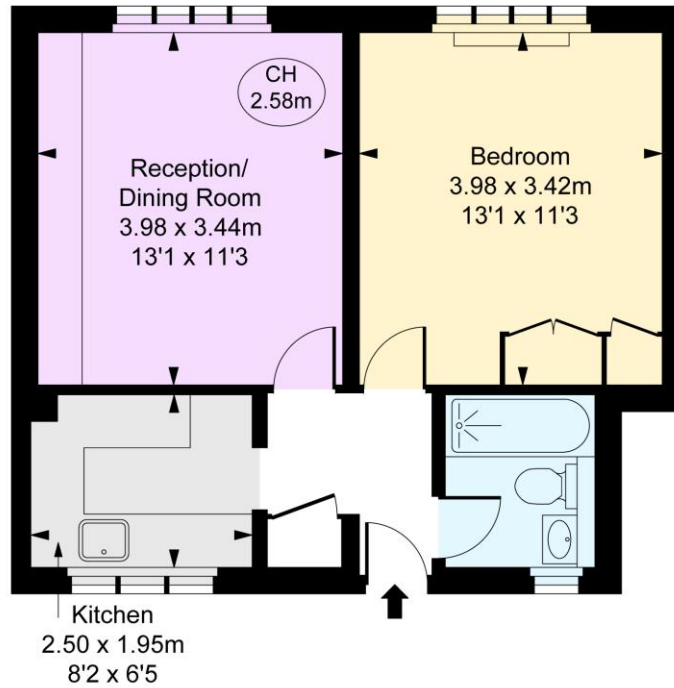

Ground Floor

This plan is not to scale. It is for guidance and not for valuation purposes.
All measurements and areas are approximate only, and have been prepared in accordance with the current edition of the RICS Code of Measuring Practice.
© Fulham Performance

Chesterton Global Ltd trading as Chestertons for themselves and for the vendor of this property whose agents they are, give notice that (i) these particulars do not constitute any part of an offer or contract, (ii) all statements contained within these particulars are made without responsibility on the part of Chestertons or the vendor, (iii) whilst made in good faith, none of the statements contained within these particulars are to be relied upon as a statement or representation of fact, (iv) any intending purchasers must satisfy themselves by inspection or otherwise as to the correctness of each of the statements contained within these particulars, (v) the vendor does not make or give either Chestertons or any person in their employment any authority to make or give representation or warranty whatsoever in relation to this property. Wide angle lenses may be used. ©Copyright Chestertons | Chesterton Global Ltd | Registered Office 40 Connaught Street, Hyde Park, London W2 2AB Registered Company Number 05334580.



This paper is
100% recyclable