



Winchester Street
London, SW1V

CHESTERTONS





Steeped in charm and period details, this bright and spacious apartment is situated within a handsome stucco fronted building on the highly sought-after Pimlico grid. The property offers a well-proportioned layout, featuring a reception room with dining area, modern kitchen, large double bedroom, and a well-appointed bathroom. Two private terraces, one accessible from the reception room and the other from the bedroom, provide idyllic outdoor space, perfect for unwinding or entertaining. High ceilings throughout enhance the feeling of grandeur, while additional benefits include share of freehold and the convenience of no onward chain.

Winchester Street allows for easy access for the shops, cafes and restaurants of Pimlico, Belgravia and Chelsea and the nearest transport links can be found at Pimlico and Victoria stations.

- Charming period conversion in a handsome stucco fronted building
- Bright and spacious with a well-proportioned layout
- Two private terraces: perfect for entertaining or relaxation
- High ceilings throughout
- Share of freehold
- No onward chain

Asking Price £635,000

Energy Efficiency Rating		Current	Potential
90-100	A	83	83
81-90	B		
71-80	C		
61-70	D		
51-60	E		
41-50	F		
31-40	G		
1-30			

Not energy efficient - higher running costs

England, Scotland & Wales EU Directive 2002/91/EC

Tenure: Leasehold – 999 years from 24 June 1996 plus Share of Freehold

Service Charge: £tbc

Ground Rent: Peppercorn

Local Authority: City of Westminster

Council Tax Band: E

Chestertons Westminster & Pimlico Sales

105 Wilton Road

London

SW1V 1DZ

westminster@chestertons.co.uk

020 3040 8201

chestertons.co.uk

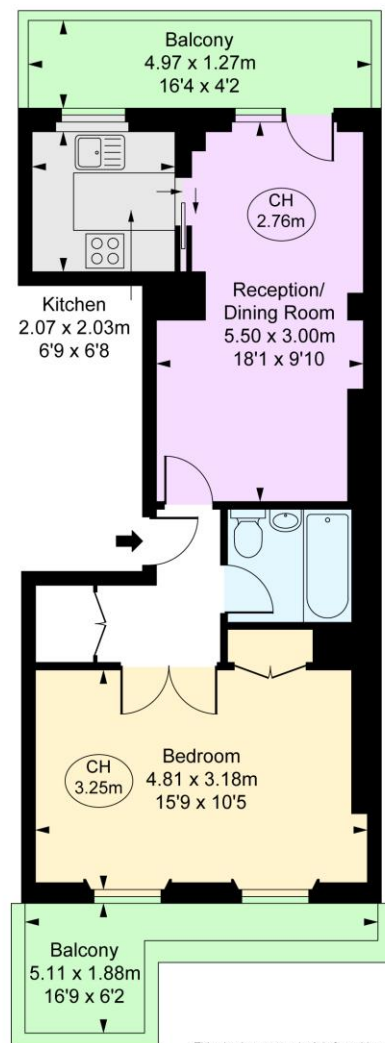

Winchester Street, SW1V

Approximate Gross Internal Area
44.34 sq m / 477 sq ft

(CH = Ceiling Heights)



This plan is not to scale. It is for guidance and not for valuation purposes.
All measurements and areas are approximate only, and have been prepared in accordance with the current edition of the RICS Code of Measuring Practice.
© Fulham Performance

Chesterton Global Ltd trading as Chestertons for themselves and for the vendor of this property whose agents they are, give notice that (i) these particulars do not constitute any part of an offer or contract, (ii) all statements contained within these particulars are made without responsibility on the part of Chestertons or the vendor, (iii) whilst made in good faith, none of the statements contained within these particulars are to be relied upon as a statement or representation of fact, (iv) any intending purchasers must satisfy themselves by inspection or otherwise as to the correctness of each of the statements contained within these particulars, (v) the vendor does not make or give either Chestertons or any person in their employment any authority to make or give representation or warranty whatsoever in relation to this property. Wide angle lenses may be used. ©Copyright Chestertons | Chesterton Global Ltd | Registered Office 40 Connaught Street, Hyde Park, London W2 2AB Registered Company Number 05334580.



This paper is
100% recyclable