



# Brick Apartments

7d Woodfield Road, W9

Asking Price £625,000

A beautifully presented one bedroom apartment, situated at the top of the block, spanning over 550 sqft with thoughtful finishes throughout. The property features a bright, south-facing living area with floor-to-ceiling windows that open onto a private terrace running the full width of the apartment.

The open-plan kitchen is equipped with high-end Miele appliances and sleek finishes. The spacious double bedroom offers ample built-in storage, while the contemporary bathroom has been tastefully designed with high end fixtures and fittings.

There is access to a large communal roof terrace, offering stunning panoramic views across the city. The property further benefits from concierge and a gated community. Conveniently located close to Westbourne Park station, the apartment is ideally positioned for easy access to transport links and local amenities.

**CHESTERTONS**



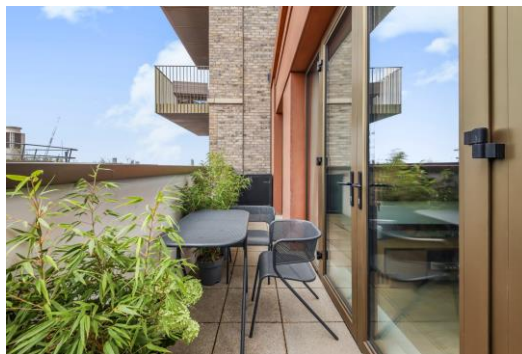

# Brick Apartments

7d Woodfield Road, W9

- Over 550 sqft
- Concierge
- gated
- City views
- South facing terrace
- Miele appliances





**Tenure:** Leasehold 992 years 10 months

**Service Charge:** £2961.24

**Ground Rent:** £0

**Local Authority:** City of Westminster

**Council Tax Band:** G

Score	Energy rating	Current	Potential
92+	A		
81-91	B	84 B	84 B
69-80	C		
55-68	D		
39-54	E		
21-38	F		
1-20	G		

### *Chestertons Little Venice Sales*

26 Clifton Road

Maida Vale

London

W9 1SX

[littlevenice@chestertons.co.uk](mailto:littlevenice@chestertons.co.uk)

020 7286 4632

[chestertons.co.uk](https://www.chestertons.co.uk)

# Brick Apartments, Woodfield Road, W9

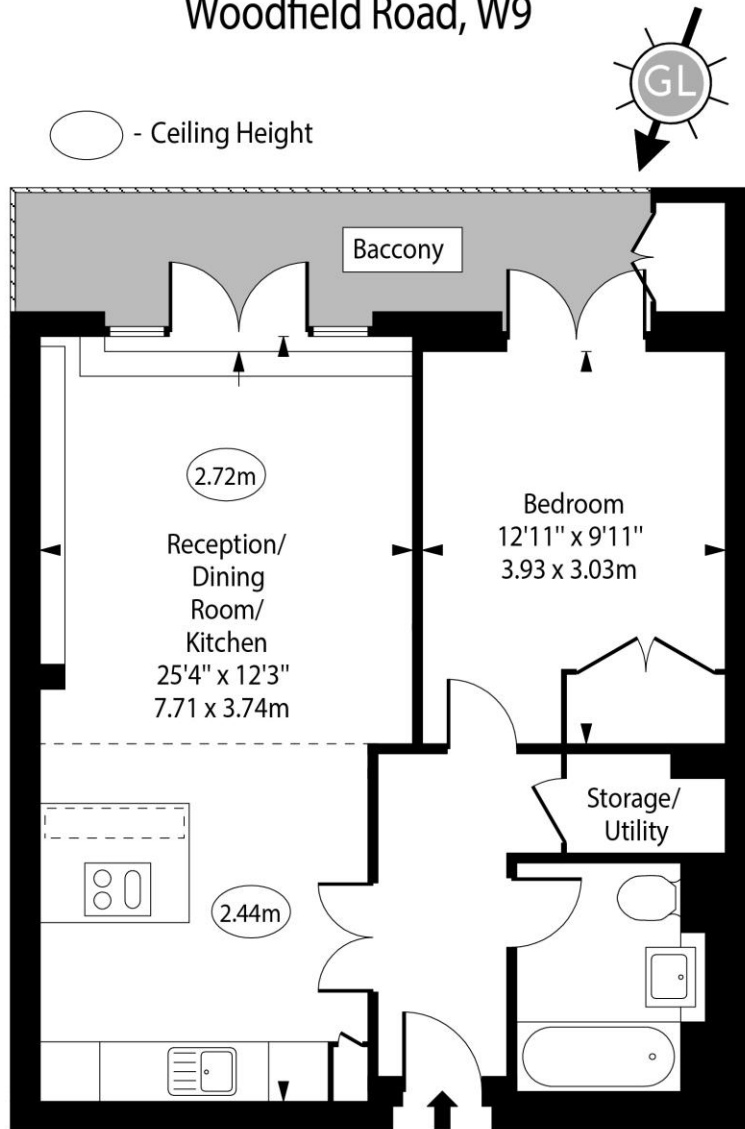

Fourth Floor

Approx Gross Internal Area      556 Sq Ft - 51.65 Sq M

Every attempt has been made to ensure the accuracy of the floor plan shown.  
However, all measurements, fixtures, fittings, and data shown are approximate interpretations and  
for illustrative purposes only.

Measured according to the RICS IPMS 2. Not To Scale.

[www.goldlens.co.uk](http://www.goldlens.co.uk)

Ref. No. 028485D

