



Blomfield Road

London, W9

Asking Price £450,000

A very bright and well-presented one bedroom flat on the second floor of a stucco fronted period conversion. This elegant flat is directly opposite the Regent's Canal and backs onto a fabulous communal garden.

Situated moments from Warwick Avenue underground station (Bakerloo line), further accommodation comprises open plan kitchen/reception room, double bedroom, bathroom.



Blomfield Road

London, W9

- A charming one bedroom spanning approx. 400 square feet.
- Benefitting from views over and access to stunning communal gardens
- Overlooking the wonderful Regents Canal.
- Positioned on central Little Venice.



Tenure: Leasehold 83 years 8 months
Service Charge: £1,140.48 pa
Ground Rent: £10 pa
Local Authority: City of Westminster
Council Tax Band: D

Energy Efficiency Rating		Current	Potential
Very energy efficient - lower running costs			
(92-)	A		
(81-91)	B		
(69-80)	C	71	80
(55-68)	D		
(39-54)	E		
(21-38)	F		
(1-20)	G		
Not energy efficient - higher running costs			
England, Scotland & Wales		EU Directive 2002/91/EC	

Chestertons Little Venice Sales

26 Clifton Road
 Maida Vale
 London
 W9 1SX
 littlevenice@chestertons.co.uk
 020 7286 4632
 chestertons.co.uk

Blomfield Road, W9

○ - Ceiling Height

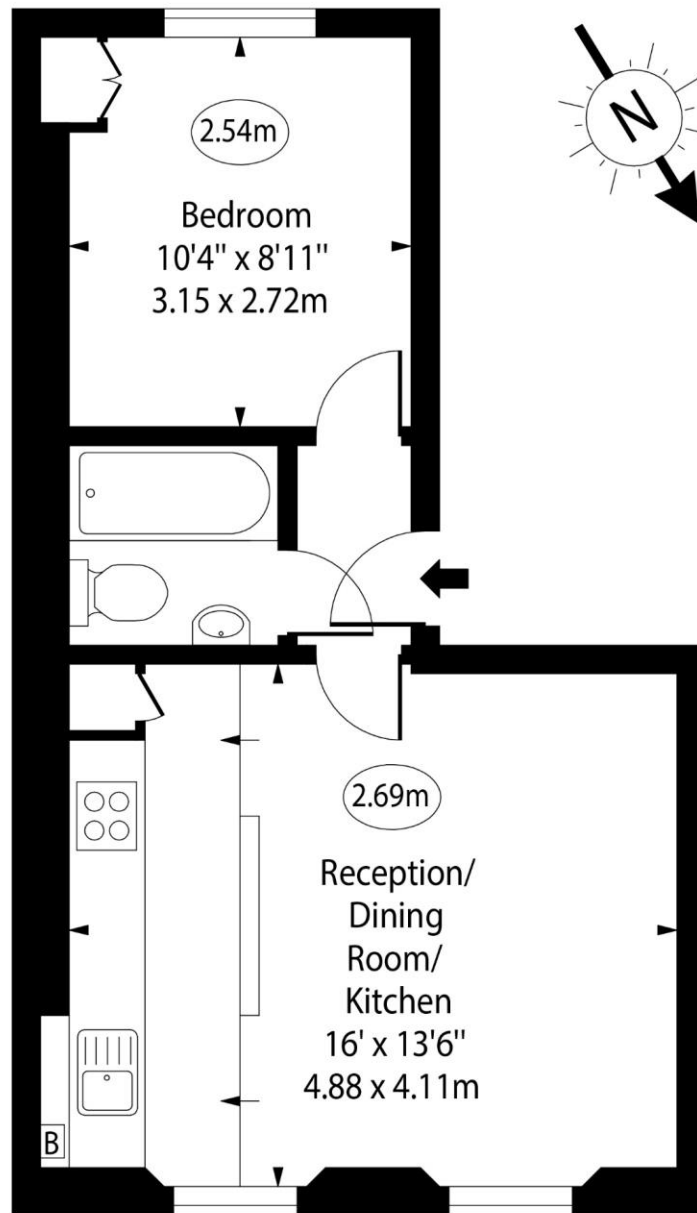

Second Floor

Approx Gross Internal Area 400 Sq Ft - 37.16 Sq M

For Illustration Purposes Only - Not To Scale

