



# Chippenhams Road

Maida Vale, W9

Asking Price £385,000

A beautifully maintained one-bedroom apartment set within a charming white stucco building. The property features a generous open-plan kitchen and living area benefitting from a bay window along with thoughtfully designed storage throughout. The kitchen has also been finished to a high standard with integrated appliances.

The large bedroom is positioned at the rear of the apartment and includes an en-suite three-piece bathroom, offering direct access to a private garden.





# Chippenham Road

Maida Vale, W9

- Spacious garden flat
- Modern finishes throughout
- White stucco frontage
- Private garden
- Over 400sqft





---

**Tenure:** Leasehold 106 years 7 months  
**Service Charge:** £1,509 pa  
**Ground Rent:** £250 pa  
**Local Authority:** City of Westminster  
**Council Tax Band:** B

Score	Energy rating	Current	Potential
92+	A		
81-91	B		
69-80	C		
55-68	D	65 D	74 C
39-54	E		
21-38	F		
1-20	G		

---

### *Chestertons Little Venice Sales*

26 Clifton Road  
Maida Vale  
London  
W9 1SX  
littlevenice@chestertons.co.uk  
020 7286 4632  
chestertons.co.uk

Chippenham Road, W9

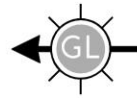

○ - Ceiling Height

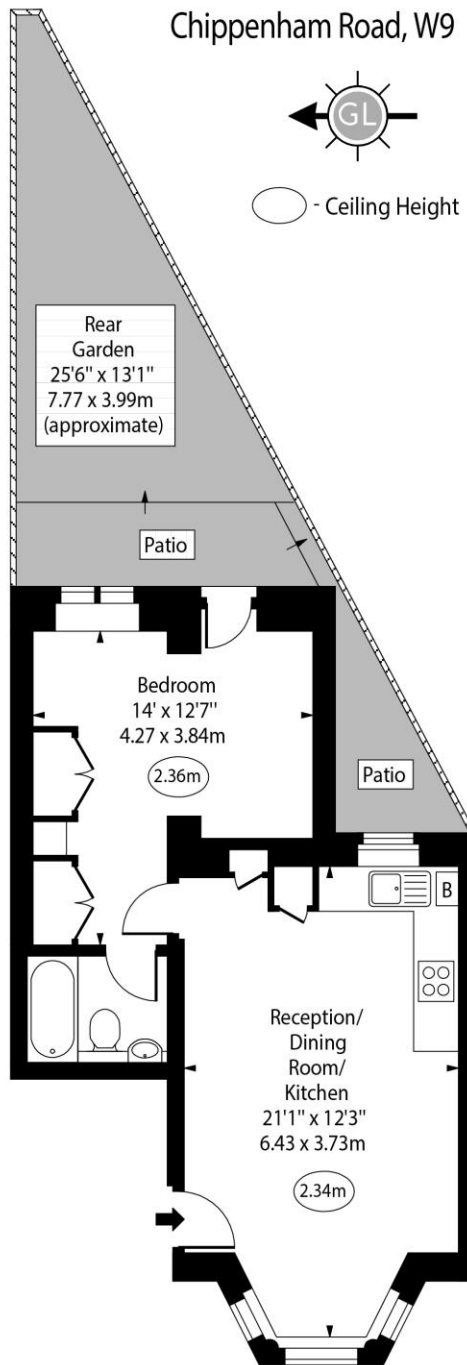

Lower Ground Floor

Approx Gross Internal Area 428 Sq Ft - 39.76 Sq M

Every attempt has been made to ensure the accuracy of the floor plan shown.  
However, all measurements, fixtures, fittings, and data shown are approximate interpretations and  
for illustrative purposes only.

Measured according to the RICS IPMS 2. Not To Scale.

[www.goldlens.co.uk](http://www.goldlens.co.uk)

Ref. No. 027946M

