



Sutherland Avenue

Little Venice, W9

Asking Price £1,200,000

Set on Sutherland Avenue and positioned on the second floor of a red brick Victorian converted building is this stunning three bedroom lateral apartment spanning approximately 980 square feet.

Beautifully presented with views over and access to the enviable Winston Amenity communal garden, the accommodation comprises a spacious reception room overlooking the garden, a fully fitted kitchen, a spectacular master bedroom with plentiful storage and en suite bathroom, and two further bedrooms both served but a charming family bathroom.

Sutherland Avenue is situated in the heart of Little Venice, a short walk from the cafes and shops of Clifton Road and Formosa Street, with Warwick Avenue Underground Station on the Bakerloo Line nearby.



Sutherland Avenue

Little Venice, W9

- A charming three bedroom apartment positioned on 2nd floor and spanning approximately 980 square feet.
- Benefitting from a share in the freehold.
- The apartment has views over and access to the charming Winston Amenity communal gardens.
- Positioned on the ever popular Sutherland Avenue.



Tenure: Share of Freehold 959 years 6 months

Service Charge: £5,522 pa

Ground Rent: £100 rising to £300 pa

Local Authority: City of Westminster

Council Tax Band: G

Chestertons Little Venice Sales

26 Clifton Road

Maida Vale

London

W9 1SX

littlevenice@chestertons.co.uk

020 7286 4632

[chestertons.co.uk](https://www.chestertons.co.uk)

Sutherland Avenue, W9

○ - Ceiling Height

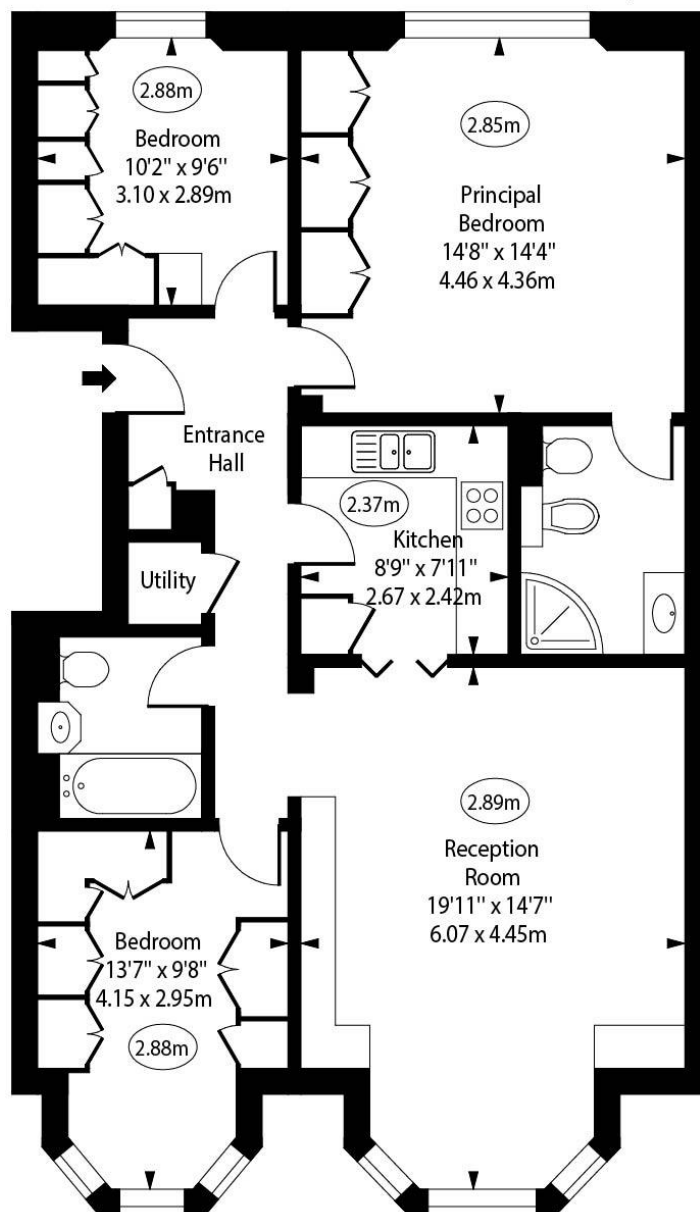

Second Floor

Approx Gross Internal Area 978 Sq Ft - 90.86 Sq M

For Illustration Purposes Only - Not To Scale

www.goldlens.co.uk

Ref. No. 027230R

