



Clifton Gardens

Maida Vale, W9

Asking Price £1,200,000

Positioned on the raised ground floor is this fabulous two bedroom apartment. Benefitting from spectacular natural light throughout and spanning approximately 642 square feet, the apartment has views over and access to the ever popular Triangle Amenity Garden.

Finished to a spectacular standard throughout, and benefitting from designated off street parking, the accommodation comprises a large reception room over looking the garden, a fully fitted kitchen positioned on the mezzanine level, master bedroom with plentiful storage, a second bedroom and family bathroom.

Clifton Gardens is located in the heart of Little Venice. Being less than a quarter of a mile to Both Warwick Avenue and Maida Vale underground (Bakerloo Line) and the shops, cafes and restaurants of both Little Venice, Maida Vale.



Clifton Gardens

Maida Vale, W9

- A stunning 2 bedroom apartment positioned on the raised ground floor of this stucco fronted building.
- Benefitting from designated off street parking.
- The apartment has access to the wonderful Triangle Communal Garden.
- Benefitting from a share in the freehold with exceptionally long underlying lease.



Tenure: Share of Freehold 957 years

Service Charge: £2,757.94 pa

Ground Rent: £0

Local Authority: City of Westminster

Council Tax Band: F

Chestertons Little Venice Sales

26 Clifton Road

Maida Vale

London

W9 1SX

littlevenice@chestertons.co.uk

020 7286 4632

[chestertons.co.uk](https://www.chestertons.co.uk)

Clifton Gardens, W9

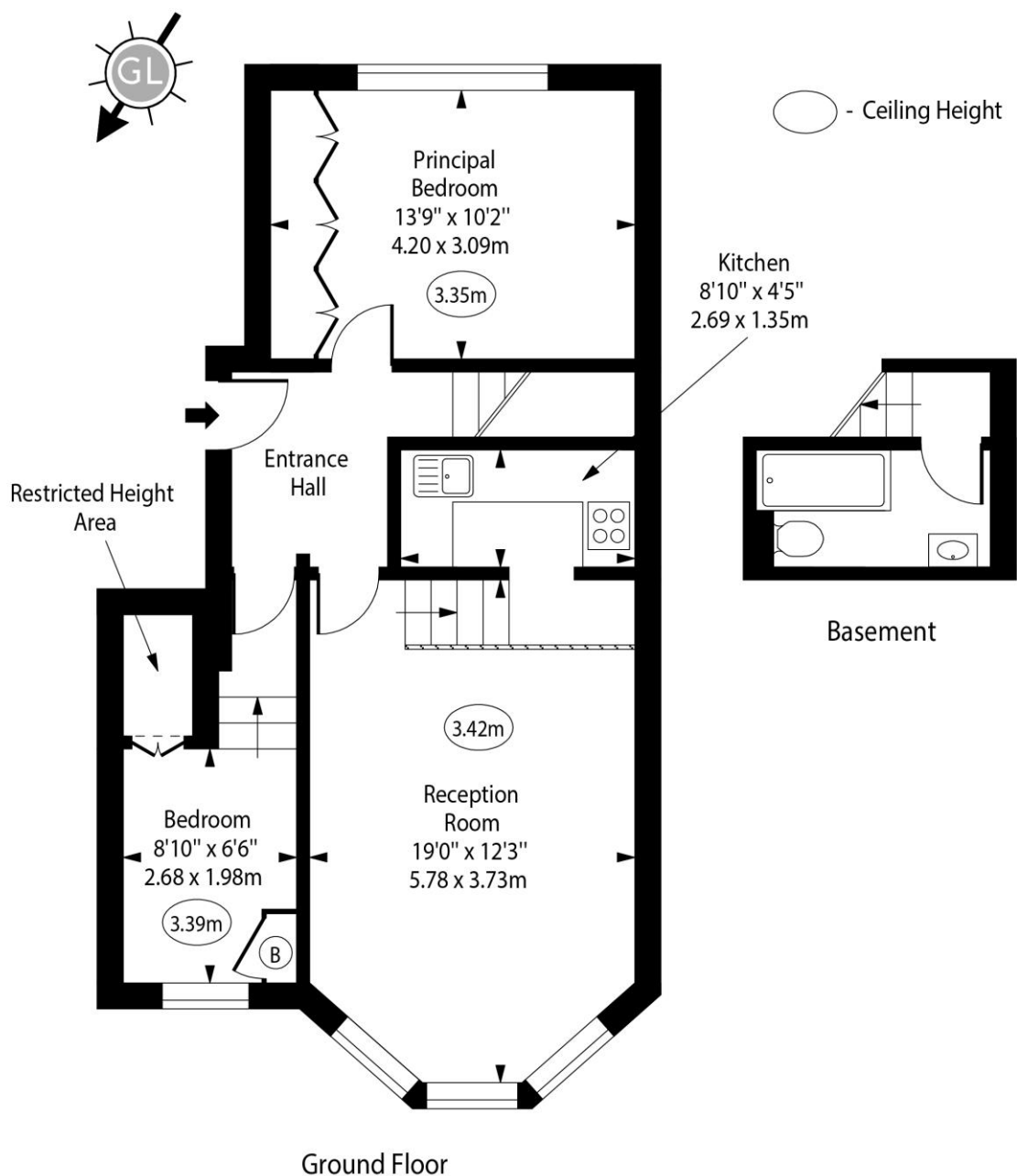

Approx Gross Internal Area 630 Sq Ft - 58.53 Sq M

Approx. Floor Area Including Restricted Heights 642 Sq Ft - 59.64 Sq M

For Illustration Purposes Only - Not To Scale

www.goldlens.co.uk

Ref. No. 027139.1J

