



# Edinburgh House

Maida Vale, W9

Offers in excess of £380,000

A nicely refurbished modern two bedroom maisonette situated on the sixteenth and seventeenth floor with lift access, and therefore benefitting from the most spectacular far reaching views.

The accommodation comprises a separate modern fully fitted kitchen, spacious reception room, two large double bedrooms with good storage and a wonderful balcony.

Ideally situated moments from all the amenities of Maida Vale and close to Maida Vale underground and Paddington recreation ground.





# Edinburgh House

## Maida Vale, W9

- A stunning apartment offer CHAIN FREE and positioned on the 16th and 17th floor.
- Benefitting from a spectacular balcony with far reaching views.
- Spanning approximately 750 square feet.
- The apartment comes with a long leasehold.





**Tenure:** Leasehold  
**Service Charge:** £3,444.61 pa  
**Ground Rent:** £10 pa  
**Local Authority:** City of Westminster  
**Council Tax Band:** C

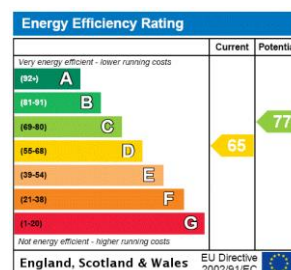

### *Chestertons Little Venice Sales*

26 Clifton Road  
Maida Vale  
London  
W9 1SX  
littlevenice@chestertons.co.uk  
020 7286 4632  
chestertons.co.uk

# Edinburgh House, Maida Vale, W9

○ - Ceiling Height

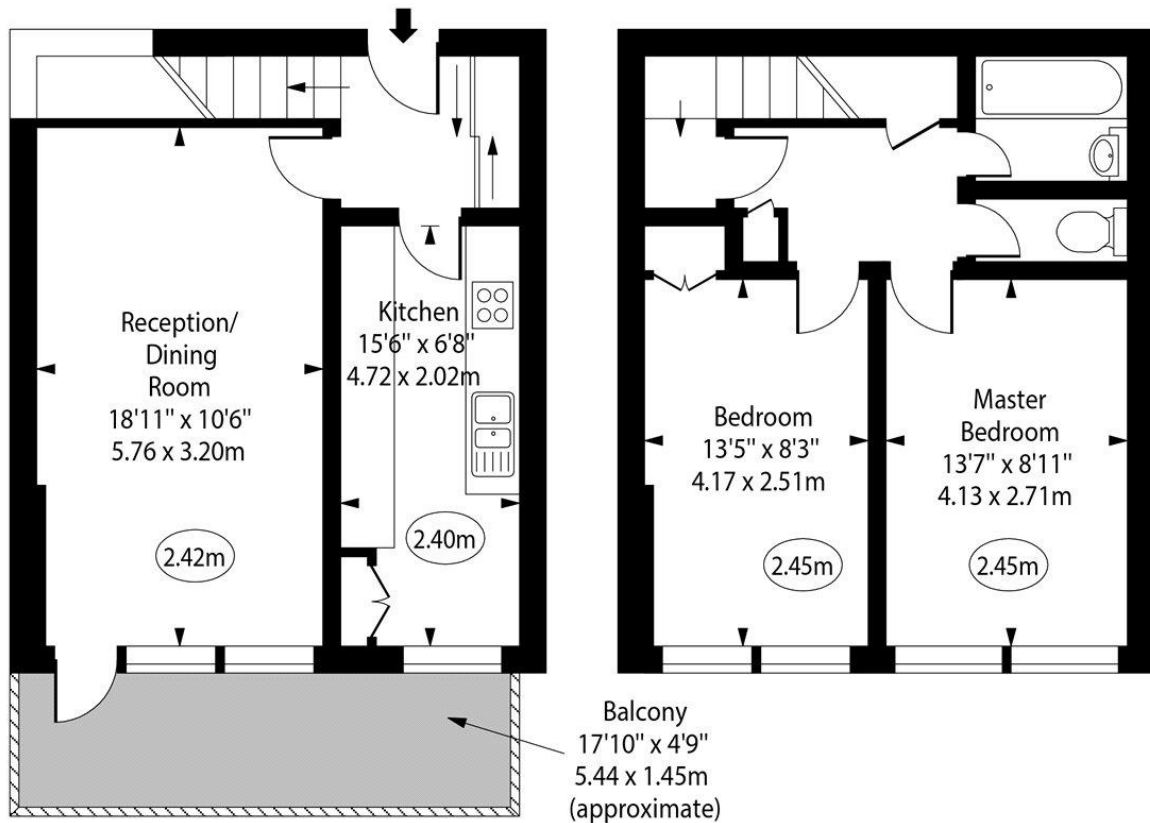
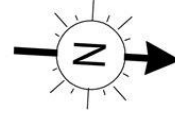

Sixteenth Floor

Seventeenth Floor

Approx Gross Internal Area

750 Sq Ft - 69.68 Sq M

For Illustration Purposes Only - Not To Scale

[www.goldlens.co.uk](http://www.goldlens.co.uk)

Ref. No. 016759R

