



Finch Lodge

Admiral Walk, W9

Asking Price £650,000

A one bedroom, first floor apartment with a south facing balcony overlooking the Regents Canal, set within a private gated development in Maida Vale.

The apartment comprises a semi-open plan kitchen and reception room, separate utility and WC, balcony, double bedroom with built-in storage, bathroom and underground car parking.

Finch Lodge is part of the Carlton Gate development and well located for the amenities of both Notting Hill and Maida Vale. Sole agent.



Finch Lodge

Admiral Walk, W9

- One Double Bedroom
- First Floor
- Balcony
- Views of Regents Canal
- 0.5 Miles from Westbourne Park Underground



Tenure: Leasehold 89 years remaining.

Service Charge: £10,748pa including a £2,232pa contribution to the reserve fund.

Ground Rent: £200pa

Local Authority: Westminster

Council Tax Band: E

Energy Efficiency Rating		Current	Potential
Very energy efficient - lower running costs	A		
(92-)	A		
(81-91)	B		
(69-80)	C	79	81
(55-68)	D		
(39-54)	E		
(21-38)	F		
(1-20)	G		
Not energy efficient - higher running costs			
England, Scotland & Wales		EU Directive 2002/91/EC	

Chestertons Little Venice Sales

26 Clifton Road

Maida Vale

London

W9 1SX

littlevenice@chestertons.co.uk

020 7286 4632

chestertons.co.uk

Finch Lodge, Admiral Walk, W9

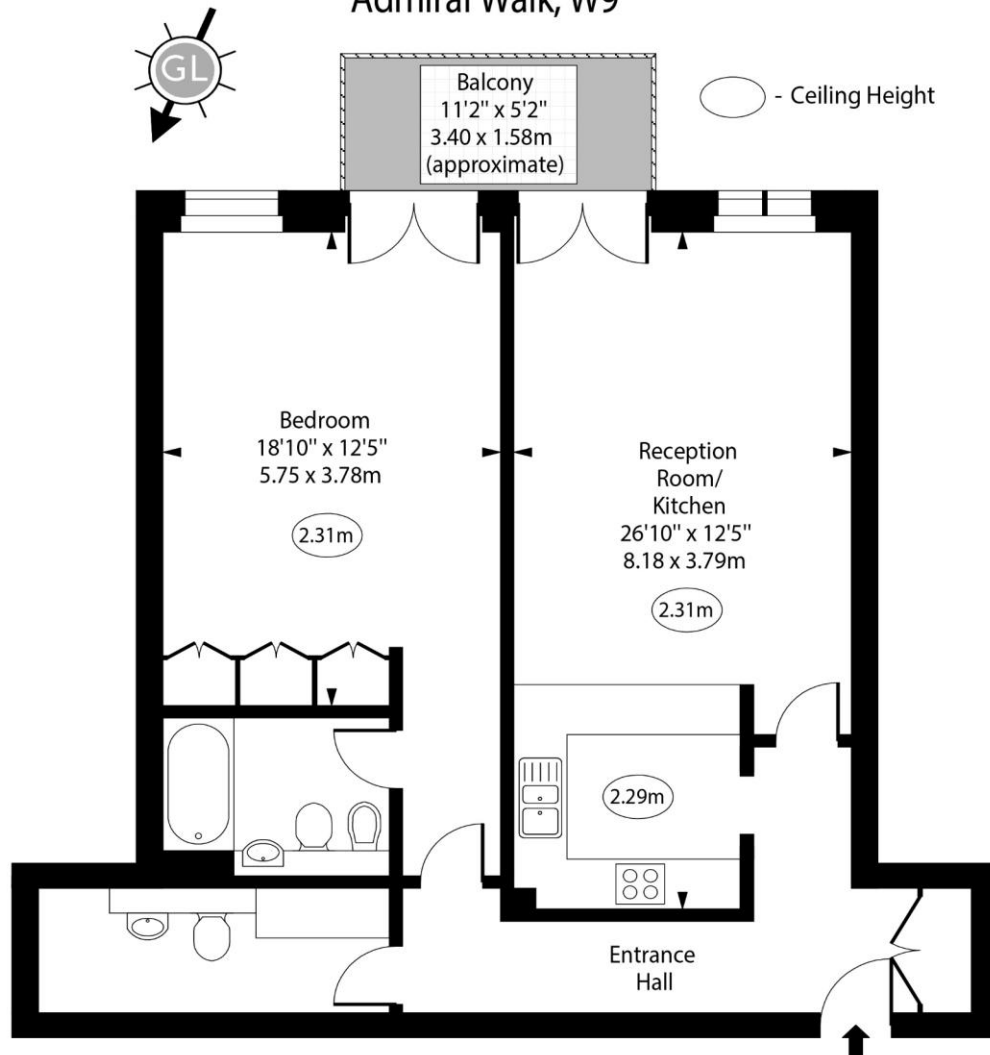

First Floor

Approx Gross Internal Area 835 Sq Ft - 77.58 Sq M

For Illustration Purposes Only - Not To Scale

www.goldlens.co.uk

Ref. No. 025583.1R

