



Randolph Crescent

London, W9

Asking Price £1,750,000

This immaculate two-bedroom, raised ground floor period conversion (751 square feet) is located on a prime street in Little Venice. Designed to the highest standards with meticulous attention to detail, this elegant west-facing apartment offers modern, sophisticated interiors, state-of-the-art appliances, and direct access to the highly sought-after crescent communal gardens via a private balcony.

The accommodation includes two bedrooms, two bathrooms (one en-suite), and an open-plan kitchen/living room that leads to a private terrace. The property features high ceilings, period details, and a bright living space that benefits from direct sunlight. Flooring includes Harwoods Herringbone wood and deep plush bamboo-woven carpeting. The kitchen is equipped with a Rangemaster Elite stove, a Miele integrated dishwasher and fridge-freezer, and a Caso wine cooler, all set against brushed stainless steel under-counters. Both the en-suite and guest bathrooms feature underfloor heating and are tiled in Italian porcelain gloss. The living room is adorned with an Italian Murano glass chandelier, mural wallpaper by Andrew Martin, and a fully integrated Sonos sound system.

This stunning period property is ideally situated in the heart of Little Venice, close to local amenities including Warwick Avenue and Maida Vale stations (Bakerloo Line), the canals, waterside cafes, and the eclectic shops along Clifton Road.



Randolph Crescent

London, W9

- A spectacular two bedroom apartment positioned on the raised ground floor and finished to an extremely high standard.
- Benefitting from direct access, via a private balcony, on to the ever popular Crescent Amenity communal garden.
- The apartment comes with a share in the freehold and exceptionally long underlying lease.
- Positioned on one of the areas premier crescents in central Little Venice.



Tenure: Share of Freehold 955 years 10 months

Service Charge: £3129

Ground Rent: £0 Peppercorn

Local Authority: City Of Westminster

Council Tax Band: F

Chestertons Little Venice Sales

26 Clifton Road

Maida Vale

London

W9 1SX

littlevenice@chestertons.co.uk

020 7286 4632

chestertons.co.uk

Randolph Crescent, W9

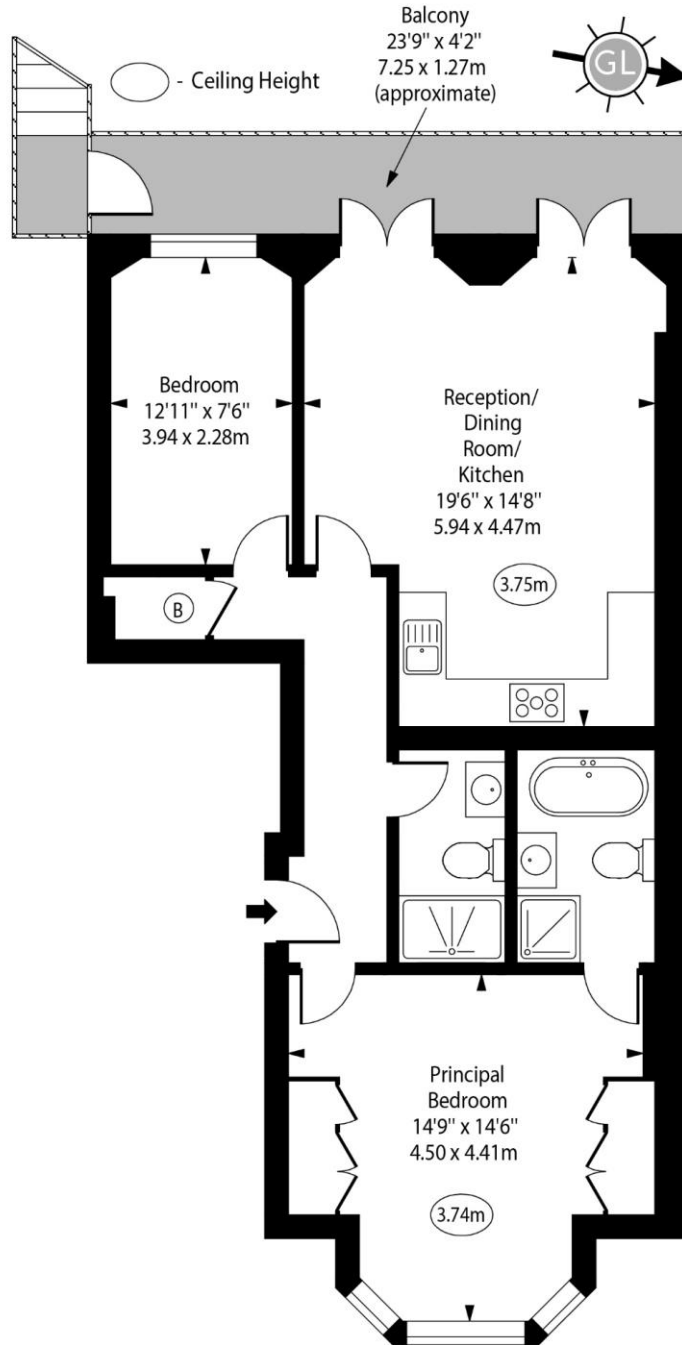

Ground Floor

Approx Gross Internal Area 750 Sq Ft - 69.68 Sq M

For Illustration Purposes Only - Not To Scale
www.goldlens.co.uk
Ref. No. 024196J

