



Clifton Court

Northwick Terrace, NW8

Asking Price £1,000,000

A wonderfully bright and spacious flat on the top floor of Clifton Court with great views over the communal gardens. The flat is in immaculate condition with wooden flooring throughout with a newly done bathroom and kitchen. The flat comprises of a sitting room, kitchen, 2 double bedrooms and a large family bathroom.

Clifton Court is very well located to benefit from the local amenities of Little Venice. These include the shops/cafes of Clifton Road and Warwick Avenue underground (Bakerloo). Paddington Station (Heathrow Express & soon to be Crossrail) is in close proximity.



Clifton Court

Northwick Terrace, NW8

- Two Bedrooms
- Recently renovated
- Long lease
- Communal Garden



Tenure: Leasehold 976 years 5 months
Service Charge: £5,096.42 pa
Ground Rent: Peppercorn
Local Authority: City of Westminster
Council Tax Band: F

Energy Efficiency Rating		
	Current	Potential
Very energy efficient - lower running costs		
A (91-100)		
B (81-90)		
C (69-80)		80
D (55-68)		
E (39-54)	47	
F (21-38)		
G (1-20)		
Not energy efficient - higher running costs		
England, Scotland & Wales		EU Directive 2002/91/EC

Chestertons Little Venice Sales

26 Clifton Road
Maida Vale
London
W9 1SX
littlevenice@chestertons.co.uk
020 7286 4632
chestertons.co.uk

Clifton Court, Northwick Terrace, NW8

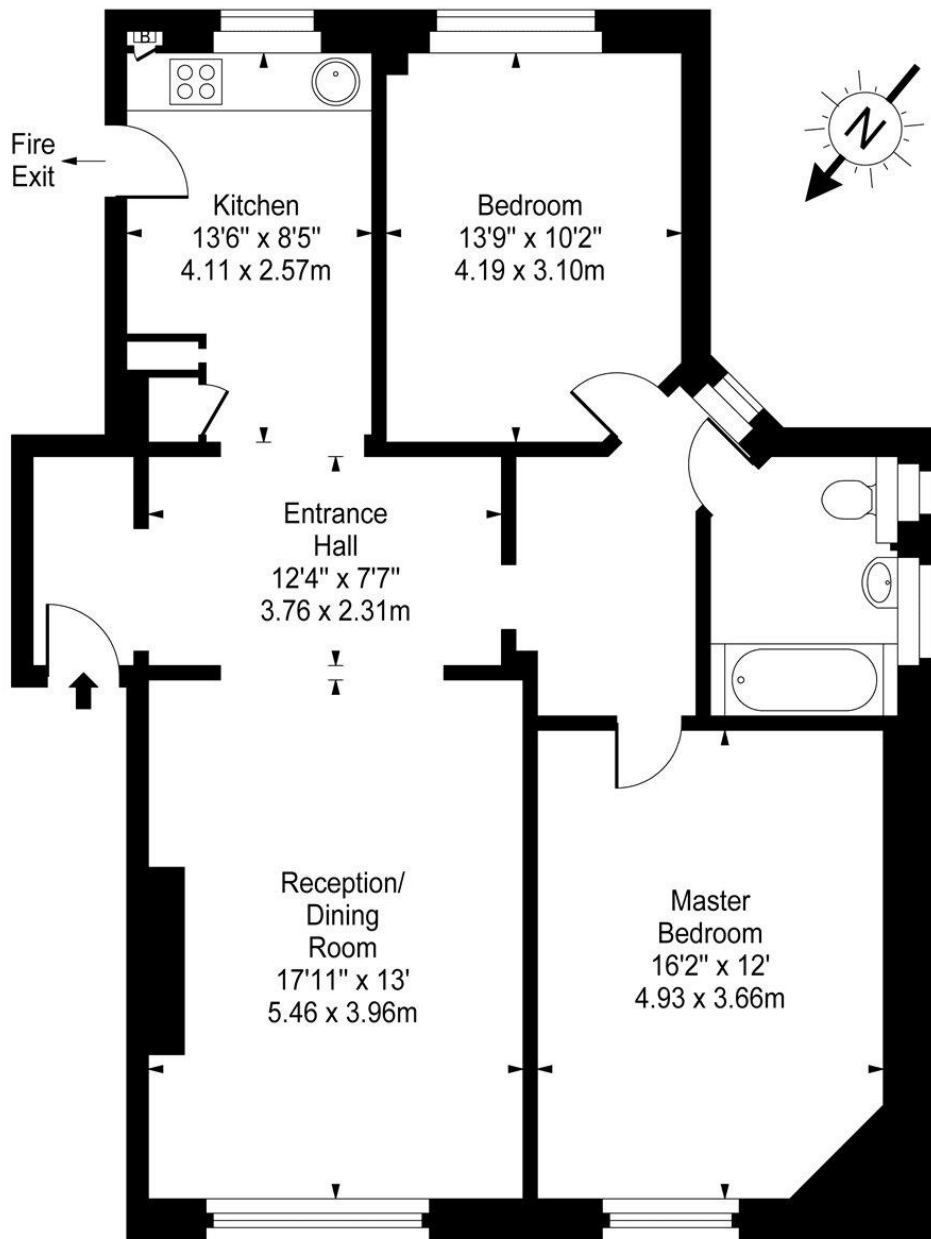

Third Floor

Approx Gross Internal Area **956 Sq Ft - 88.81 Sq M**

For Illustration Purposes Only - Not To Scale

www.goldlens.co.uk

Ref. No. 005643K

