



Ovington Court

A bright and well-proportioned 1st floor apartment in good order throughout and boasts a 25' double reception room, 2 bedrooms, bathroom and guest cloakroom. The flat is situated on the eastern side of the building and benefits from a portage and a lift.

Ovington Court is exceptionally well located on the corner of Ovington Gardens and Brompton Road therefore being close to all the shopping and transport facilities the area has to offer, including Harrods. South Kensington is also close by.

CHESTERTONS

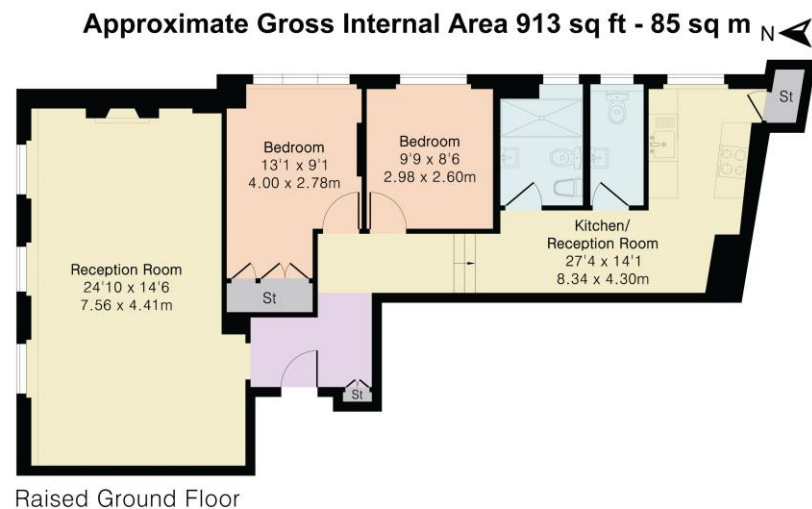

Tenure: Leasehold : Expiring 27/05/2075 i.e. approximately 49 years 11 months

Service Charge: £25,000 per annum

Ground Rent: £50 rising to £150

Local Authority: Royal Borough of Kensington & Chelsea

Council Tax Band: G

Asking Price £1,300,000

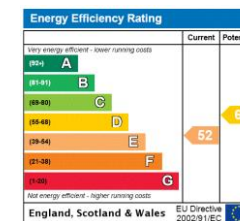

Chestertons Knightsbridge & Belgravia Sales

31 Lowndes St
Knightsbridge
London
SW1X 9HX
knightsbridge@chestertons.co.uk
020 7235 8090

chestertons.co.uk

Chesterton UK Services Limited trading as Chestertons for themselves and for the vendor of this property whose agents they are, give notice that (i) these particulars do not constitute any part of an offer or contract, (ii) all statements contained within these particulars are made without responsibility on the part of Chestertons or the vendor, (iii) whilst made in good faith, none of the statements contained within these particulars are to be relied upon as a statement or representation of fact, (iv) any intending purchasers must satisfy themselves by inspection or otherwise as to the correctness of each of the statements contained within these particulars, (v) the vendor does not make or give either Chestertons or any person in their employment any authority to make or give representation or warranty whatsoever in relation to this property. Wide angle lenses may be used. ©Copyright Chestertons | Chesterton UK Services Limited | Registered Office 40 Connaught Street, Hyde Park, London W2 2AB Registered Company Number 05334580.



This paper is
100% recyclable