



Chesham Street
Belgravia, SW1X

CHESTERTONS





A beautifully presented top floor flat situated within an elegant period building in one of London's most prestigious postcodes. This exceptional property boasts charming, vaulted ceilings throughout, enhancing the sense of space and character.

Meticulously refurbished by the current owner, the apartment seamlessly blends modern finishes with classic architectural features. The main flat comprises a generously proportioned double bedroom, a stylishly appointed reception room, and a bespoke kitchen with high-quality fittings. The interiors have been thoughtfully designed to maximise natural light and functionality, creating a warm and welcoming atmosphere ideal for both relaxing and entertaining.

A particularly rare and desirable feature of this property is the separate studio space, accessed via the half-landing of the communal staircase. This self-contained room offers tremendous versatility - currently set up as a second bedroom with en suite bathroom, but equally ideal as a home office, art studio, or additional storage - and is a highly attractive asset in central London living.

Chesham Street is extremely well located being close to both Sloane Square and Hyde Park with the excellent shopping and transport facilities the area has to offer.

- Beautifully presented
- Two bed
- Separate studio from communal hall
- Top floor
- Vaulted ceilings

Asking Price £1,295,000

Energy Efficiency Rating		
Very energy efficient - lower running costs	Current	Potential
90-100 A		
81-89 B		
72-80 C		
63-71 D		
55-62 E		
47-54 F		
39-46 G		
Not energy efficient - higher running costs		
England, Scotland & Wales EU Directive 2002/91/EC		

Tenure: Share of Freehold (962 years remaining)
Service Charge: £3,110 per annum
Ground Rent: Peppercorn
Local Authority: City of Westminster
Council Tax Band: F

Chestertons Knightsbridge & Belgravia Sales

31 Lowndes St
 Knightsbridge
 London
 SW1X 9HX

knightbridge@chestertons.co.uk
 020 7235 8090

Chesham Street, SW1X

Approximate gross internal area
67.45 sq m / 726 sq ft

Key :
CH - Ceiling Height

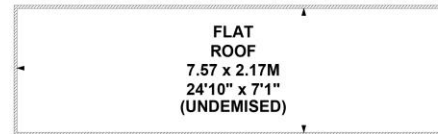

Not to scale, for guidance only and must not be relied upon as a statement of fact.
All measurements and areas are approximate only

Chesterton UK Services Limited trading as Chestertons for themselves and for the vendor of this property whose agents they are, give notice that (i) these particulars do not constitute any part of an offer or contract, (ii) all statements contained within these particulars are made without responsibility on the part of Chestertons or the vendor, (iii) whilst made in good faith, none of the statements contained within these particulars are to be relied upon as a statement or representation of fact, (iv) any intending purchasers must satisfy themselves by inspection or otherwise as to the correctness of each of the statements contained within these particulars, (v) the vendor does not make or give either Chestertons or any person in their employment any authority to make or give representation or warranty whatsoever in relation to this property. Wide angle lenses may be used. ©Copyright Chestertons | Chesterton UK Services Limited | Registered Office 40 Connaught Street, Hyde Park, London W2 2AB Registered Company Number 05334580.



This paper is
100% recyclable