



Lizmans Terrace  
Earls Court Road, W8









A stylish and substantial two double bedroom apartment, which was originally arranged as a three bedroom property. Located on the garden level of this desirable period building. Boasting its own private entrance, rear garden and side access ideal for bike enthusiasts.

The accommodation comprises an inviting entrance hall, guest cloakroom, master bedroom with en-suite bathroom & walk-in wardrobe, second double bedroom with en-suite shower room, separate kitchen, large reception which has direct access to the charming rear garden. Previously arranged as a three bedroom apartment there is an abundance of storage throughout the property.

Lizmans Terrace is ideally located to the local amenities of Stratford Village, while Kensington High Street, Earls Court and Gloucester Road with their excellent restaurant, transport and leisure facilities are within close proximity. The green open spaces of Holland Park & Kensington Gardens are also nearby.

- Two Double Bedrooms, One Bathroom, One Shower Room
- Separate Kitchen, Reception, Guest Cloakroom
- Private Garden, Own Private Entrance
- Separate Side Access Into Garden

Offers in excess of  
£950,000

| Score | Energy rating | Current | Potential |
|-------|---------------|---------|-----------|
| 92+   | A             |         |           |
| 81-91 | B             |         |           |
| 69-80 | C             |         |           |
| 55-68 | D             | 67 D    | 80 C      |
| 39-54 | E             |         |           |
| 21-38 | F             |         |           |
| 1-20  | G             |         |           |

**Tenure:** Leasehold 100 years remaining

**Service Charge:** £1,800 p.a

**Ground Rent:** £200 p.a

**Local Authority:** Kensington and Chelsea

**Council Tax Band:** F

**Chestertons Kensington Sales**

116 Kensington High Street

London

W8 7RW

kensington@chestertons.co.uk

020 7937 7244

chestertons.co.uk

## Lizmans Terrace, W8

Approx. Gross Internal Area  
89.5 sq m / 963 sq ft

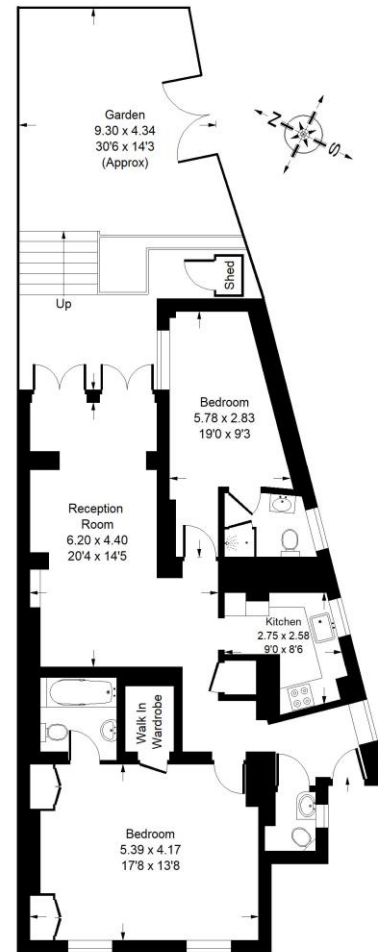

Lower Ground Floor

Whilst every attempt has been made to ensure the accuracy of the floor plan, measurements are approximate and not to scale.  
No guarantee is given on the total square footage of the property quoted on the plan. Figures given are for guidance.  
Plan is for illustration purposes only, not to be used for valuations.

Chesterton UK Services Limited trading as Chestertons for themselves and for the vendor of this property whose agents they are, give notice that (i) these particulars do not constitute any part of an offer or contract, (ii) all statements contained within these particulars are made without responsibility on the part of Chestertons or the vendor, (iii) whilst made in good faith, none of the statements contained within these particulars are to be relied upon as a statement or representation of fact, (iv) any intending purchasers must satisfy themselves by inspection or otherwise as to the correctness of each of the statements contained within these particulars, (v) the vendor does not make or give either Chestertons or any person in their employment any authority to make or give representation or warranty whatsoever in relation to this property. Wide angle lenses may be used. ©Copyright Chestertons | Chesterton UK Services Limited | Registered Office 40 Connaught Street, Hyde Park, London W2 2AB Registered Company Number 05334580.



This paper is  
100% recyclable