

Westbourne Court

Orsett Terrace, W2

Asking Price £600,000

A 2 bed-1 bath 2nd floor (with lift) apartment located close to Paddington Station, The A40 Westway and Queensway.

* Virtually staged photos

CHESTERTONS

Westbourne Court, Orsett Terrace, W2

○ - Ceiling Height

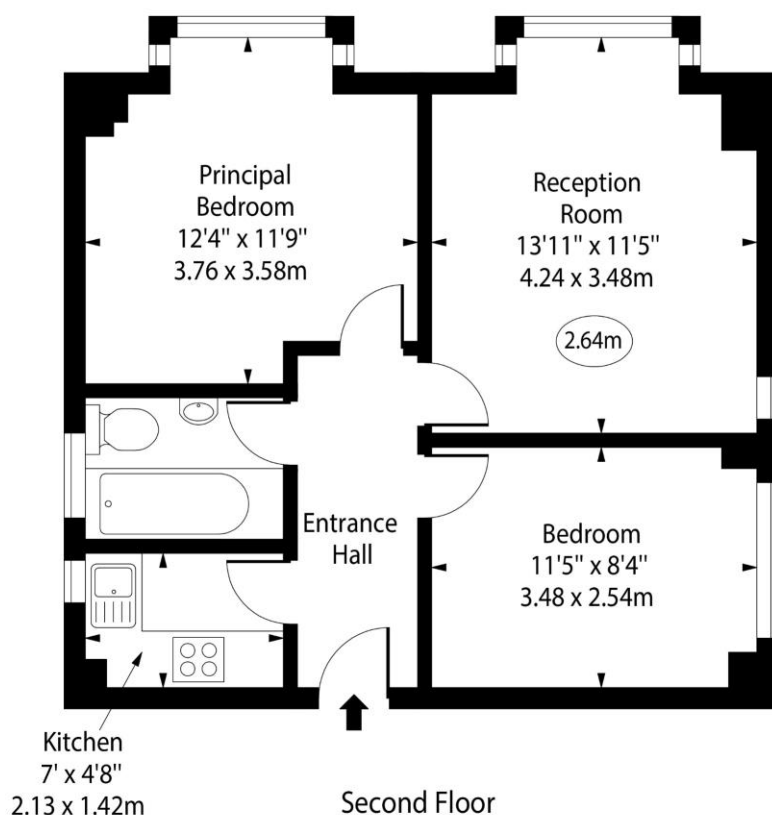

Approx Gross Internal Area 520 Sq Ft - 48.31 Sq M

For Illustration Purposes Only - Not To Scale

www.goldlens.co.uk

Ref. No. 021704AN

Tenure: Leasehold 104 years (22/12/2127)

Service Charge: £4426 including heating, hotwater and reserve fund contributions

Ground Rent: None

Local Authority: City Of Westminster

Council Tax Band: E

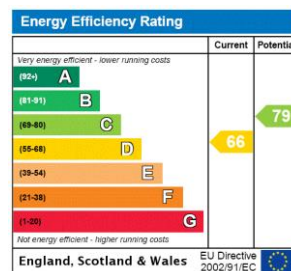

Chestertons Hyde Park & Marylebone Sales

40 Connaught Street

London

W2 2AB

hydepark@chestertons.co.uk

020 7298 5900

chestertons.co.uk

Chesterton Global Ltd trading as Chestertons for themselves and for the vendor of this property whose agents they are, give notice that (i) these particulars do not constitute any part of an offer or contract, (ii) all statements contained within these particulars are made without responsibility on the part of Chestertons or the vendor, (iii) whilst made in good faith, none of the statements contained within these particulars are to be relied upon as a statement or representation of fact, (iv) any intending purchasers must satisfy themselves by inspection or otherwise as to the correctness of each of the statements contained within these particulars, (v) the vendor does not make or give either Chestertons or any person in their employment any authority to make or give representation or warranty whatsoever in relation to this property. Wide angle lenses may be used. ©Copyright Chestertons | Chesterton Global Ltd | Registered Office 40 Connaught Street, Hyde Park, London W2 2AB Registered Company Number 05334580.



This paper is
100% recyclable