



# Gloucester Terrace

London, W2

Asking Price £500,000

Situated on the first floor of a stunning stucco-fronted period conversion. This spacious property boasts a generously sized double bedroom with built-in wardrobes, large windows that fill the home with abundant natural light.

**CHESTERTONS**

# Gloucester Terrace, W2

○ - Ceiling Height

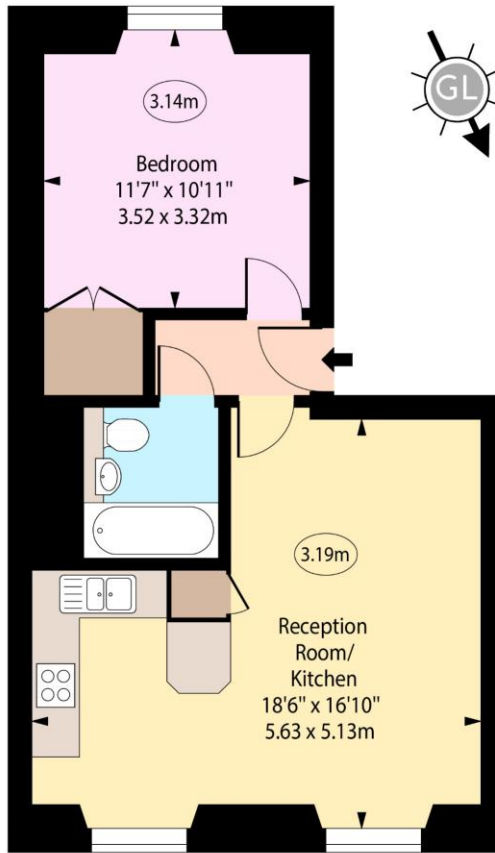

First Floor

Approx Gross Internal Area 460 Sq Ft - 42.73 Sq M

For Illustration Purposes Only - Not To Scale  
[www.goldlens.co.uk](http://www.goldlens.co.uk)  
 Ref. No. 025392.1R

**Tenure:** Leasehold 176 years 4 months (Expires 22/01/2201)

**Service Charge:** £2245.30 p.a.

**Ground Rent:** £10 p.a.

**Local Authority:** City of Westminster

**Council Tax Band:** D

Energy Efficiency Rating		Current	Potential
Very energy efficient - lower running costs			
(92+)	A		
(81-91)	B		
(69-80)	C		
(55-68)	D	57	69
(39-54)	E		
(21-38)	F		
(1-20)	G		
Not energy efficient - higher running costs			
England, Scotland & Wales		EU Directive 2002/91/EC	

## Chestertons Hyde Park & Marylebone Sales

40 Connaught Street

London

W2 2AB

hydepark@chestertons.co.uk

020 7298 5900

chestertons.co.uk

Chesterton UK Services Limited trading as Chestertons for themselves and for the vendor of this property whose agents they are, give notice that (i) these particulars do not constitute any part of an offer or contract, (ii) all statements contained within these particulars are made without responsibility on the part of Chestertons or the vendor, (iii) whilst made in good faith, none of the statements contained within these particulars are to be relied upon as a statement or representation of fact, (iv) any intending purchasers must satisfy themselves by inspection or otherwise as to the correctness of each of the statements contained within these particulars, (v) the vendor does not make or give either Chestertons or any person in their employment any authority to make or give representation or warranty whatsoever in relation to this property. Wide angle lenses may be used. ©Copyright Chestertons | Chesterton UK Services Limited | Registered Office 40 Connaught Street, Hyde Park, London W2 2AB Registered Company Number 05334580.



This paper is 100% recyclable