



# Gloucester Terrace

Bayswater, W2

Asking Price £535,000

A 4th floor 600 sqft 1 bedroom apartment located close to Paddington Station and the green open spaces of Hyde Park. The property is light and bright throughout, offered in good condition and comes with a 999 year lease and share of freehold.

**CHESTERTONS**

# Gloucester Terrace, W2

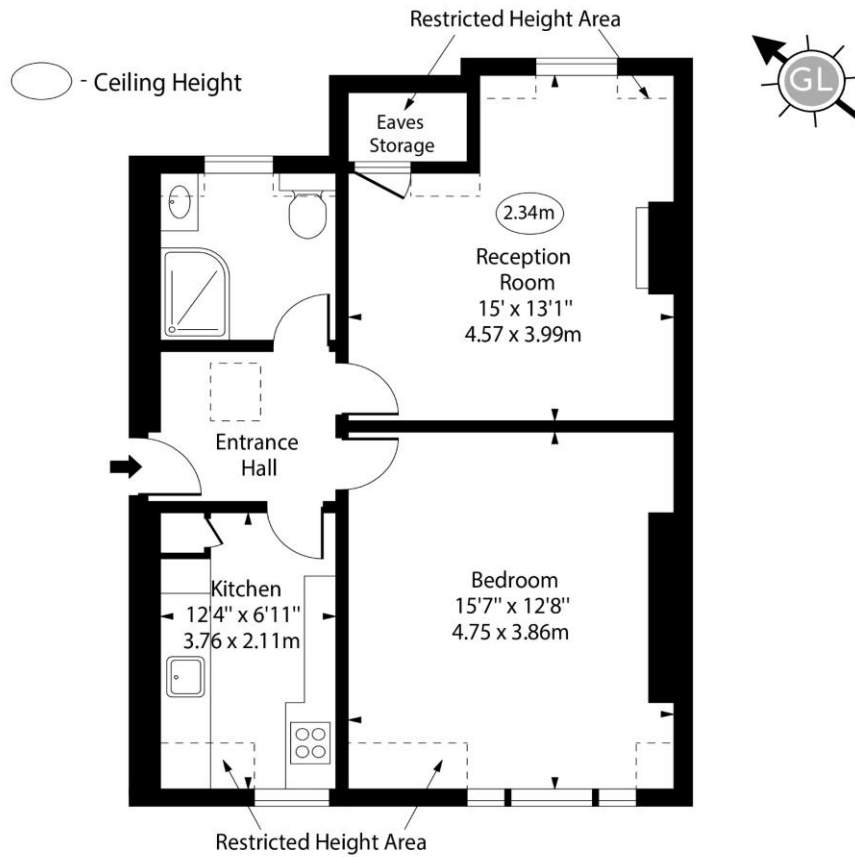

Fourth Floor

Approx Gross Internal Area 550 Sq Ft - 51.10 Sq M

Approx. Floor Area Including Restricted Heights 600 Sq Ft - 55.74 Sq M  
(Including Eaves Storage)

For Illustration Purposes Only - Not To Scale  
www.goldlens.co.uk  
Ref. No. 019392E

**Tenure:** Share of Freehold 988 years 2 months (Expires 25/12/3012)

**Service Charge:** £2900 p.a.

**Ground Rent:** £0

**Local Authority:** City Of Westminster

**Council Tax Band:** D

Energy Efficiency Rating		Current	Potential
Very energy efficient - lower running costs			
(92+)	A		
(81-91)	B		
(69-80)	C		
(55-68)	D	63	74
(38-54)	E		
(21-38)	F		
(1-20)	G		
Not energy efficient - higher running costs			
England, Scotland & Wales		EU Directive 2002/91/EC	

## Chestertons Hyde Park & Marylebone Sales

40 Connaught Street

London

W2 2AB

hydepark@chestertons.co.uk

020 7298 5900

chestertons.co.uk

Chesterton UK Services Limited trading as Chestertons for themselves and for the vendor of this property whose agents they are, give notice that (i) these particulars do not constitute any part of an offer or contract, (ii) all statements contained within these particulars are made without responsibility on the part of Chestertons or the vendor, (iii) whilst made in good faith, none of the statements contained within these particulars are to be relied upon as a statement or representation of fact, (iv) any intending purchasers must satisfy themselves by inspection or otherwise as to the correctness of each of the statements contained within these particulars, (v) the vendor does not make or give either Chestertons or any person in their employment any authority to make or give representation or warranty whatsoever in relation to this property. Wide angle lenses may be used. ©Copyright Chestertons | Chesterton UK Services Limited | Registered Office 40 Connaught Street, Hyde Park, London W2 2AB Registered Company Number 05334580.



This paper is 100% recyclable