



North End Road

Golders Green, NW11

Asking Price £665,000

A bright three bedroom, two bathroom first floor flat with the huge benefit of a private south facing terrace and off street parking for one car.

The flat is presented in excellent condition throughout and is extremely well located for the shops, amenities and transport links (Northern Line) that Golders Green provides, as well as being close to Golders Hill park & tennis courts.

CHESTERTONS



North End Road

Golders Green, NW11

- First floor apartment
- Three bedrooms & two bathrooms
- South facing terrace
- Off street parking
- 0.1 miles to The King Alfred School
- 0.2 miles to Golders Hill Park
- 0.4 miles to the Northern Line



Tenure: Leasehold with 990 years remaining.

Service Charge: Ad hoc

Ground Rent: £0

Local Authority: Barnet

Council Tax Band: D

Score	Energy rating	Current	Potential
92+	A		
81-91	B		
69-80	C	74 C	78 C
55-68	D		
39-54	E		
21-38	F		
1-20	G		

Chestertons Hampstead Sales

55-56 Hampstead High Street

Hampstead

NW3 1QH

hampstead@chestertons.co.uk

020 7794 3311

[chestertons.co.uk](https://www.chestertons.co.uk)

North End Road, Golders Green, NW11

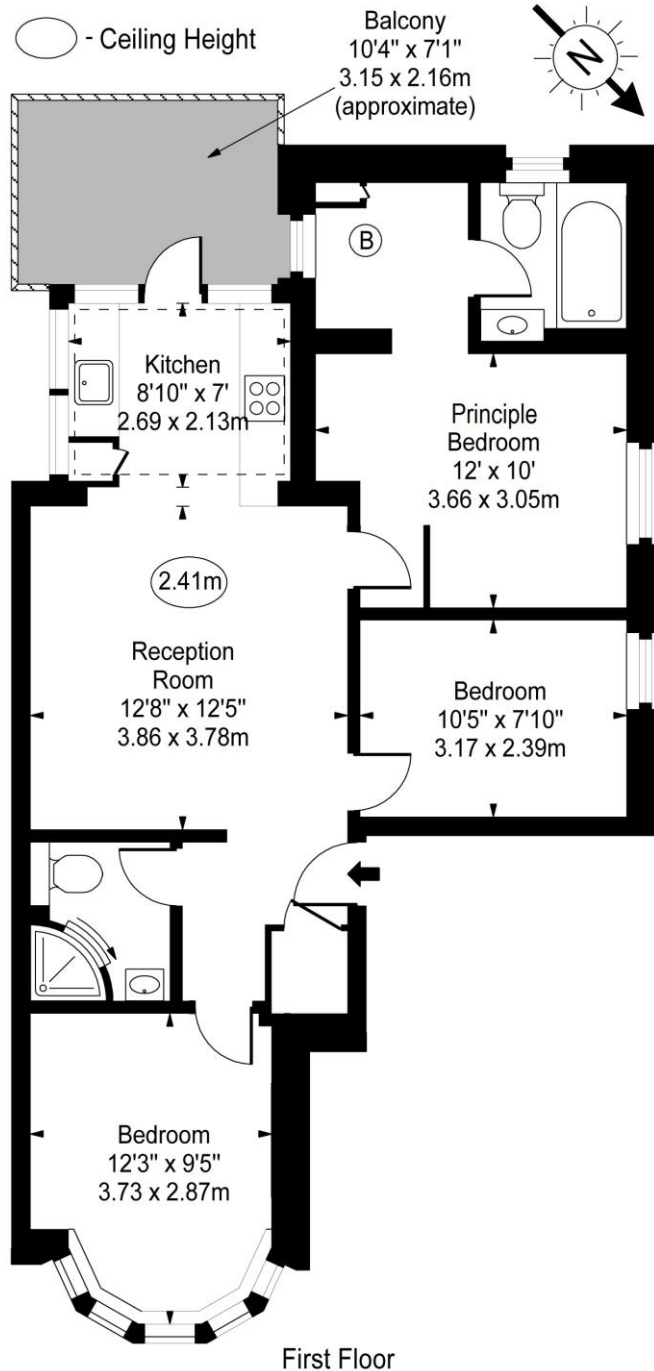

Approx Gross Internal Area **725 Sq Ft - 67.35 Sq M**

For Illustration Purposes Only - Not To Scale

www.goldlens.co.uk

Prepared for Chestertons

Ref. No. 016358K

