



Primrose Gardens

Belsize Park, NW3

Asking Price £930,000

Located on one of Belsize Park's most popular addresses, a three bedroom two bathroom garden flat (920 square feet) with direct access to a private South West facing garden.

Primrose Gardens is a lovely address in Belsize Park, existing since 1862 and named Primrose Gardens in 1939. The shops, cafes and restaurants of England's Lane are located at the bottom of Primrose Gardens. Belsize Park Underground (Northern Line) is located just 0.3 miles away. Sole agent.



Primrose Gardens

Belsize Park, NW3

- Three bedroom garden flat
- 920 square feet
- One bathroom & one shower room
- South West facing garden
- Popular address in Belsize Park
- Long lease
- 0.3 miles to Northern Line



Tenure: Leasehold 150 years 8 months remaining as of 28.10.24

Service Charge: £550 per annum including building insurance.

Ground Rent: £0

Local Authority: Camden

Council Tax Band: E

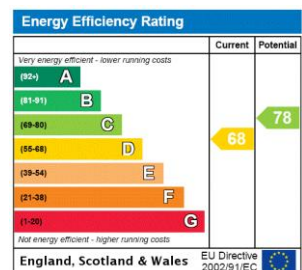

Chestertons Hampstead Sales

55-56 Hampstead High Street

Hampstead

NW3 1QH

hampstead@chestertons.co.uk

020 7794 3311

chestertons.co.uk

Primrose Gardens, NW3

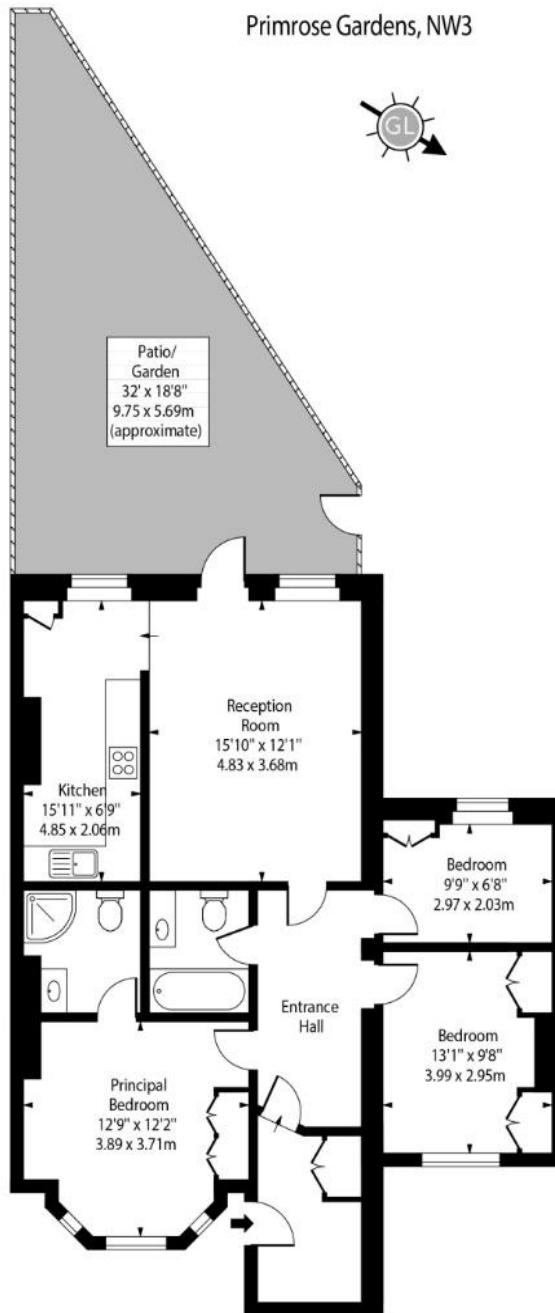

Lower Ground Floor

Approx Gross Internal Area 920 Sq Ft - 85.47 Sq M

For Illustration Purposes Only - Not To Scale
www.goldlens.co.uk
Prepared for Chestertons
Ref. No. 022418E

