



St. Johns Court

Finchley Road, South Hampstead NW3 Asking Price £425,000

A top floor one double bedroom apartment with wood floors, situated on the sixth floor of this very popular and extremely well located purpose built block, served by a lift and a porter.

Additionally the flat will be sold with an extended lease with over 170 years remaining.

St Johns Court has the benefit of a Waitrose on the ground floor and is surrounded by numerous transport links including the Jubilee and Metropolitan Lines literally across the road, and many shops, restaurants and other amenities.



St. Johns Court

Finchley Road, South Hampstead NW3

- One bedroom top floor apartment
- Wood floors
- Modern shower room
- Purpose built block with a lift & porter
- Lease being extended to 173 years approx.
- Located above Waitrose
- Located opposite the Jubilee Line
- Surrounded by shops and amenities



Tenure: Leasehold 172 years remaining.

Service Charge: £2,962 per annum. The service charge includes heating & hot water and a £678 contribution to the reserve fund.

Ground Rent: £0

Local Authority: Camden

Council Tax Band: D

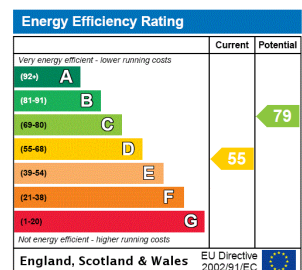

Chestertons Hampstead Sales

55-56 Hampstead High Street
 Hampstead
 NW3 1QH
 hampstead@chestertons.co.uk
 020 7794 3311
 chestertons.co.uk

St John's Court,
Finchley Road, NW3

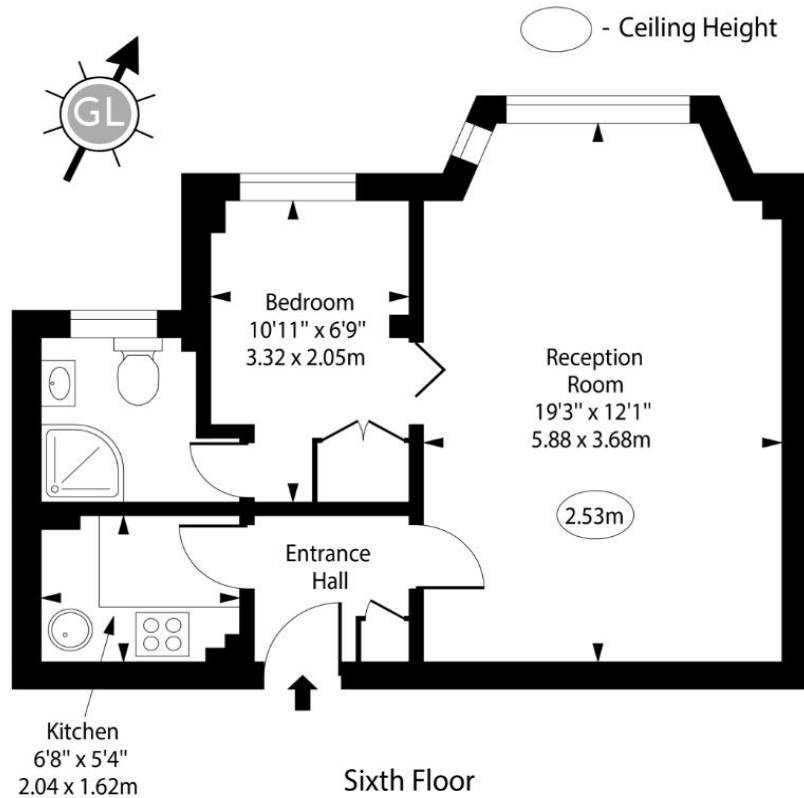

Approx Gross Internal Area 410 Sq Ft - 38.09 Sq M

For Illustration Purposes Only - Not To Scale

www.goldlens.co.uk

Prepared for Chestertons

Ref. No. 023427J

