



Lillium House
Lillie Road, Fulham, SW6

CHESTERTONS





Lillium House is a newly developed collection of five luxury apartments.

The apartments provide large and very bright open plan reception areas with wooden flooring and bespoke kitchens, carpeted bedrooms with built in wardrobes, together with high quality bathrooms.

The House is accessed through a pin entry front door with CCTV security, provides immaculate communal stairs and hallways and two bike stores. Parking entitlement is available.

The development is situated on Lillie Road close to the green space of Normand Park and Virgin Active (gym/pool) and is just a short distance from both West Brompton and West Kensington underground stations.

A large selection of international shops and restaurants can also be found just around the corner of North End Road.

- Luxury second floor apartment (with 10 year build warranty)
- Open plan kitchen and reception
- Two double bedrooms, two bathrooms
- CCTV entry, communal bike store
- Council tax band D

£625,000 Asking Price

Energy Efficiency Rating		Current	Potential
90-100	A		
81-89	B	82	82
69-80	C		
55-68	D		
39-54	E		
21-38	F		
1-20	G		

Not energy efficient - higher running costs

EU Directive 2002/91/EC
England, Scotland & Wales

Tenure: Leasehold
Service Charge: TBC
Ground Rent: TBC

Chestertons Fulham Road Sales

654 Fulham Road
Fulham
London
SW6 5RU

sales.fulhamroad@chestertons.com

020 7384 9898

Lillie Road, SW6

Approximate gross internal area

76.83 sq m / 827 sq ft

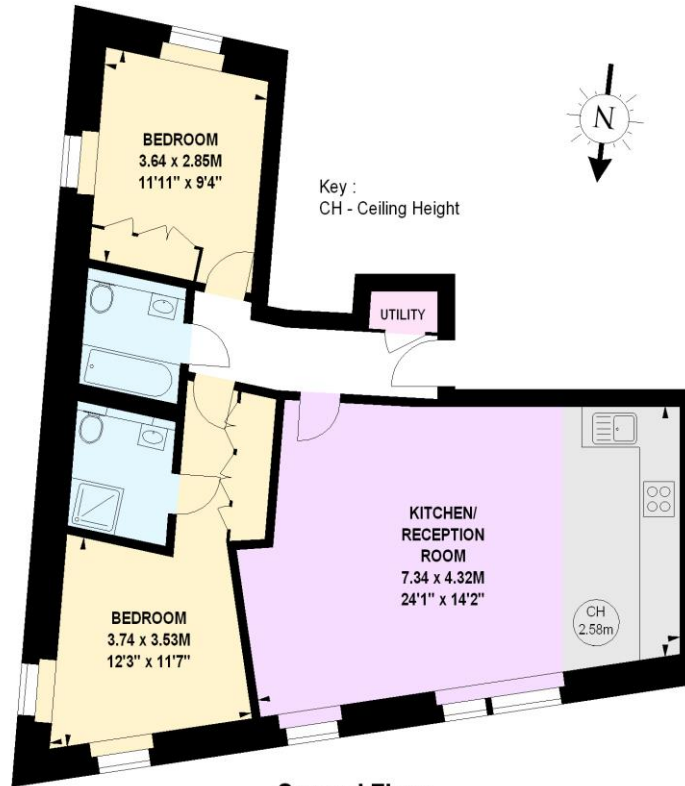

Second Floor

The floor plan is not to scale and measurements and areas shown are approximate and therefore should be used for illustrative purposes only.

The plan has been prepared in accordance with the RICS code of Measuring Practice and whilst we have confidence in the information produced, it must not be relied on.

If there is any aspect of particular importance, you should carry out or commission your own inspection of the property.

Copyright of FeaturePRO.

