



# Farm Lane

Fulham Broadway, SW6

Asking Price £345,000  
Leasehold

A modern studio apartment located just seconds from Fulham Broadway.

**CHESTERTONS**

# Farm Close, SW6

Approximate gross internal area

32.89 sq m / 354 sq ft

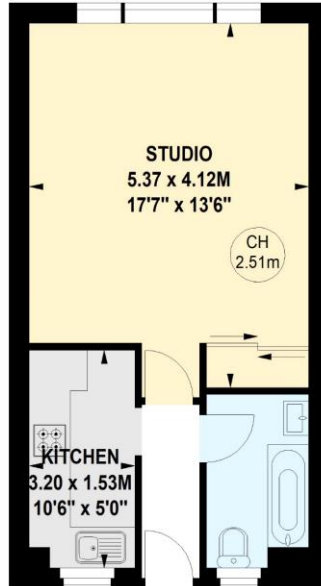

Second Floor

The floor plan is not to scale and measurements and areas shown are approximate and therefore should be used for illustrative purposes only. The plan has been prepared in accordance with the RICS code of Measuring Practice and whilst we have confidence in the information produced, it must not be relied on. If there is any aspect of particular importance, you should carry out or commission your own inspection of the property.

**Tenure:** Leasehold 84 years (approx.)  
**Service Charge:** £1550 pa  
**Ground Rent:** £250 pa  
**Local Authority:** Hammersmith & Fulham  
**Council Tax Band:** B

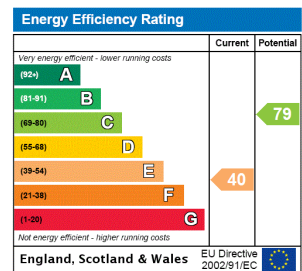

## Chestertons Fulham Road Sales

654 Fulham Road  
 London  
 SW6 5RU  
 fulham@chestertons.co.uk  
 020 7384 9898

Chesterton Global Ltd trading as Chestertons for themselves and for the vendor of this property whose agents they are, give notice that (i) these particulars do not constitute any part of an offer or contract, (ii) all statements contained within these particulars are made without responsibility on the part of Chestertons or the vendor, (iii) whilst made in good faith, none of the statements contained within these particulars are to be relied upon as a statement or representation of fact, (iv) any intending purchasers must satisfy themselves by inspection or otherwise as to the correctness of each of the statements contained within these particulars, (v) the vendor does not make or give either Chestertons or any person in their employment any authority to make or give representation or warranty whatsoever in relation to this property. Wide angle lenses may be used. ©Copyright Chestertons | Chesterton Global Ltd | Registered Office 40 Connaught Street, Hyde Park, London W2 2AB Registered Company Number 05334580.



This paper is 100% recyclable