



Constable House

Cassilis Road, E14

Asking Price £399,000

Newly refurbished one bedroom apartment to rent in Canary Central, E14, a fantastic development just moments from South Quay DLR and less than 10 minutes' walk to Canary Wharf.

CHESTERTONS



Constable House

Cassilis Road, E14

- 1 bedroom | 1 Bathroom
- 492sq ft Internal Living Space
- Close to Canary Wharf & DLR stations
- On-site facilities included for Canary Central residents; gym, swimming pool, jacuzzi, sauna & steam room
- 24-hour concierge service



Discover this newly refurbished one-bedroom apartment set within the sought-after Canary Central development in E14. Ideally located just moments from South Quay DLR and less than a 10-minute walk to Canary Wharf, this home offers the perfect balance of comfort, convenience, and contemporary city living.

The apartment is presented in immaculate condition. It features a lovely designed kitchen and bathroom, a spacious reception area perfected with ambient studio lights, and a generous double bedroom, all finished to a high standard.

Residents of Canary Central benefit from an exceptional range of on-site facilities, including a fully equipped gym, swimming pool, jacuzzi, sauna, and steam room, as well as the reassurance of a 24-hour concierge service.

An outstanding rental opportunity in a prime Docklands location, ideal for professionals seeking style, quality, and excellent transport links.

Tenure: Leasehold 168 years approx. remaining

Service Charge: £2,740 pa approx.

Ground Rent: £150 pa

Local Authority: Tower Hamlets

Council Tax Band: D

Energy Efficiency Rating		
	Current	Potential
Very energy efficient - lower running costs		
(94-100) A		
(81-93) B		
(69-80) C	76	78
(55-68) D		
(39-54) E		
(21-38) F		
(1-20) G		
Not energy efficient - higher running costs		
England, Scotland & Wales EU Directive 2002/91/EC		

Chestertons Canary Wharf & Greenwich Sales

Harbour Island

28 Harbour Exchange Square

London

E14 9GE

canarywharf@chestertons.co.uk

020 7510 8300

chestertons.co.uk

Constable House, Cassilis Road, E14

 - Ceiling Height

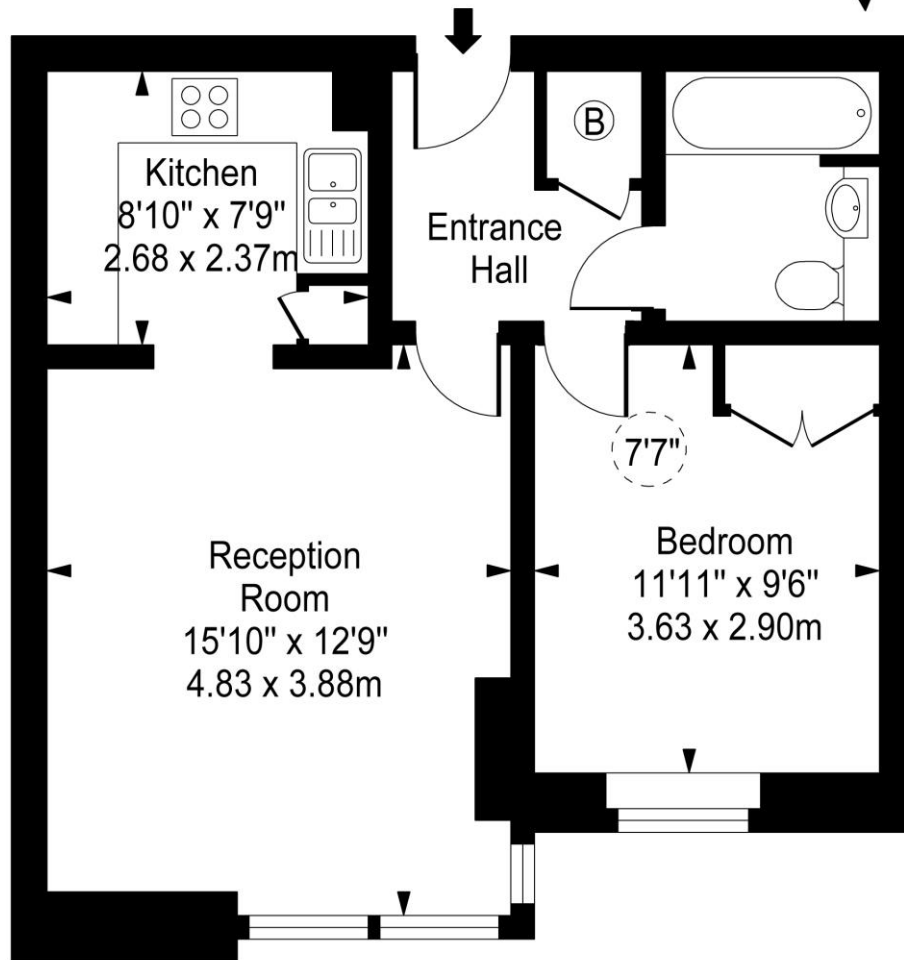
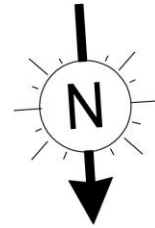

Ground Floor

Approx Gross Internal Area **492 Sq Ft - 45.70 Sq M**

For Illustration Purposes Only - Not To Scale

www.goldlens.co.uk

Ref. No. 015262AG