



# Lamb Court

69 Narrow Street, E14

Asking Price £500,000

A well-presented 947sq ft 3 bedroom, 2 bathroom top floor apartment set in this popular development located in the heart of Limehouse. Features include a large West-facing reception room with balcony, separate kitchen, & secure underground parking. Offered chain-free.



# Lamb Court

69 Narrow Street, E14

- 947sq ft top (4th) floor 3 bedroom 2 bathroom apartment with balcony.
- Low-rise brick-built residential block.
- Situated in the heart of prime Limehouse, on the corner of Narrow Street.
- Close to local amenities & Limehouse station.
- Secure underground parking space.
- Offered chain-free.





A well-presented 947sq ft 3 bedroom, 2 bathroom top floor apartment set in this popular development located in the heart of Limehouse. Features include a large West-facing reception room with balcony, separate kitchen, & secure underground parking.

Lamb Court is situated on the corner of Narrow Street, in the heart of prime Limehouse, close to both Limehouse and Westferry DLR stations allowing easy access to Canary Wharf & the City. There are numerous local amenities nearby, including Ian McKellen's famous riverside pub "The Grapes", & Gordon Ramsay's "Bread Street" restaurant, as well as other restaurants (Italian & Indian), & convenience stores etc.

The property is sold chain-free.

<b>Tenure:</b>	Leasehold – 98 years remaining approx.
<b>Service Charge:</b>	TBC
<b>Ground Rent:</b>	£388pa approx.
<b>Local Authority:</b>	Tower Hamlets
<b>Council Tax Band:</b>	E

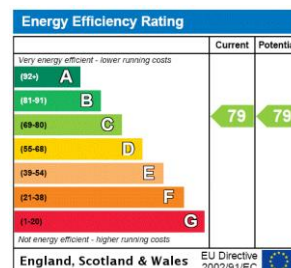

### *Chestertons Canary Wharf & Greenwich Sales*

Harbour Island  
28 Harbour Exchange Square  
London  
E14 9GE  
canarywharf@chestertons.co.uk  
020 7510 8300  
chestertons.co.uk

Lamb Court,  
Narrow Street, E14

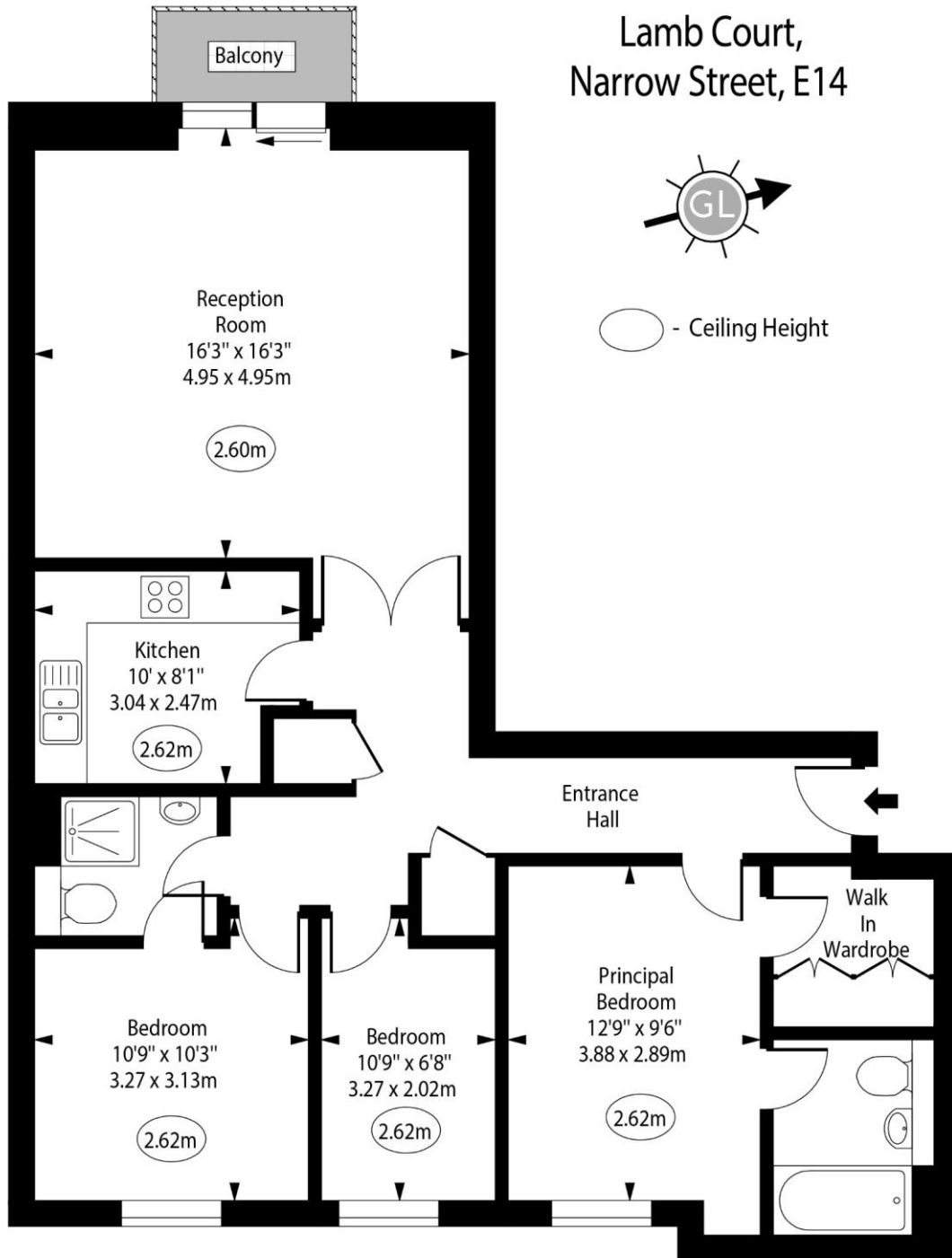

Fourth Floor

Approx Gross Internal Area 947 Sq Ft - 87.97 Sq M

For Illustration Purposes Only - Not To Scale

[www.goldlens.co.uk](http://www.goldlens.co.uk)

Ref. No. 022206R

