



Hampton Tower

75 Marsh Wall, E14

Asking Price £700,000

A beautiful one bedroom apartment set on the 42nd floor of Hampton Tower in South Quay Plaza that offers spectacular views over South Dock and the new Wood Wharf skyline.

CHESTERTONS



Hampton Tower

75 Marsh Wall, E14

- One Bedroom | One Bathroom
- 42nd Floor
- 635sq ft Internal Living Space
- Exceptional Views
- Superb Canary Wharf Location
- Membership of 'The Quay Lifestyle Residents Club'
- Twenty Four Hour Concierge
- Private Dining Rooms & Business Lounge



Situated on the 42nd floor of the hugely sought-after 68 storey high South Quay Plaza, this dual aspect apartment offers spectacular views over South Dock and east towards London's famous O2 in Greenwich. Benefitting from an impressive 635sq ft the apartment comprises of a generous one bedroom, a sumptuous family bathroom suite and sublime open-plan living-kitchen area that is well-lit and offers amazing views across the Isle of Dogs and the Canary Wharf estate.

Developed by Berkeley and designed by Foster + Partners, South Quay Plaza is one of the tallest residential buildings in Europe. Combining the highest quality of architecture, interior design and amenities, it also promotes sustainable high-rise living, which means creating not just a new landmark for London, but a vibrant, long-term community.

Superbly located at a pivotal intersection of the capital's historic docks in Canary Wharf, South Quay Plaza will create a vibrant, safe, mixed-use and sustainable waterside development of the highest design quality. It will set the benchmark for future similar developments across the UK. South Quay Plaza's slender 68-storey glass and steel tower will bring a new focal point to the London skyline and provide a new reason to live in Canary Wharf, the city's prestigious, modern financial district.

Tenure: Leasehold 989 years approx. remaining.

Service Charge: £5,667 pa.

Ground Rent: £500 pa. Increasing every 10 years in line with RPI

Local Authority: Tower Hamlets

Council Tax Band: Band E

Chestertons Canary Wharf & Greenwich Sales

Harbour Island

28 Harbour Exchange Square

London

E14 9GE

canarywharf@chestertons.co.uk

020 7510 8300

[chestertons.co.uk](https://www.chestertons.co.uk)

Hampton Tower, Marsh Wall, E14

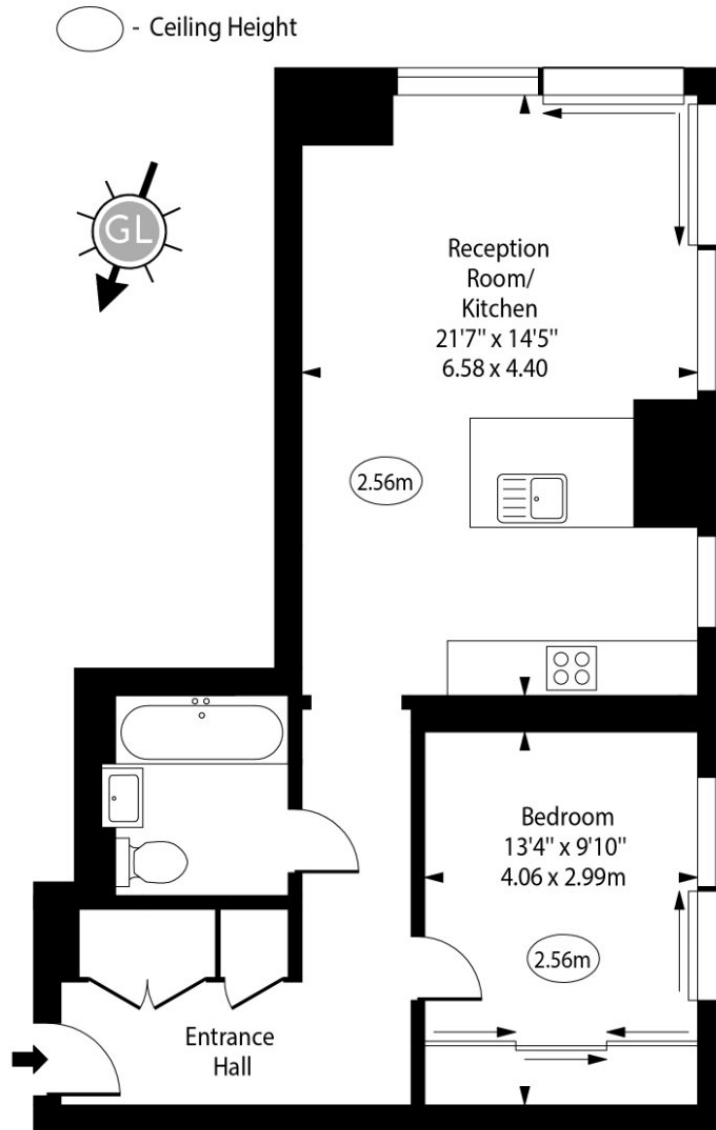

Forty Second Floor

Approx Gross Internal Area 635 Sq Ft - 58.99 Sq M

Every attempt has been made to ensure the accuracy of the floor plan shown.
However, all measurements, fixtures, fittings, and data shown are approximate interpretations and
for illustrative purposes only.

Measured according to the RICS IPMS 2. Not To Scale.

www.goldlens.co.uk

Ref. No. 027926J

